

BRUCE MATHER

INDEPENDENT ESTATE AGENT



17 Witham Street, Boston, PE21 6PU

£99,000

A two-bedroom terraced townhouse, recently converted in the Centre of Boston. An ideal rental investment or first-time purchase, this house is positioned in a handy location close to amenities, shops and restaurants. Upstairs there are two bedrooms, downstairs the open plan living, dining, and kitchen area flows well and provides some decent living space leading out to a small patio out the back. Please call Bruce Mather Estate Agents on 01205365032 to arrange a viewing please.

Floor Plan

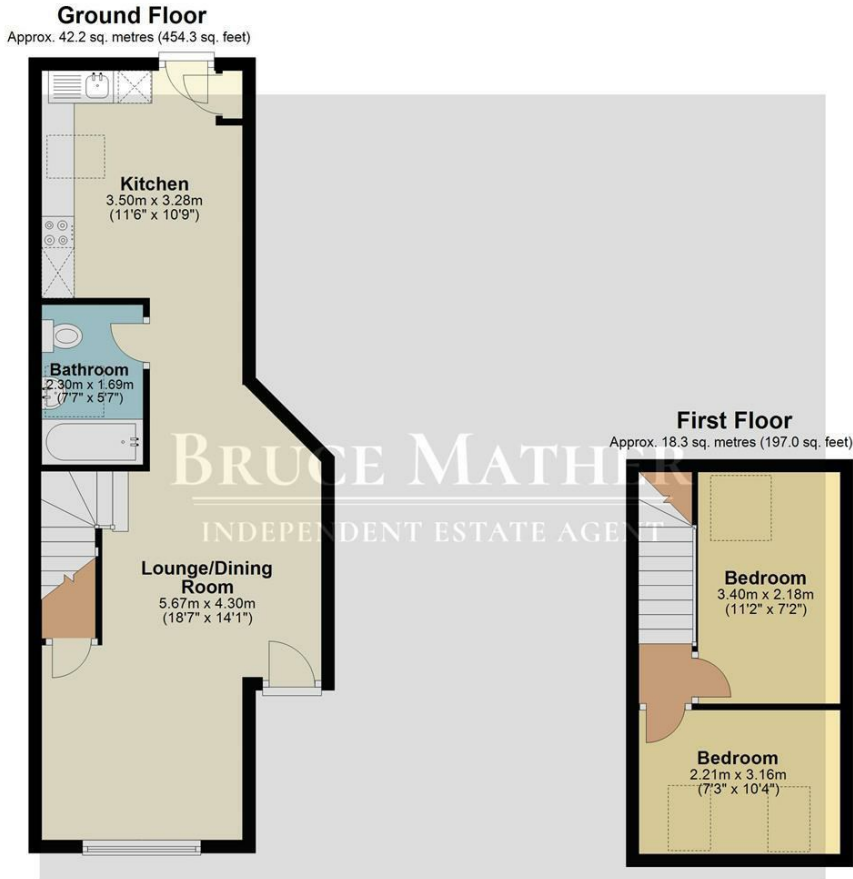

Total area: approx. 60.5 sq. metres (651.2 sq. feet)

All images used are for illustrative purposes. Images are for guidance only and may not necessarily represent a true and accurate depiction of the condition of property. Floor plans are intended to give an indication of the layout only. All images, floor plans and dimensions are not intended to form part any contract. Plan produced using PlanUp.



Area Map

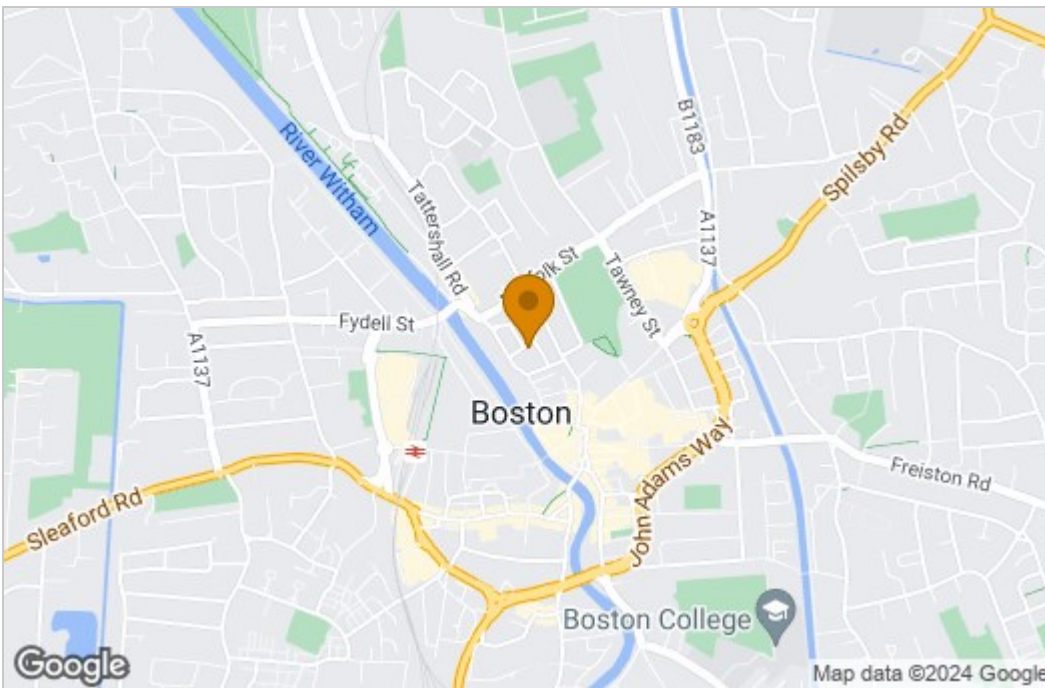

Energy Efficiency Graph

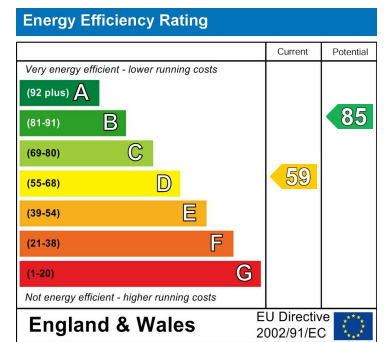

These particulars, whilst believed to be accurate are set out as a general outline only for guidance and do not constitute any part of an offer or contract. Intending purchasers should not rely on them as statements of representation of fact, but must satisfy themselves by inspection or otherwise as to their accuracy. No person in this firm's employment has the authority to make or give any representation or warranty in respect of the property.