

GILMORE ESTATES

Property Sales & Lettings



Cross Street , Prudhoe, NE42 5FL

*** THREE BEDROOMS *** DETACHED HOUSE *** GAS CENTRAL HEATING *** DOUBLE GLAZED WINDOWS ***
EN-SUITE TO MASTER BEDROOM *** UTILITY ROOM *** FRONT AND REAR GARDENS *** SINGLE GARAGE ***
*** DRIVEWAY PARKING *** MODERN DECOR THROUGHOUT ***

A well presented three bedroom detached house situated on the popular Castlefields Estate in Prudhoe. The property has a bright and modern decor throughout and briefly comprises :- Entrance hall, cloakroom/w.c, lounge, dining room, kitchen, utility, to the first floor there three bedrooms (master with en-suite) and bathroom. Externally there are gardens to the front and rear and a driveway leading to the garage.

EPC RATING C

COUNCIL TAX BAND D

£240,000

Cross Street

, Prudhoe, NE42 5FL



- DETACHED HOUSE
- THREE BEDROOMS
- GARDENS FRONT AND REAR
- TWO RECEPTION ROOMS
- BATHROOM AND ENSUITE
- POPULAR RESIDENTIAL ESTATE
- KITCHEN AND UTILITY ROOM
- GARAGE

Entrance Hallway

3'10" x 7'3" (1.17 x 2.22)

Cloaks WC

3'6" x 5'0" (1.07 x 1.54)

Lounge

10'7" x 13'3" (3.24 x 4.05)

Dining Room

10'7" x 13'3" (3.25 x 4.05)

Kitchen

9'0" x 8'3" (2.76 x 2.52)

Utility Room

5'3" x 5'7" (1.62 x 1.72)

First Floor Landing

3'2" x 7'6" (0.99 x 2.31)

Bedroom One

8'7" x 12'2" (2.63 x 3.72)

Ensuite

5'6" x 8'7" (1.70 x 2.64)

Bedroom Two

12'7" x 13'1" (3.84 x 3.99)

Bedroom Three

10'5" x 6'2" (3.20 x 1.90)

Bathroom

7'1" x 5'6" (2.18 x 1.70)

Externally



Directions



Floor Plan

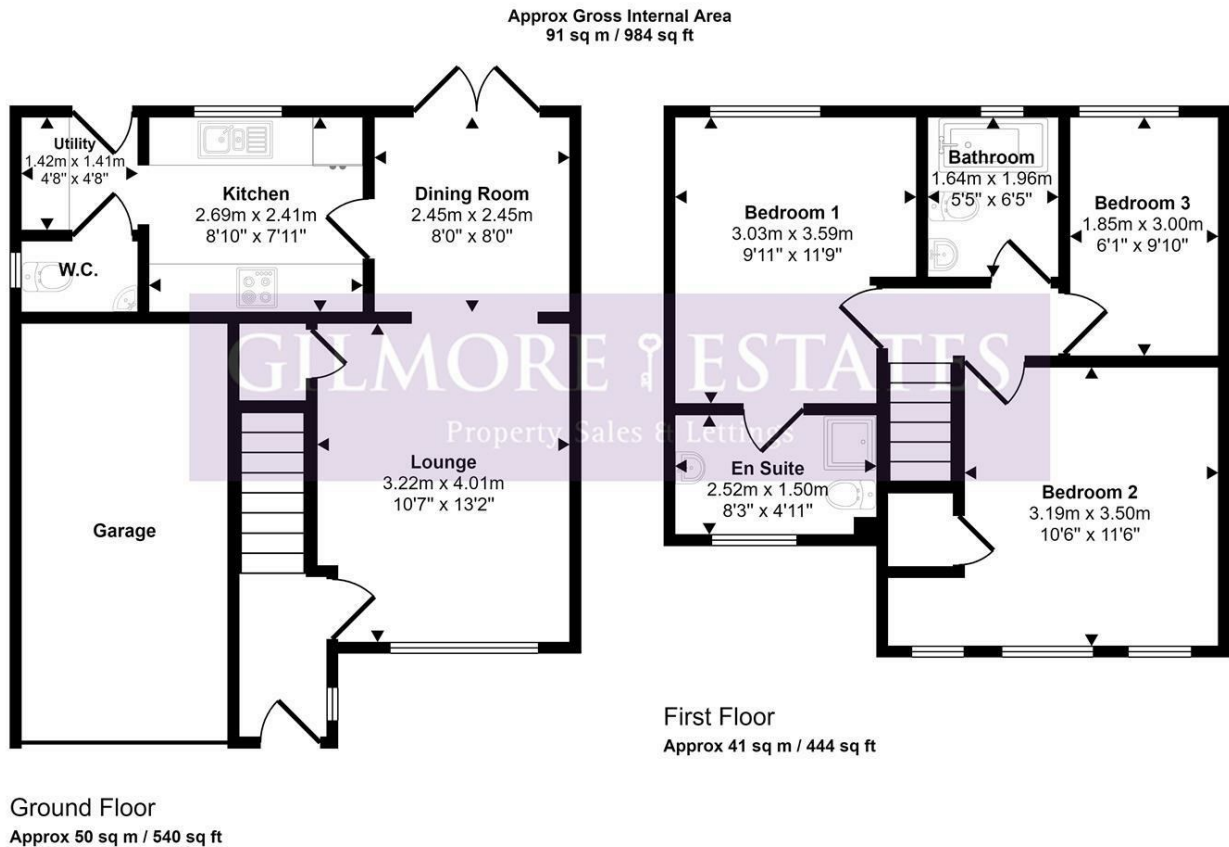

This floorplan is only for illustrative purposes and is not to scale. Measurements of rooms, doors, windows, and any items are approximate and no responsibility is taken for any error, omission or mis-statement. Icons of items such as bathroom suites are representations only and may not look like the real items. Made with Made Snappy 360.

These particulars, whilst believed to be accurate are set out as a general outline only for guidance and do not constitute any part of an offer or contract. Intending purchasers should not rely on them as statements of representation of fact, but must satisfy themselves by inspection or otherwise as to their accuracy. No person in this firm's employment has the authority to make or give any representation or warranty in respect of the property.

