



Alexander House

Southend on Sea

Victoria Avenue, Southend on Sea, Essex

**First floor available by way of suites or the whole,
ranging from 3,800 sq. ft. to 12,800 sq. ft.**



Contact

Peter Alabaster 01702 608819
peter@sorrellproperty.co.uk



Contact

Roy Horton 01702 311111
royhorton@dedmangray.co.uk

Location

Alexander House is located at the southern end of Victoria Avenue and Queensway junction; it is conveniently located for all types of public transport, excellent access to Southend Victoria Railway station and local bus routes, providing direct access to both A13 and A127 arterial road. Easy access to Southend High Street.

Description

We are offering accommodation on the first floor, available as a whole or in options of varying sized suites to suit individual requirements. The suites will predominately be open plan. To the ground floor is a reception area with stairs and lifts to the first floor.

Features

- Landmark building • On site parking
- Close to public transport
- Easy access to Southend High Street
- 8 x 12 person passenger lifts
- Male, female and disabled WCs
- DDA compliant • Flexible terms

Accommodation

Complete floor: 12,800 sq. ft.

Indicative range of suites that can be offered:

Suite 1: 5,000 sq. ft.
Suite 2: 3,800 sq. ft.
Suite 3: 4,000 sq. ft.

The suites are available by way of new sub-leases – terms to be negotiated.

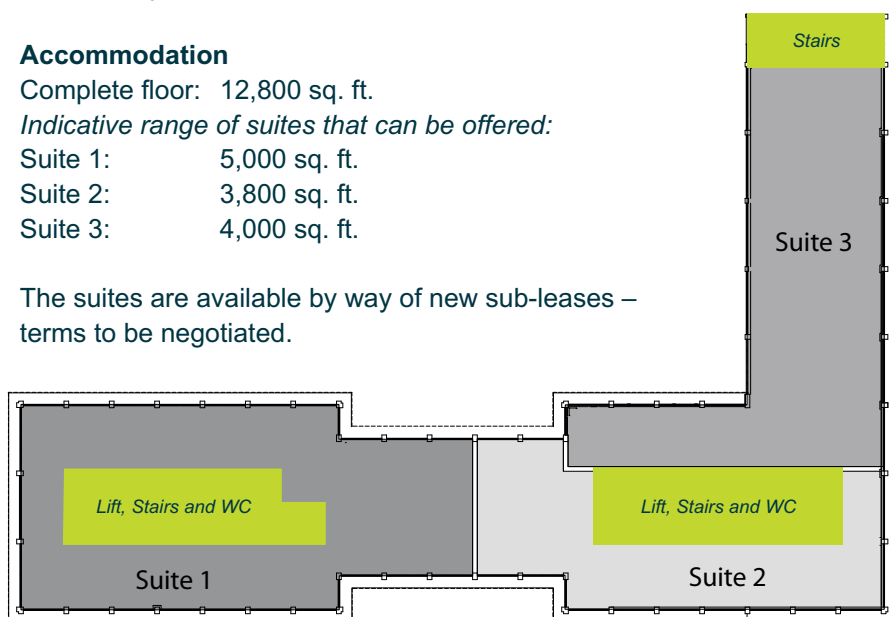

Rent

Upon application

Service Charge

We are advised that there is a service charge applicable for the repair, maintenance and provision of common parts and services to the premises, further details on request.

Business Rates

Interested parties are advised to contact Southend on Sea Borough Council on 01702 215000 for further information.

Legal costs

Each party to bear their own legal costs incurred in the transaction

VAT

All rents are exclusive of VAT under the Finance Act 1989.

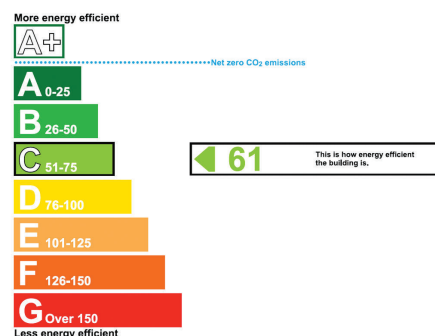

Viewing & Further information:



Contact

Peter Alabaster 01702 608819
peter@sorrellproperty.co.uk



Contact

Roy Horton 01702 311111
royhorton@dedmangray.co.uk

MISREPRESENTATION ACT 1967

Sorrell for themselves and for the vendors of lessees of this property whose agents they are given notice that: (1) the particulars are produced in good faith, are set out as a general guide only and do not constitute any offer or contract; (2) no person in the employment of Sorrell has any authority to make or give representation or warranty whatever in relation to this property; (3) All prices and rents are quoted exclusive of VAT unless otherwise stated; (4) Any services mentioned have not been tested and therefore prospective occupiers should satisfy themselves as to their operation