



£1,200 Per Month

22 WATERFIELD AVENUE | WARSOP | MANSFIELD | NG20 0FH

BuckleyBrown
ESTATE AGENTS

WATERFIELD WELCOMES YOU!... This impressive three-storey four bedroomed semi-detached family home offers modern day living at it's best! Occupying a favourable position in a convenient area, we are sure that this will be a firm favourite and is really one of those properties that you need to view for yourself and we are sure you'll love it just as much as what we do!

As you walk through you will first of all find the welcome entrance hallway which leads nicely into the downstairs WC and the stylish kitchen/diner which comes complete with a range of modern units and offers plenty of space for a table and chairs, perfect for when you have family and friends over! Moving on from here you will find a lovely lounge which is of a great size and has been beautifully decorated in a neutral colour palette and has been complemented well with modern fixtures and fittings. This room has a really inviting feel to it with a window to the rear allowing for ample natural light and double doors leading out onto the garden for added convenience.

Lets head further upstairs onto the first floor where you will find three wonderful bedrooms and a modern bathroom fitted with a suite in white. The second floor hosts a fantastic master bedroom which has the added luxury of it's own en-suite! The outside space also includes off-street parking with a driveway which in turn gives access to the single garage. To the rear you will find a low maintenance garden which is fully paved! The garage has electricity, and the property also has a EV char charger! Call now to arrange a viewing!







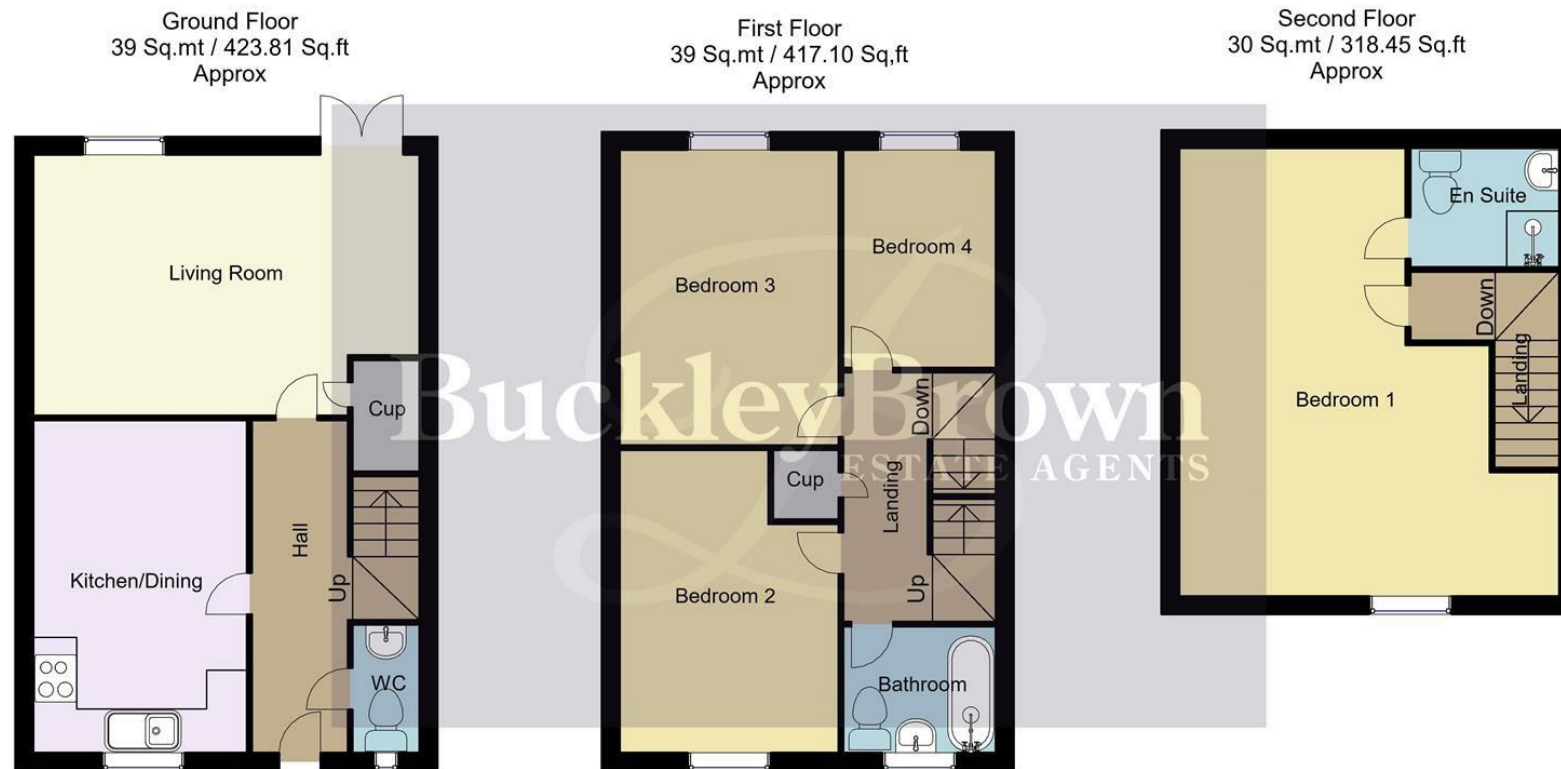

Whilst every attempt has been made to ensure the accuracy of the floor plan contained here, no responsibility is taken for incorrect measurements of doors, windows, appliances and room or any error, omission or misstatement. Exterior and interior walls are drawn to scale based on interior measurements. Any figure given is for initial guidance only and should not be relied on as basis of valuation. These plans are for marketing purposes only and should be used as such by any prospective purchase. Specially no guarantee is should not be relied on as a basis of valuation. These plans are for marketing purposes only and should be used as such by any prospective purchase. Specifically no guarantee is given on the total square footage of the property if quoted on this plan.

CC Ltd ©2018

IMPORTANT: we would like to inform prospective purchasers that these sales particulars have been prepared as a general guide only. A detailed survey has not been carried out, nor the services, appliances and fittings tested. Room sizes should not be relied upon for furnishing purposes and are approximate. If floor plans are included, they are for guidance only and illustration purposes only and may not be to scale. If there are any important matters likely to affect your decision to buy, please contact us before viewing the property.

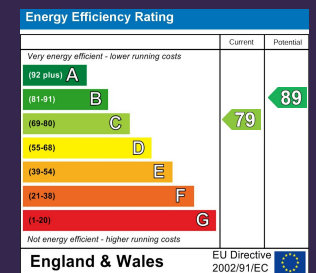

22 WATERFIELD AVENUE
WARSOP
MANSFIELD
NG20 0FH



BuckleyBrown Estate Agents

55 - 57 Leeming Street | Mansfield | Nottinghamshire | NG18 1ND

23 High Street | Edwinstowe | Nottinghamshire | NG21 9QP

1 Market Place | Bolsover | Chesterfield | S44 6PN

www.buckleybrown.co.uk

t: 01623 633 633

t: 01623 633 633

t: 01246 605121

IMPORTANT: we would like to inform prospective purchasers that these sales particulars have been prepared as a general guide only. A detailed survey has not been carried out, nor the services, appliances and fittings tested. Room sizes should not be relied upon for furnishing purposes and are approximate. If floor plans are included, they are for guidance only and illustration purposes only and may not be to scale. If there are any important matters likely to affect your decision to buy, please contact us before viewing the property.

BuckleyBrown
ESTATE AGENTS