



Offers Over £215,000

LONG LANE | SHIREBROOK | MANSFIELD | NG20 8AZ

BuckleyBrown
ESTATE AGENTS

YOU'RE GOING TO LOVE THIS!...We have found the one for you with this beautiful two-bedroom home! Standing proud with a spacious frontage and attractive exterior. This detached bungalow benefits from excellent shops and amenities on your doorstep! Comprising a marvellous interior with modern decor and quality fixtures and fittings. Outside is equally fantastic, with its driveway to the front providing useful off-street parking. There is an enclosed garden to the rear with a patio seating area, maintained lawn, and a fence surrounding it, providing additional privacy. This one won't be around for long! Call our team today!

Living Room 9'10" x 12'3"

With decorative panelling, parquet style flooring and sliding doors leading outside.

Kitchen 8'7" x 14'9"

Complete with shaker style cabinets and units, work surface, splash back, extractor fan, integrated oven, ceramic sink with mixer tap above, tiled flooring, window to the side elevation and door providing easy access to the rear garden.

Bedroom One 11'9" x 11'11"

With carpet to flooring, central heating radiator and bay window to the front elevation.

Bedroom Two 9'4" x 12'2"

With carpet to flooring, central heating

radiator and window to the front elevation.

Bathroom 5'10" x 7'2"

Complete with a low flush WC, wash hand basin, panelled bath with overhead shower, vanity storage, extractor fan and an opaque window to the side elevation.

Outside

With a driveway to the front providing off-street parking. There is an enclosed garden to the rear with a patio seating area, maintained lawn and fence surround.

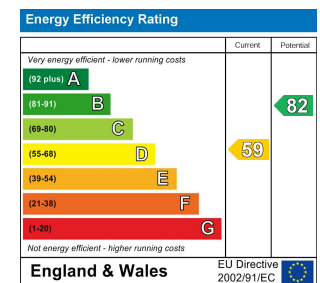
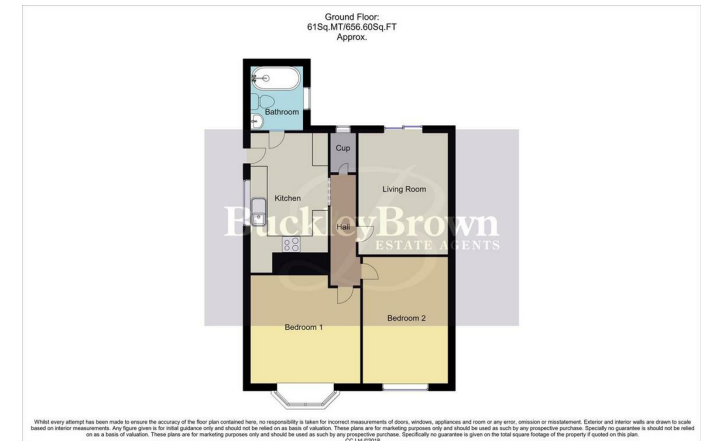

BuckleyBrown Estate Agents

55- 57 Leeming Street | Mansfield | Nottinghamshire | NG18 1ND

t: 01623 633633 | mansfield@buckleybrown.co.uk | www.buckleybrown.co.uk

IMPORTANT: we would like to inform prospective purchasers that these sales particulars have been prepared as a general guide only. A detailed survey has not been carried out, nor the services, appliances and fittings tested. Room sizes should not be relied upon for furnishing purposes and are approximate. If floor plans are included, they are for guidance only and illustration purposes only and may not be to scale. If there are any important matters likely to affect your decision to buy, please contact us before viewing the property.

