



STOCKWELL COURT | MANSFIELD | NG18 5QQ

BuckleyBrown
ESTATE AGENTS

MAKE A MOVE!...This ground floor, one bedroom flat presents a wonderful opportunity for any first time buyers, or business professionals looking for a delightful living space to call their own. Situated in Mansfield with transport links and a range of amenities right on your doorstep, making everyday living a breeze! Additionally, this property presents a designated parking space to the side for added convenience.

Don't miss the chance to make this charming flat your new home!

Living Room 10'8" x 15'4"

With laminate flooring, two central heating radiators and window.

Kitchen 8'7" x 5'9"

Fitted with cabinets and units, work surface, gas hob, inset sink with a mixer tap above, space for a cooker and window flowing in ample natural light.

Bedroom 10'6" x 16'2"

With carpet to flooring, central heating radiator, storage cupboard and window.

Bathroom 6'0" x 5'9"

Fitted with a low flush WC, panelled bath, pedestal sink, tiling, central heating radiator and opaque window.

Outside

With carpark providing off-street parking for one vehicle.

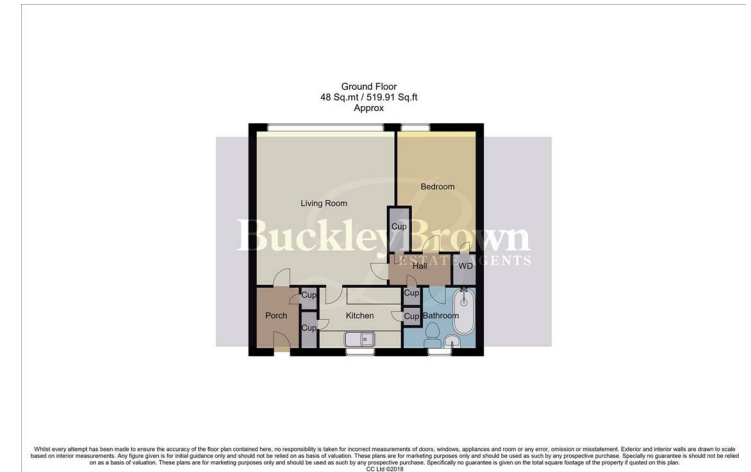

| Energy Efficiency Rating | | |
|---|-------------------------|-----------|
| | Current | Potential |
| Vary energy efficient - lower running costs | | |
| (92 plus) A | | |
| (81-91) B | | |
| (69-80) C | 70 | 76 |
| (55-68) D | | |
| (39-54) E | | |
| (21-38) F | | |
| (1-20) G | | |
| Not energy efficient - higher running costs | | |
| England & Wales | EU Directive 2002/91/EC | |

BuckleyBrown Estate Agents

55- 57 Leeming Street | Mansfield | Nottinghamshire | NG18 1ND

t: 01623 633633 | mansfield@buckleybrown.co.uk | www.buckleybrown.co.uk

IMPORTANT: we would like to inform prospective purchasers that these sales particulars have been prepared as a general guide only. A detailed survey has not been carried out, nor the services, appliances and fittings tested. Room sizes should not be relied upon for furnishing purposes and are approximate. If floor plans are included, they are for guidance only and illustration purposes only and may not be to scale. If there are any important matters likely to affect your decision to buy, please contact us before viewing the property.

