

FIRST FLOOR PLAN

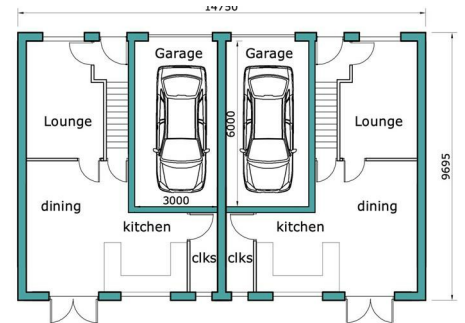

GROUND FLOOR PLAN

£110,000 Freehold

LAND ADJACENT 33 GROVE STREET | MANSFIELD WOODHOUSE | MANSFIELD | NG19 8BU



B

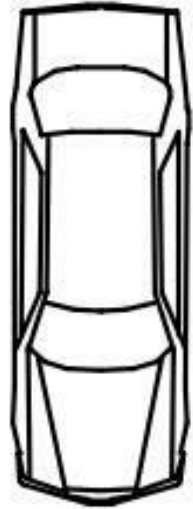

KEY LOCATION.. This is your chance to build on this individual level building plot which is ideally located within the urban area of Mansfield Woodhouse, footsteps away from the high street. The plot has full Planning Permission for two, three-bedroom semi-detached homes with integral garages.

Once built, these dwellings will comprise of a highly desirable open plan kitchen diner to the rear and a snug lounge area to the front. To the first floor, there will be three double bedrooms, ensuite and a family bathroom. The properties lend themselves perfectly for families, making this the perfect build for any developer.

Further information can be found under the reference of; 2019/0528/FUL granted through Mansfield District Council.

Call now and speak with one of our team today!

BuckleyBrown Estate Agents

55- 57 Leeming Street | Mansfield | Nottinghamshire | NG18 1ND

t: 01623 633633 | mansfield@buckleybrown.co.uk | www.buckleybrown.co.uk

IMPORTANT: we would like to inform prospective purchasers that these sales particulars have been prepared as a general guide only. A detailed survey has not been carried out, nor the services, appliances and fittings tested. Room sizes should not be relied upon for furnishing purposes and are approximate. If floor plans are included, they are for guidance only and illustration purposes only and may not be to scale. If there are any important matters likely to affect your decision to buy, please contact us before viewing the property.

BuckleyBrown
ESTATE AGENTS