



£180,000-£185,000

GUIDE PRICE

COUNTY ROAD
GEDLING

- THREE BEDROOMS
- MODERN KITCHEN
- CUL DE SAC POSITION
- DRIVEWAY
- POPULAR LOCATION
- EPC D

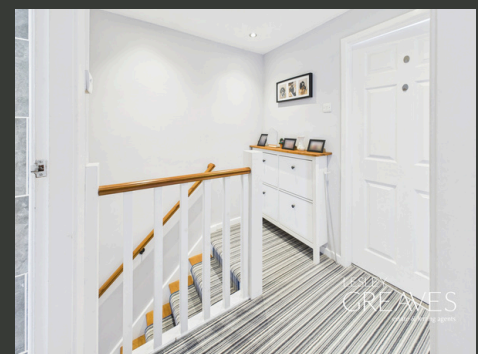

Well Presented Mid-Terrace Home in a Prime Location

THIS WELL PRESENTED MID-TERRACE HOME IS IDEALLY LOCATED FOR CONVENIENT ACCESS TO THE EXCELLENT AMENITIES, SCHOOLS AND REGULAR BUS SERVICES OF BOTH GEDLING AND MAPPERLEY, AS WELL AS EASY TRAVEL INTO NOTTINGHAM CITY CENTRE.

UPON ENTERING, YOU'RE WELCOMED BY A PRACTICAL ENTRANCE PORCH THAT OPENS INTO A HALLWAY WITH STAIRS LEADING TO THE FIRST FLOOR. FROM HERE, YOU STEP INTO A SPACIOUS KITCHEN FITTED WITH A RANGE OF UNITS, INTEGRATED OVEN, HOB, EXTRACTOR AND AMPLE SPACE FOR FREESTANDING APPLIANCES.

THE KITCHEN FLOWS THROUGH TO A LIGHT-FILLED LIVING ROOM, WHERE PATIO DOORS OPEN ONTO A PATIO AREA AND THE REAR GARDEN PERFECT FOR RELAXING OR ENTERTAINING.

UPSTAIRS THIS PROPERTY OFFERS THREE WELL-PROPORTIONED BEDROOMS, ALL SERVED BY A MODERN BATHROOM FEATURING A WHITE THREE-PIECE SUITE WITH AN OVER-BATH SHOWER.

OUTSIDE IS A LOW-MAINTENANCE REAR GARDEN WITH SPACE FOR OUTDOOR SEATING. TO THE FRONT, THE PROPERTY BENEFITS FROM OFF-STREET PARKING ON A PRIVATE DRIVEWAY.

- FREEHOLD
- COUNCIL TAX; BAND A
- LOCAL AUTHORITY; GEDLING BOROUGH COUNCIL
- MEASUREMENTS; 73 SQ METERS

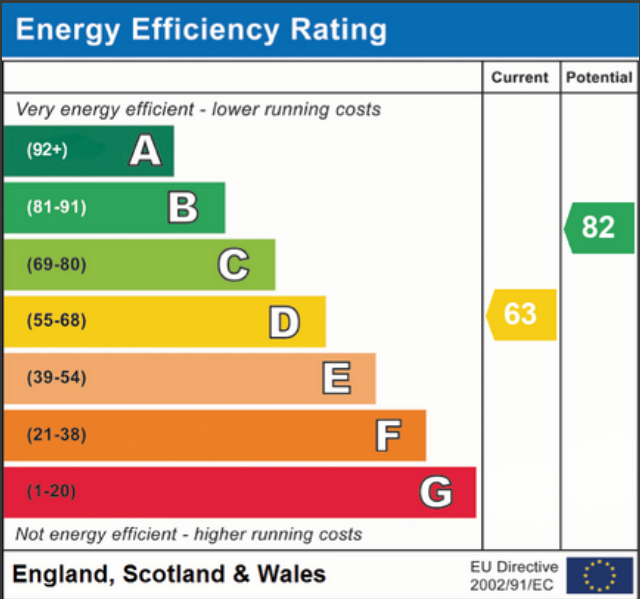



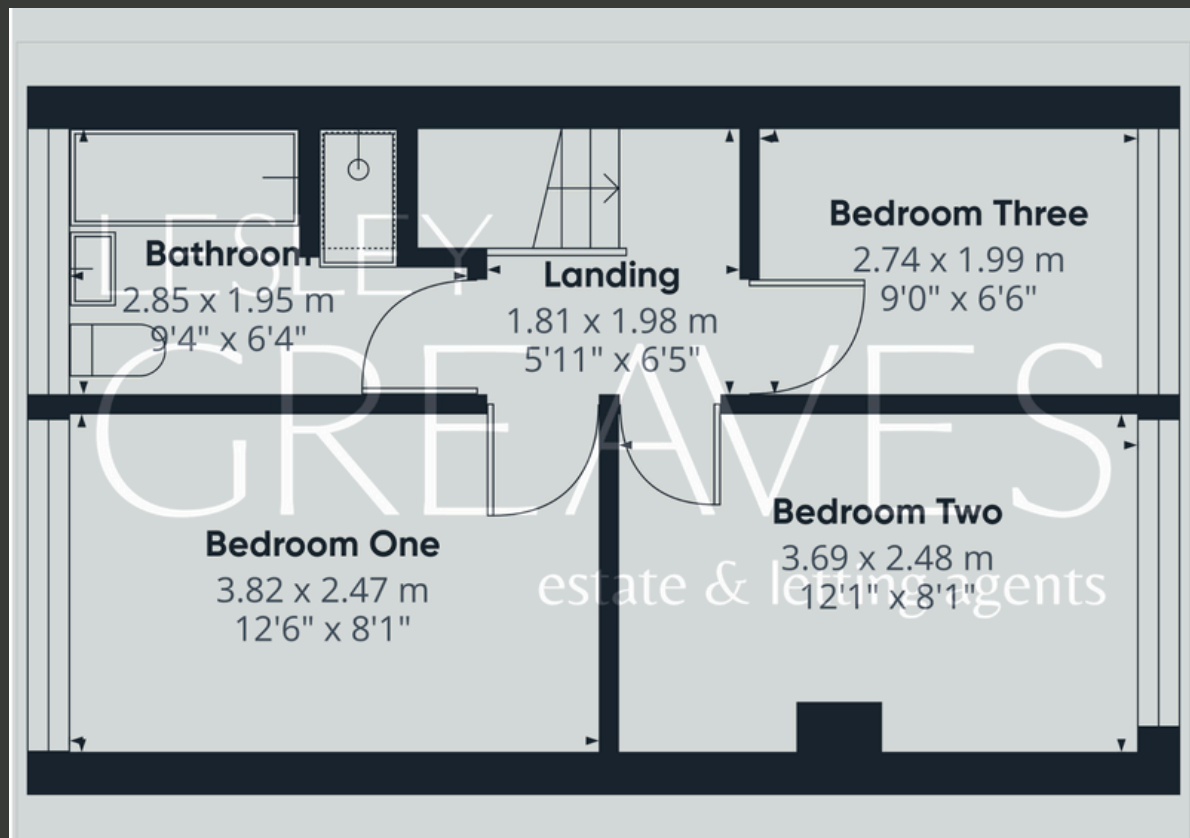
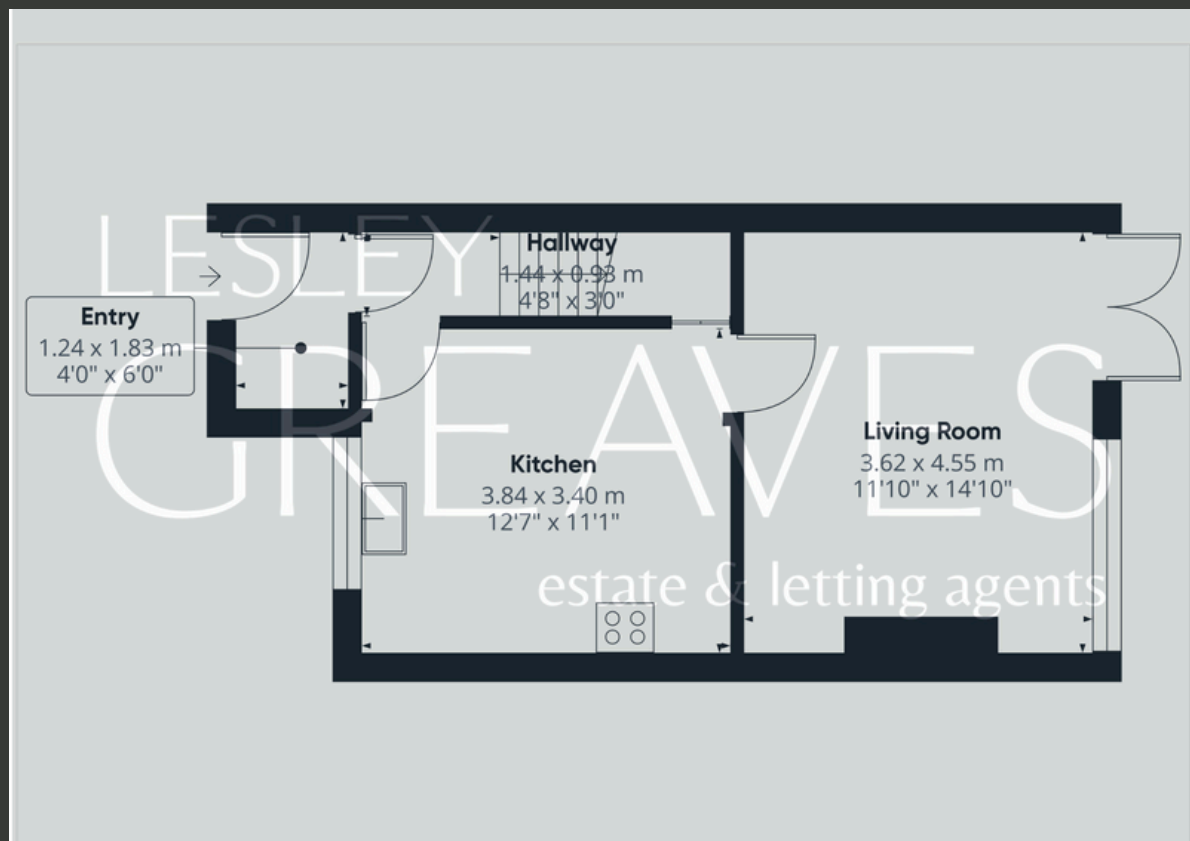

Lesley Greaves Estate & Lettings Agents

22 Main Road ,Gedling, Nottingham, NG4 3HG

0115 987 7337

sales@lesleygreaves.co.uk