



£425,000

OFFERS IN THE REGION OF
GREGORY AVENUE
MAPPERLEY

- DETACHED
- SUN ROOM
- VERSATILE GARDEN ROOM
- EN-SUITE SHOWER ROOM
- GOOD SIZED KITCHEN
- DOWNSTAIRS WC
- EPC E



Stylish Three-Bed Detached Home with Sunroom & Garden Room!

NESTLED IN A PEACEFUL RESIDENTIAL AREA, THIS BEAUTIFULLY PRESENTED 3-BEDROOM DETACHED HOUSE OFFERS THE PERFECT BLEND OF COMFORT, STYLE, AND PRACTICALITY. THE BRIGHT AND SPACIOUS MAIN BEDROOM IS TASTEFULLY DECORATED IN CALMING TONES, FEATURING LARGE WINDOWS THAT FILL THE SPACE WITH NATURAL LIGHT, ALONG WITH A MODERN EN SUITE SHOWER ROOM FOR ADDED CONVENIENCE.

TWO ADDITIONAL GENEROUSLY SIZED BEDROOMS PROVIDE PLENTY OF SPACE FOR FAMILY, GUESTS, OR HOME OFFICE USE. THE LANDING IS A STANDOUT FEATURE WITH A SLEEK GLASS BANISTER, ADDING A TOUCH OF CONTEMPORARY ELEGANCE.

A FRESH AND MODERN FAMILY BATHROOM BOASTS STYLISH FIXTURES, WHILE THE DOWNSTAIRS WC ADDS EVERYDAY PRACTICALITY. THE KITCHEN IS WELL-EQUIPPED WITH AMPLE CUPBOARD AND WORKTOP SPACE, MAKING IT IDEAL FOR HOME COOKING AND ENTERTAINING. THE KITCHEN ALSO BENEFITS FROM A SEPARATE UTILITY AREA FOR ADDED CONVENIENCE AND FUNCTIONALITY.

A SPACIOUS AND WELCOMING LIVING ROOM OFFERS THE IDEAL SETTING FOR FAMILY TIME OR COSY EVENINGS IN.

AT THE HEART OF THE HOME LIES A STUNNING SUNROOM DINING AREA. A STRIKING SKYLIGHT AND LARGE FRENCH DOORS FLOOD THE SPACE WITH NATURAL LIGHT AND OPEN OUT TO THE BEAUTIFULLY MAINTAINED GARDEN-PERFECT FOR RELAXING OR HOSTING.

A VERSATILE GARDEN ROOM ADDS FURTHER APPEAL, IDEAL FOR HOBBIES, REMOTE WORKING, OR QUIET RETREAT. THIS IMPRESSIVE HOME OFFERS STYLISH LIVING IN A TRANQUIL SETTING, PERFECT FOR FAMILIES OR PROFESSIONALS SEEKING COMFORT AND SPACE.

- FREEHOLD COUNCIL
- TAX; BAND D
- LOCAL AUTHORITY; GEDLING BOROUGH COUNCIL
- MEASUREMENTS; 120 SQ METERS

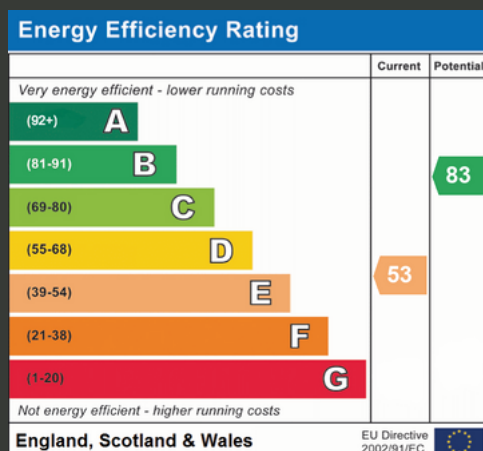



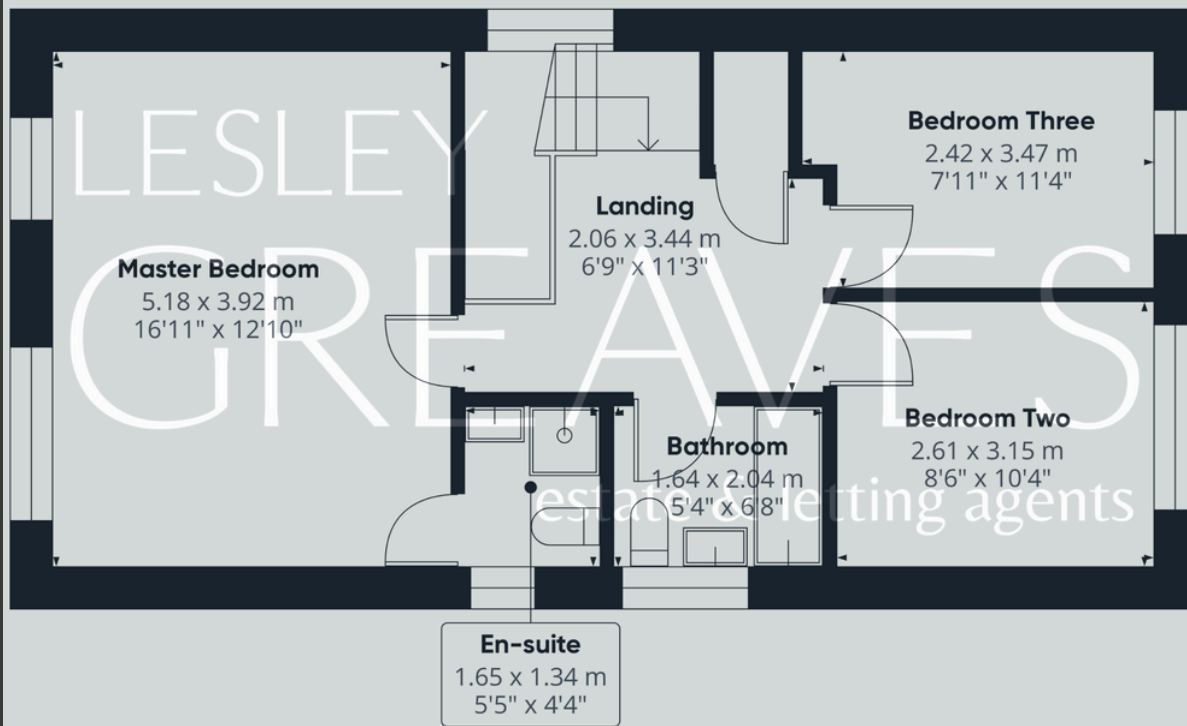
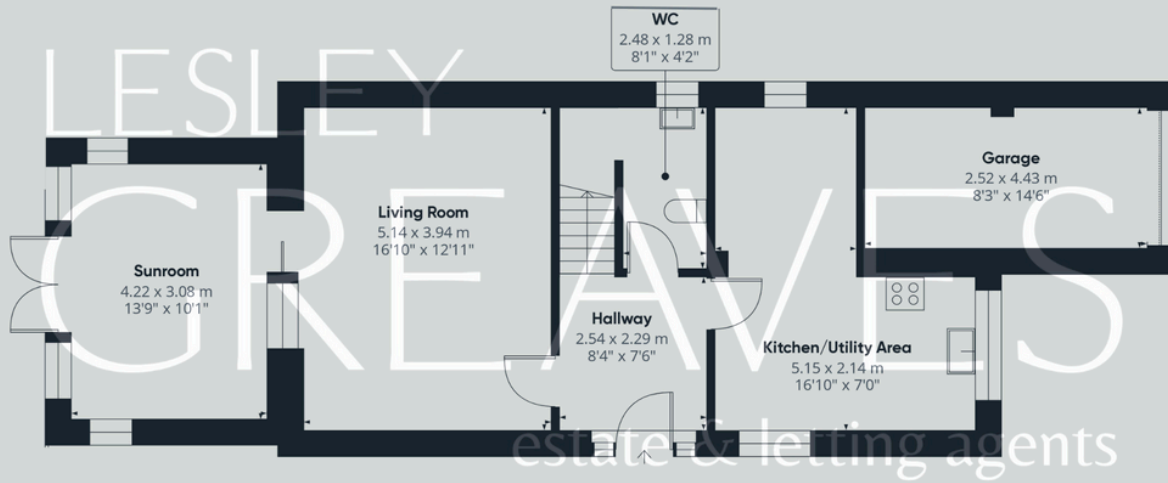

Lesley Greaves Estate & Lettings Agents

20 Main Road ,Gedling, Nottingham, NG4 3HG

0115 987 7337

sales@lesleygreaves.co.uk