

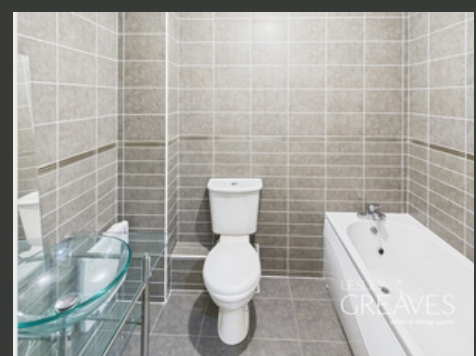

# £169,000

## SENSO COURT STOKE LANE

- FIRST FLOOR APARTMENT
- TWO BEDROOMS
- ENSUITE TO MASTER BEDROOM
- OPEN PLAN LIVING
- GARAGE
- POPULAR LOCATION
- EPC C



# Stunning Two-Bedroom Apartment in Sought-After Gedling Location with Garage and No Chain

NESTLED IN THE DESIRABLE AREA OF GEDLING, THIS FIRST-FLOOR APARTMENT PRESENTS AN EXCELLENT OPPORTUNITY FOR FIRST-TIME BUYERS AND INVESTORS ALIKE. IMMACULATELY PRESENTED AND FEATURING A SPACIOUS, NEUTRALLY DECORATED INTERIOR WITH PLENTY OF BUILT-IN STORAGE, THIS PROPERTY OFFERS THE PERFECT BLEND OF COMFORT AND CONVENIENCE. WITH NO UPWARD CHAIN, THE MOVE-IN PROCESS IS SMOOTH AND HASSLE-FREE.

THE APARTMENT BLOCK IS EQUIPPED WITH A LIFT FOR ADDED CONVENIENCE. AS YOU ENTER, YOU'RE GREETED BY A BRIGHT AND INVITING HALLWAY, WHICH LEADS TO A GENEROUSLY SIZED LIVING ROOM. THIS SEAMLESSLY FLOWS INTO A FULLY FITTED KITCHEN, COMPLETE WITH INTEGRATED APPLIANCES.

THE APARTMENT BOASTS TWO WELL-PROPORTIONED DOUBLE BEDROOMS, BOTH FEATURING FITTED FURNITURE, WITH THE MAIN BEDROOM BENEFITING FROM AN EN-SUITE. A WELL-APPOINTED THREE-PIECE BATHROOM SUITE COMPLETES THE INTERIOR.

ADDITIONAL BENEFITS INCLUDE COMMUNAL GARDENS TO THE REAR AND VISITOR PARKING.

THIS IS A RARE OPPORTUNITY TO ACQUIRE A BEAUTIFUL TWO-BEDROOM APARTMENT WITH THE ADDED BONUS OF A GARAGE FOR SECURE PARKING.

IDEALLY LOCATED, THE PROPERTY IS WITHIN CLOSE PROXIMITY TO SHOPS, RESTAURANTS, AND EXCELLENT TRANSPORT LINKS, OFFERING EASY ACCESS TO THE CITY CENTRE. THIS MAISONETTE PERFECTLY COMBINES MODERN LIVING WITH A PRIME LOCATION.

GROUND RENT & SERVICE CHARGE £119.00 PER MONTH

- LEASEHOLD
- COUNCIL TAX; BAND C
- LOCAL AUTHORITY; GEDLING BOROUGH COUNCIL
- MEASUREMENTS; 62 SQ METERS

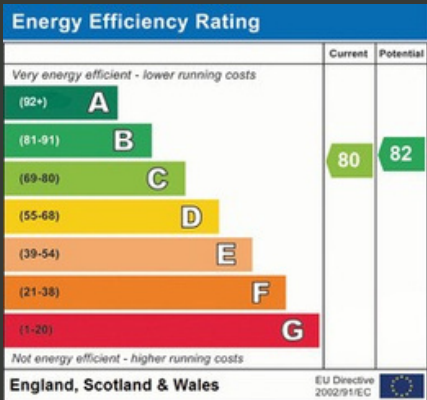





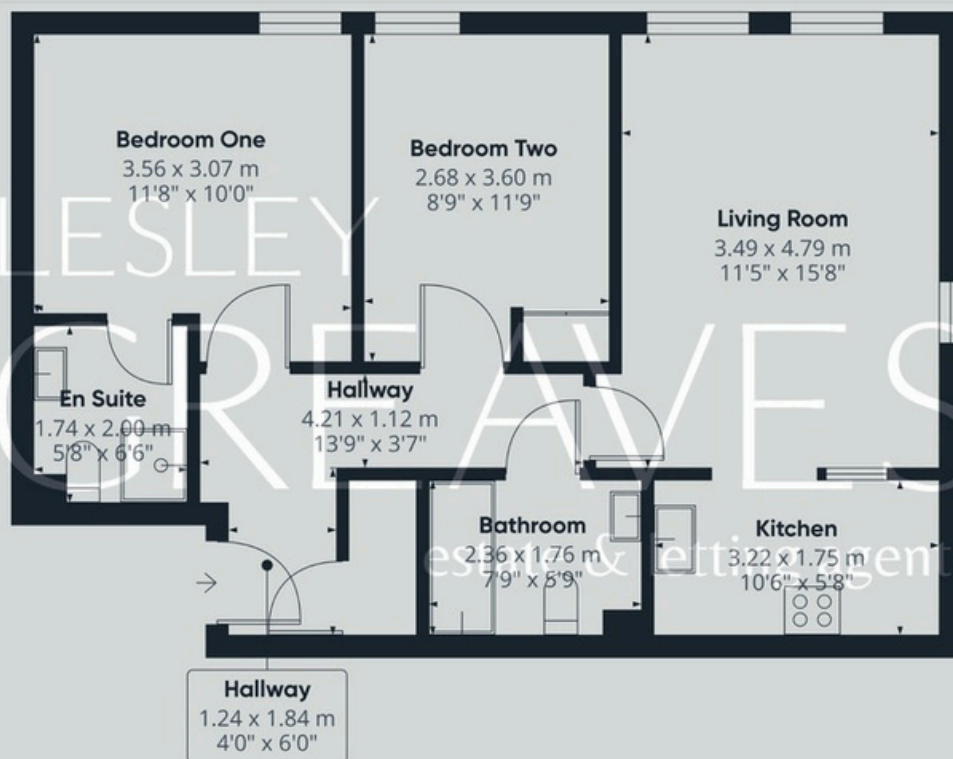

**Garage**  
22'1 x 9'0'  
(6.72M x 2.74M)

---

## Lesley Greaves Estate & Lettings Agents

20 Main Road ,Gedling, Nottingham, NG4 3HG

0115 987 7337

[sales@lesleygreaves.co.uk](mailto:sales@lesleygreaves.co.uk)