



£150,000

Guide Price

WALLET STREET
NETHERFIELD

- TWO BEDROOMS
- DINING KITCHEN
- DOWNSTAIRS BATHROOM
- LIVING ROOM
- COURTYARD GARDEN
- CLOSE TO TOWN CENTRE
- EPC D



Charming Period Terraced House in Popular Netherfield Location

THIS WELL PRESENTED PERIOD TERRACED HOUSE OFFERS CHARM AND MODERN CONVENIENCE IN EQUAL MEASURE. UPON ENTERING THROUGH THE FRONT DOOR, YOU'RE WELCOMED INTO A MODERN LIVING ROOM, WHICH OFFERS A WARM AND INVITING SPACE FOR RELAXATION. ITS COZY ATMOSPHERE IS PERFECT FOR UNWINDING AFTER A LONG DAY, WHILE ITS OPEN LAYOUT ALLOWS FOR EASY INTERACTION WITH THE ADJACENT KITCHEN AREA, CREATING A SEAMLESS FLOW BETWEEN THE TWO SPACES.

THE MODERN KITCHEN/DINER CREATES A SPACIOUS, AIRY FEEL AND FEATURES A BREAKFAST BAR, IDEAL FOR CASUAL DINING OR SOCIAL GATHERINGS. IT IS EQUIPPED WITH AMPLE STORAGE AND SPACE FOR FREESTANDING APPLIANCES MAKING THE KITCHEN NOT ONLY STYLISH BUT ALSO HIGHLY FUNCTIONAL, PROVIDING A CENTRAL HUB FOR COOKING AND ENTERTAINING.

A REAR LOBBY LEADS TO THE COURTYARD GARDEN, WHILE THE GROUND FLOOR BATHROOM IS FITTED WITH A SHOWER OVER THE BATH FOR ADDED FUNCTIONALITY.

UPSTAIRS, YOU WILL FIND TWO GENEROUSLY SIZED DOUBLE BEDROOMS, OFFERING COMFORTABLE LIVING SPACES FOR FAMILIES OR INDIVIDUALS ALIKE.

OUTSIDE, THE ENCLOSED COURTYARD GARDEN IS A PEACEFUL RETREAT, WITH A DECKED AREA PERFECT FOR OUTDOOR DINING, AND A GATED REAR ACCESS FOR CONVENIENCE.

LOCATED IN THE SOUGHT-AFTER RESIDENTIAL AREA OF NETHERFIELD, THIS HOME BENEFITS FROM EXCELLENT AMENITIES NEARBY, FOR LARGER SHOPPING NEEDS, THE VICTORIA RETAIL PARK IS CLOSE BY. PUBLIC TRANSPORT LINKS ARE ALSO EASILY ACCESSIBLE, WITH A RAILWAY STATION AND REGULAR BUS SERVICES, MAKING COMMUTING SIMPLE AND CONVENIENT.

- FREEHOLD
- COUNCIL TAX; BAND A
- LOCAL AUTHORITY; GEDLING BOROUGH COUNCIL
- MEASUREMENTS; 58 SQ METERS

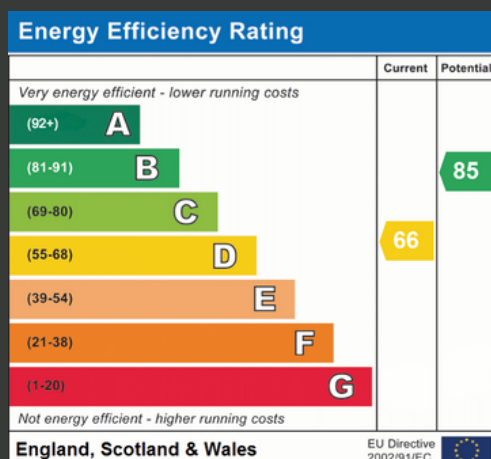



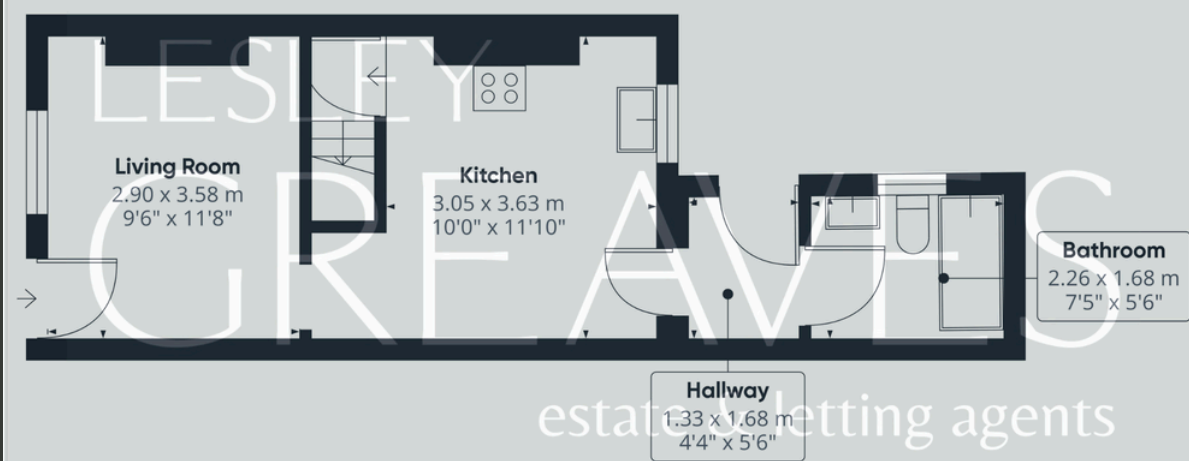

Floor 0

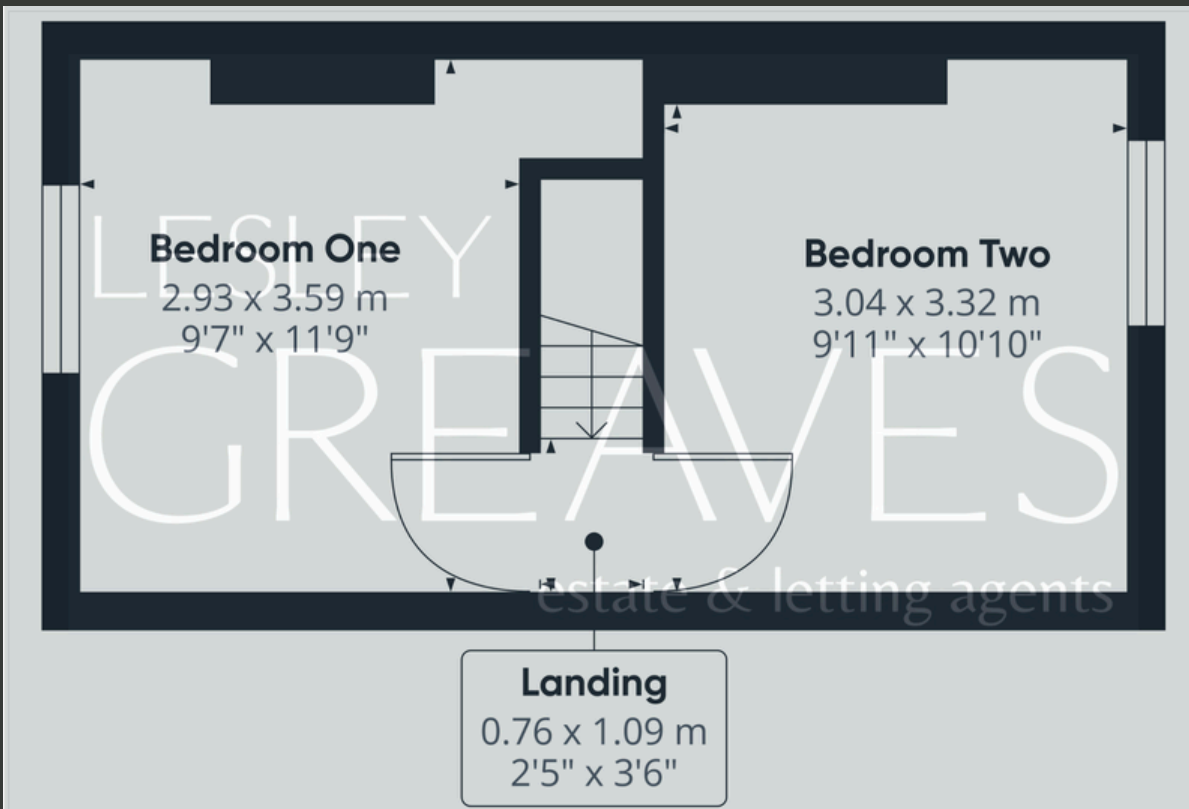

Floor 1

Lesley Greaves Estate & Lettings Agents

20 Main Road ,Gedling, Nottingham, NG4 3HG

0115 987 7337

sales@lesleygreaves.co.uk