



# £140,000-£150,000

Guide Price

HONEYWOOD DRIVE  
THORNYWOOD

- CHAIN FREE
- GAS CERTIFICATE
- ELECTRIC CERTIFICATE
- MODERN BATHROOM
- OPEN PLAN
- DRIVEWAY & GARAGE
- EPC C



## Three-Bedroom Terrace Town House - Chain Free

THIS THREE-BEDROOM TERRACE TOWN HOUSE IS OFFERED FOR SALE CHAIN-FREE AND COMES WITH CURRENT GAS AND ELECTRIC SAFETY CERTIFICATES, MAKING IT AN IDEAL BUY-TO-LET INVESTMENT OR A WORRY-FREE PURCHASE FOR ANY BUYER.

THE GROUND FLOOR FEATURES AN OPEN-PLAN LOUNGE AND DINING ROOM, SEAMLESSLY CONNECTED TO THE KITCHEN, CREATING A SPACIOUS AND VERSATILE LIVING AREA. UPSTAIRS, THE FIRST FLOOR COMPRISES THREE WELLSIZED BEDROOMS AND A FAMILY BATHROOM.

EXTERNALLY, THE PROPERTY BENEFITS FROM PARKING AND A GARAGE AT THE FRONT, PROVIDING AMPLE SPACE FOR VEHICLES AND STORAGE. THE REAR OF THE HOUSE BOASTS AN ENCLOSED GARDEN, PERFECT FOR OUTDOOR ACTIVITIES AND RELAXATION.

LOCATED IN A WELL-ESTABLISHED RESIDENTIAL AREA, THIS HOME IS CLOSE TO A WIDE RANGE OF AMENITIES INCLUDING SCHOOLS, LOCAL SHOPPING AREAS, SUPERMARKETS, PLAYING FIELDS, PUBLIC TRANSPORT LINKS, AND LEISURE CENTRES. WITH ITS CONVENIENT LOCATION, WELL-MAINTAINED CONDITION, AND ESSENTIAL SAFETY CERTIFICATIONS,

THIS PROPERTY IS A FANTASTIC OPPORTUNITY FOR INVESTORS AND HOMEBUYERS ALIKE. DON'T MISS THE CHANCE TO MAKE THIS CHARMING HOUSE YOUR NEW HOME OR INVESTMENT PROPERTY

- COUNCIL TAX; BAND A
- LOCAL AUTHORITY; GEDLING BOROUGH COUNCIL
- MEASUREMENTS; 64 SQ METERS
- Lease Term : From 27 January 1975 to 25 March 2971  
Rent : £25 a year

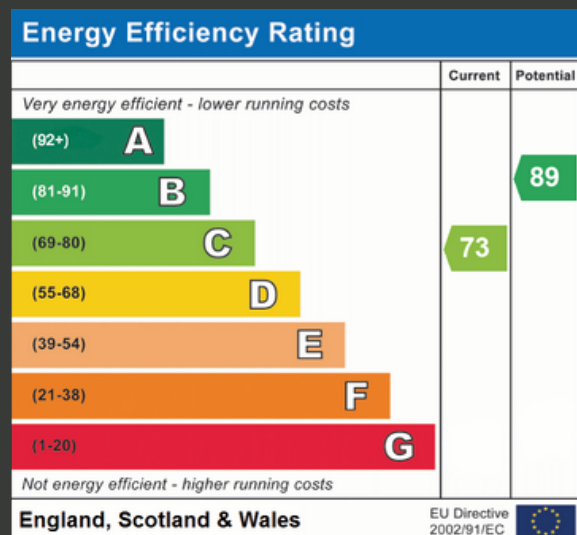

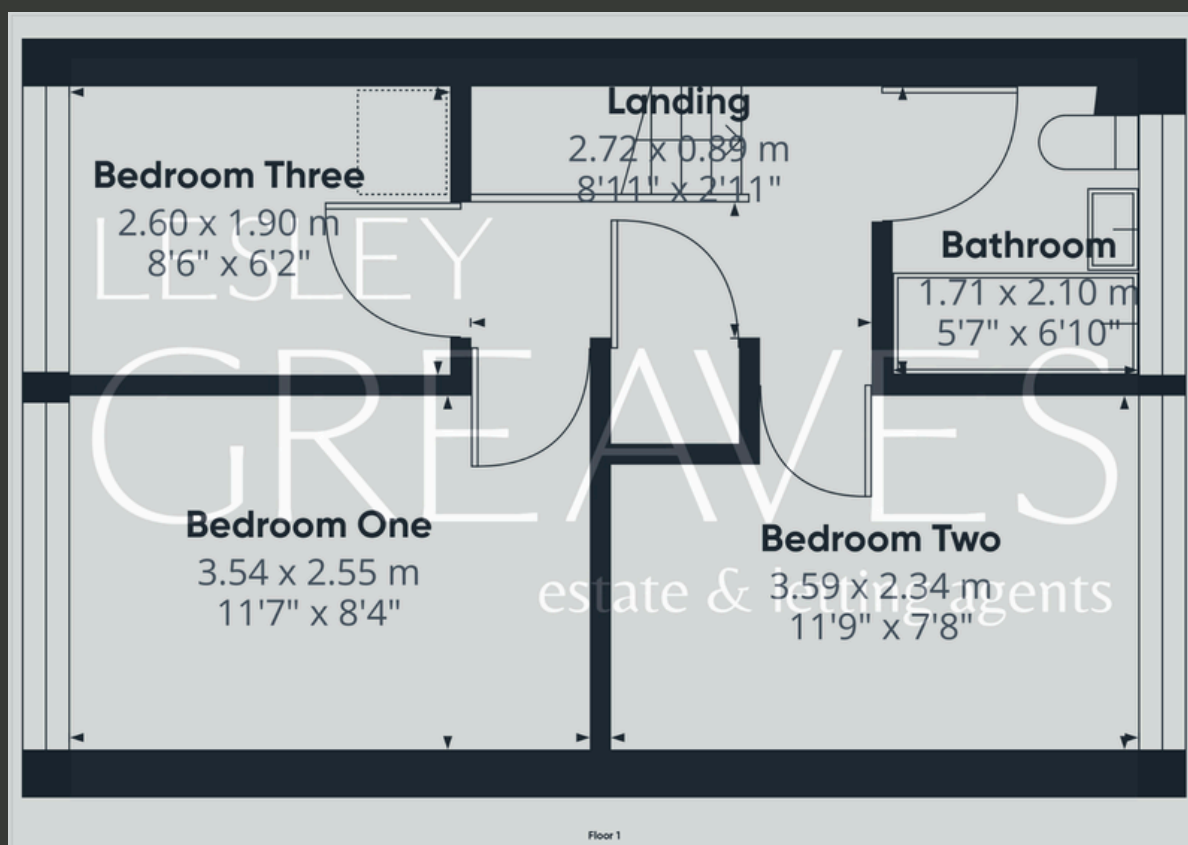
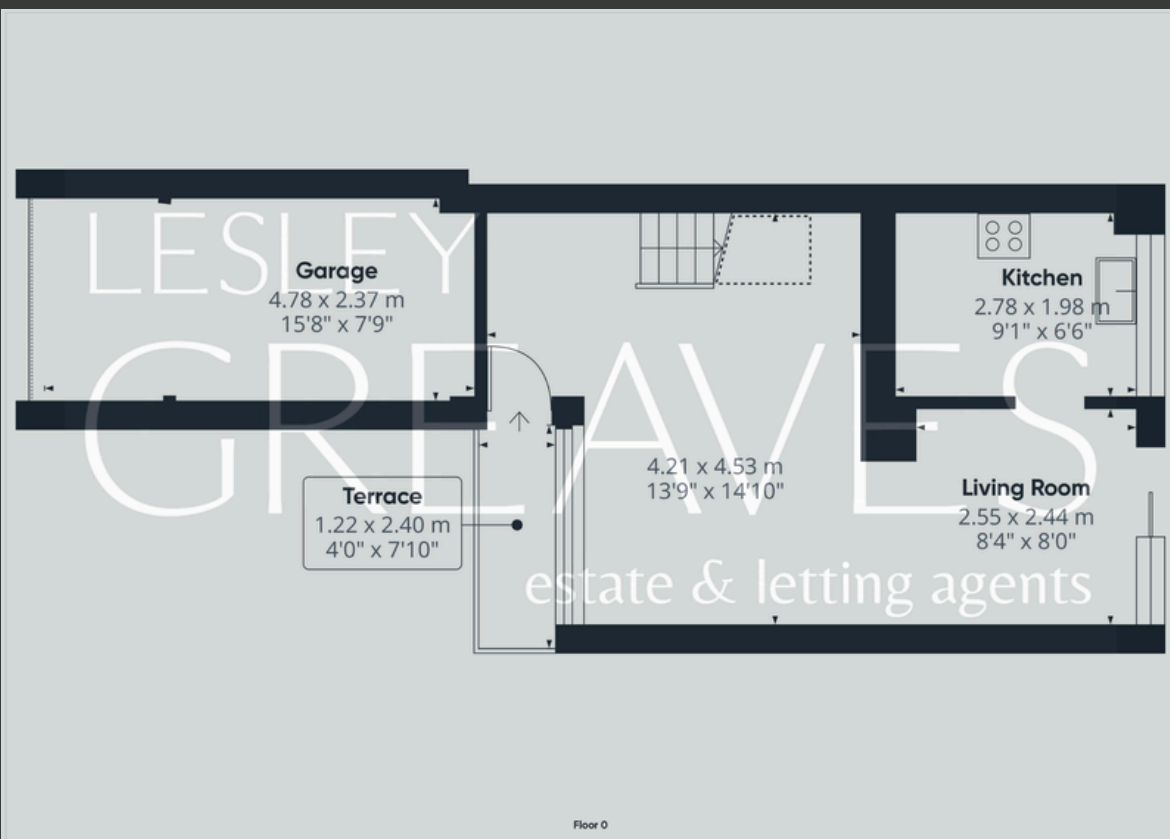

## Lesley Greaves Estate & Lettings Agents

20 Main Road ,Gedling, Nottingham, NG4 3HG

0115 987 7337

sales@lesleygreaves.co.uk