

Park Street West | Luton



venture
residential



Offers in Excess of £170,000

Are you looking for a great investment opportunity? Then look no further than this spacious two bedroom apartment located right in the heart of the Luton Town Centre! Call us today to arrange an appointment on 01582 249155.

01582 249155

www.venture-residential.co.uk

Description

**** BRINGING LONDON LIVING TO LUTON****

Venture Residential are pleased to bring to the market this spacious split level two bedroom apartment.

This apartment has been immaculately decorated and upgraded throughout meaning that you can move your furniture straight in.

The property is a great investment opportunity due to its close proximity within walking distance to Luton Town Centre, Luton mainline train station and The University of Bedfordshire as well as an array of shops, restaurants, banks and other local amenities including the popular Galaxy Centre where you can find a cinema, bowling alley and a 24 hour gym.

This home briefly comprises an entrance hall, open plan lounge and fitted kitchen with laminate flooring, two good size bedrooms and a modern bathroom with white bathroom suite.

To avoid disappointment call us today on 01582 249155 to arrange an appointment to view.



Ground floor

Entrance Hall

Door to side aspect, airing cupboard and laminate flooring.

Lounge/Kitchen 15' 9" x 14' 9" (4.8m x 4.5m)

Lounge area comprises 2 x windows to front aspect, electric storage heater, television aerial point and laminate flooring. Modern fitted kitchen with a range of wall and base units with work surfaces, sink unit with mixer taps, electric oven, electric hob and cooker hood.

Bedroom 2 12' 10" x 7' 3" (3.9m x 2.2m)

Window to front aspect, electric storage heater and carpeted.



First floor

Bedroom 1 16' 5" x 12' 6" (5.0m x 3.8m)

Window to front aspect, electric storage heater and carpeted.

Bathroom

Bath with mixer taps and shower attachment, wash hand basin, low level WC, electric, heated towel rail and fully tiled.



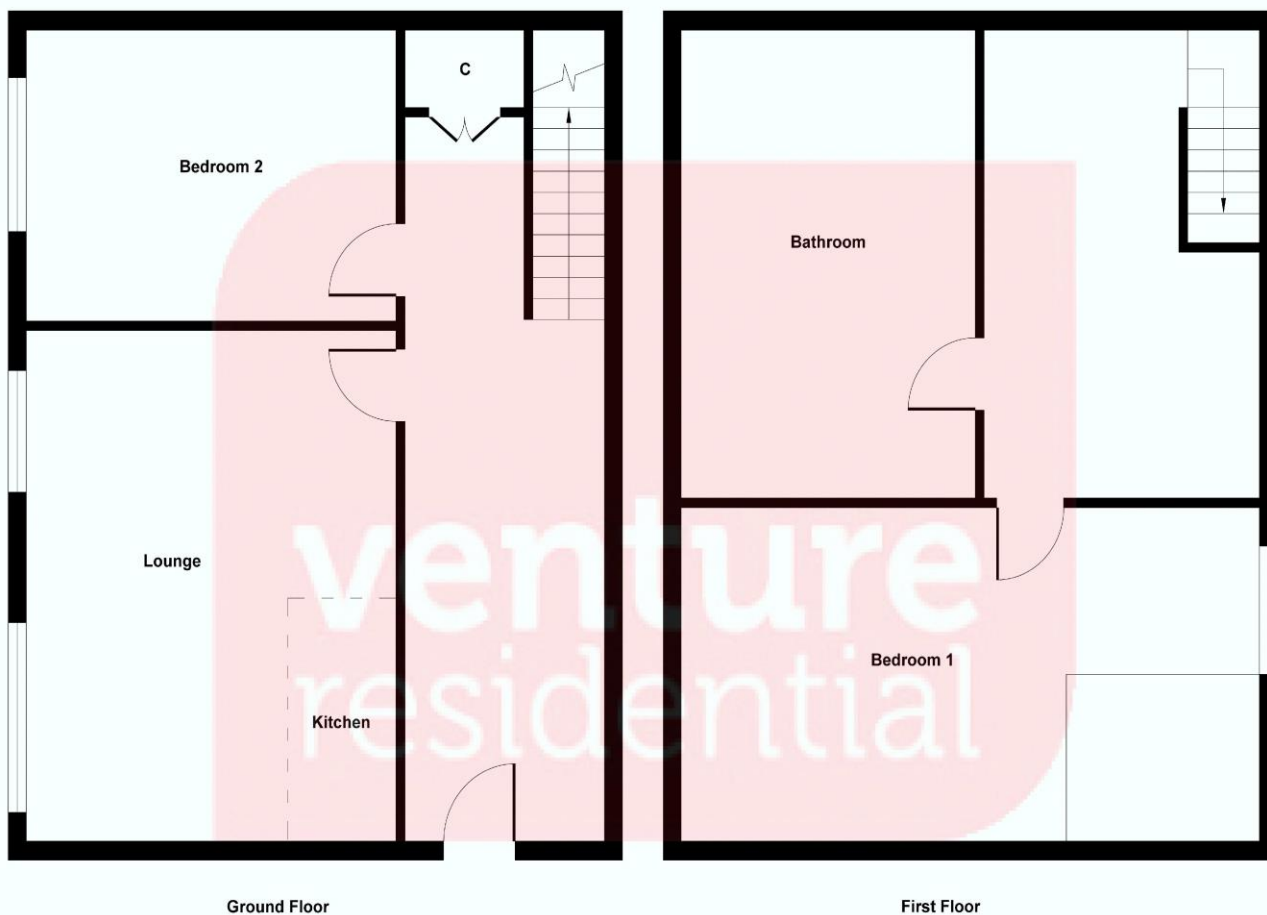

Illustration for identification purposes only, measurements are approximate, not to scale.
Produced by Elements Property

