



**venture**  
RESIDENTIAL

Gooseberry Hill, Luton, Bedfordshire, LU3 2LB

Offers in Excess of £375,000 Freehold



Nestled in a desirable and well-established area, this 2/3 bedroom detached bungalow presents an exciting opportunity for those looking to create a substantial family home





# Gooseberry Hill

Luton, LU3 2LB



- 2/3 bedroom detached bungalow
- Large plot
- Potential to extend (SSTP)
- In need of updating
- Off road parking for multiple cars
- Detached garage
- Great residential area



## Spacious 2/3 Bedroom Detached Bungalow with Development Potential – Gooseberry Hill, Luton

Nestled in a desirable and well-established area, this 2/3 bedroom detached bungalow presents an exciting opportunity for those looking to create a substantial family home. Offered chain-free, the property requires modernisation but boasts huge potential for development, making it an ideal project for investors, developers, or families seeking a long-term home with scope to extend (STPP).

Situated on a generous plot with ample off-road parking, the property benefits from a detached garage and a spacious rear garden, providing plenty of room for expansion. The existing layout includes a bright and airy lounge, a functional kitchen, two well-proportioned bedrooms, and a third room that can be used as a bedroom, office, or dining area, offering flexible living space to suit various needs.

With significant potential to extend and develop (STPP), a spacious plot with a large rear garden, ample off-road parking, a detached garage, and a sought-after location in Luton, this property is a rare find. The surrounding area is well-regarded for its peaceful residential setting, while still offering easy access to local amenities, schools, and excellent transport links, including the M1 and Luton train station.

This is a fantastic opportunity to secure a property with outstanding potential in a prime location. Whether you're looking to modernize or embark on a larger development project, this home is brimming with possibilities. Book a viewing today to explore its full potential!

### GROUND FLOOR

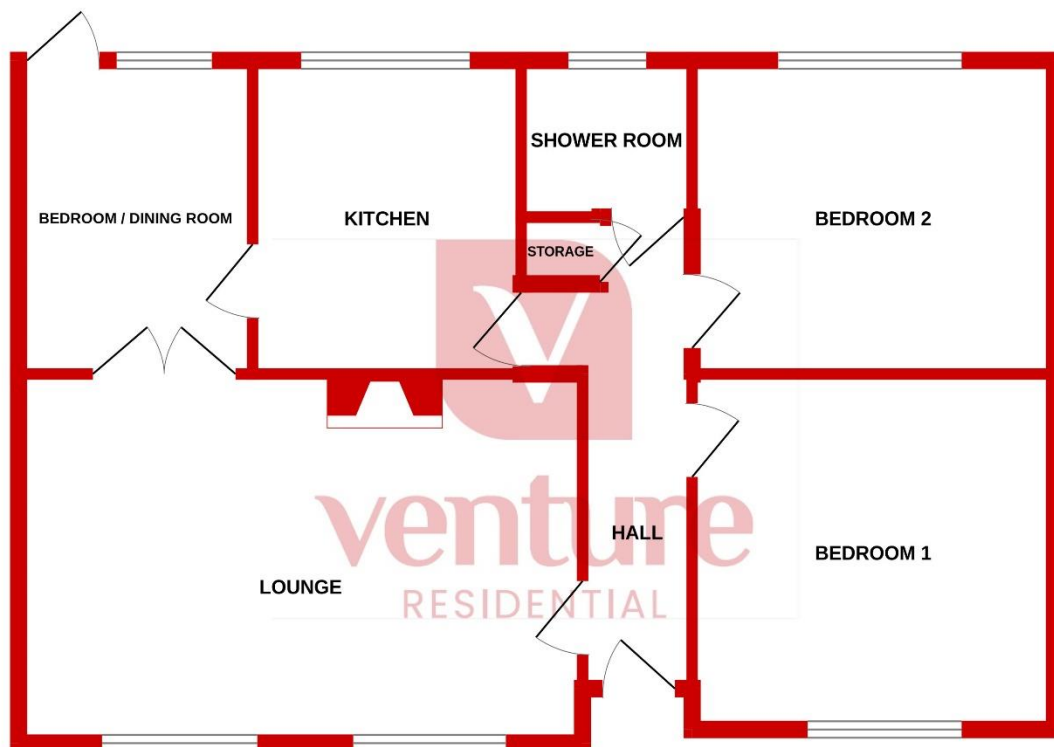

Whilst every attempt has been made to ensure the accuracy of the floorplan contained here, measurements of doors, windows, rooms and any other items are approximate and no responsibility is taken for any error, omission or mis-statement. This plan is for illustrative purposes only and should be used as such by any prospective purchaser. The services, systems and appliances shown have not been tested and no guarantee as to their operability or efficiency can be given.  
Made with Metropix ©2025





## Notice

Please note we have not tested any apparatus, fixtures, fittings, or services. Interested parties must undertake their own investigation into the working order of these items. All measurements are approximate and photographs provided for guidance only.



**9 Compton Avenue,  
Luton,  
Bedfordshire,  
LU4 9AX**

**T: 01582 249155  
E: [info@venture-residential.co.uk](mailto:info@venture-residential.co.uk)**



**rightmove.co.uk**  
The UK's number one property website



**Zoopla**