



Barons Court, Earls Meade, Luton, Bedfordshire, LU2 7EY

Price £160,000 Leasehold



Nestled in a highly sought-after location, this ground floor one-bedroom flat in Barons Court, Earls Meade, LU1, offers a blend of convenience and comfort.



Earls Meade

Luton, LU2 7EY



- Ground floor
- One bedroom apartment
- Located by the popular Popes Meadow / Wardown Park
- Allocated parking space
- Bathroom and an additional WC
- Walking distance to Luton Town station
- Great first time buy or buy to let investment

Nestled in a highly sought-after location, this ground floor one-bedroom flat in Barons Court, Earls Meade, LU1, offers a blend of convenience and comfort. Perfectly situated near the picturesque Popes Meadow Park and the popular Wardown Park, it provides a serene environment while still being within walking distance of Luton Town Station, making it ideal for commuters.

The property is well-presented throughout, ensuring a move-in-ready experience for its new owner.

An additional WC for guests enhances its practicality, complementing the main bathroom. This feature makes the flat particularly appealing for entertaining or hosting. A dedicated parking space further adds to its convenience.

Whether you are looking to step onto the property ladder or seeking a smart investment opportunity, this flat checks all the boxes. The combination of its location, excellent condition, and thoughtful amenities ensures it won't be on the market for long.

Key Features:

Prime Location: Close proximity to Popes Meadow Park, Wardown Park, and Luton Town Station.

Well-Maintained: In great condition throughout, with modern touches.

Additional WC: Perfect for guests and added convenience.

Parking Space: Dedicated space for hassle-free parking.

Ideal Opportunity: Suitable for first-time buyers or as an investment property.

Don't miss out on this fantastic opportunity to secure a property in a prime location. Contact us today to arrange a viewing!

GROUND FLOOR

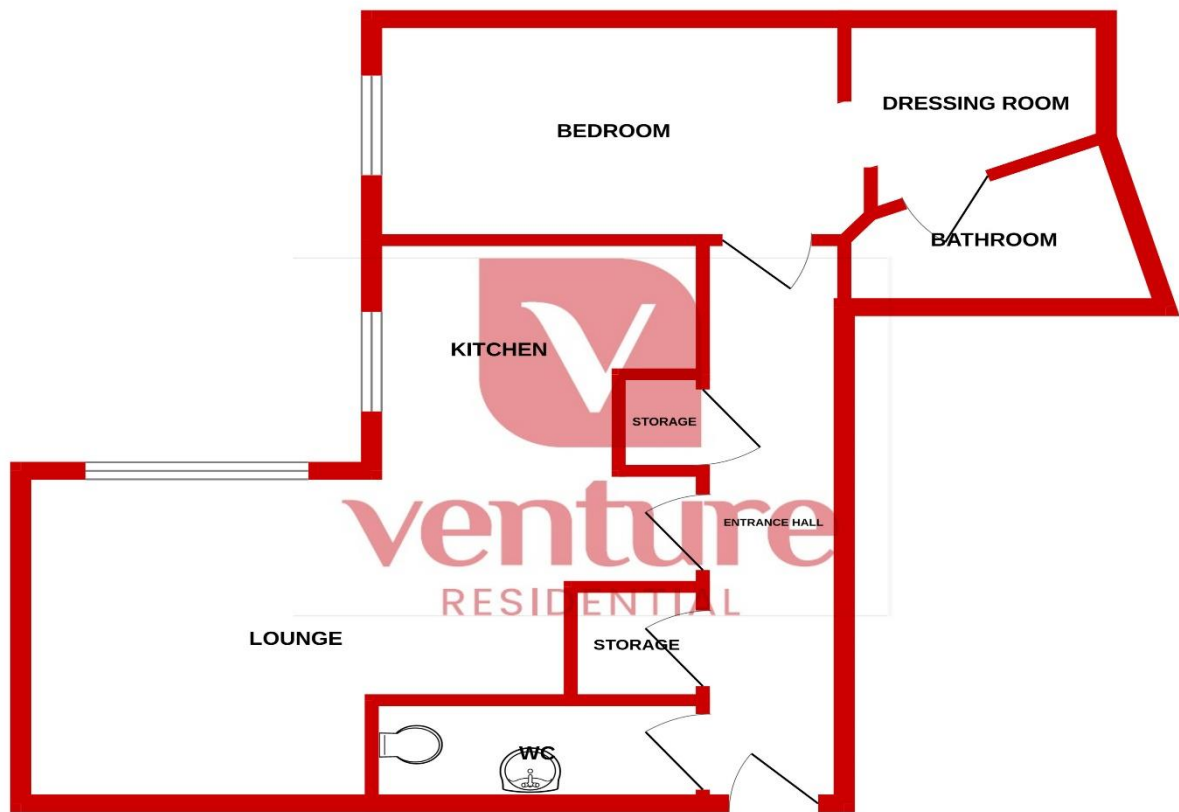

Whilst every attempt has been made to ensure the accuracy of the floorplan contained here, measurements of doors, windows, rooms and any other items are approximate and no responsibility is taken for any error, omission or mis-statement. This plan is for illustrative purposes only and should be used as such by any prospective purchaser. The services, systems and appliances shown have not been tested and no guarantee as to their operability or efficiency can be given.
Made with Metropix ©2024

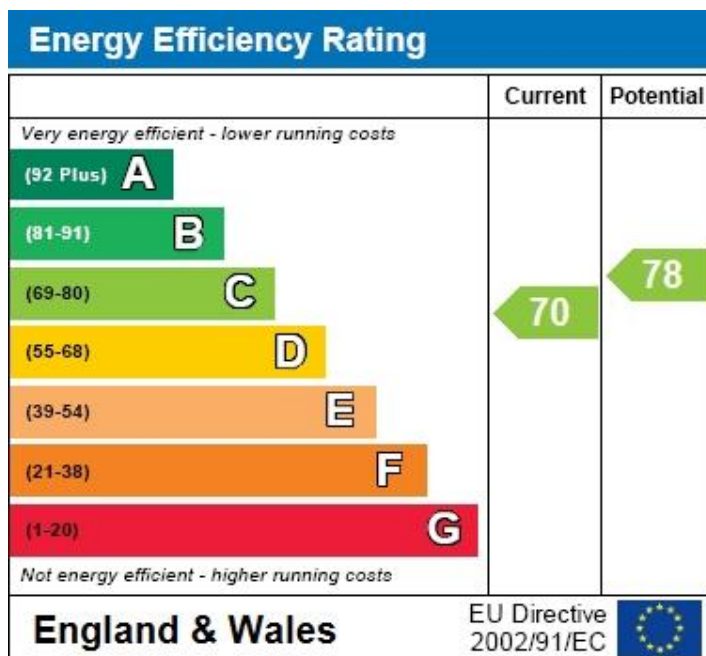

Notice

Please note we have not tested any apparatus, fixtures, fittings, or services. Interested parties must undertake their own investigation into the working order of these items. All measurements are approximate and photographs provided for guidance only.



**9 Compton Avenue,
Luton,
Bedfordshire,
LU4 9AX**

T: 01582 249155
E: info@venture-residential.co.uk

