



Beech Road, Luton, Bedfordshire, LU1 1DW

Price £240,000 Freehold



A well-presented 2-bedroom mid-terrace house, located on Beech Road, Luton. This traditional "two up, two down" property offers an ideal opportunity for first-time buyers or investors.



Beech Road

Luton, LU1 1DW



- Mid-terrace property
- Recently refurbished and ready to move in
- Two spacious double bedrooms
- Shower room to the rear
- Current rental income of £1,450 per month
- Ideal location near the popular Bury Park
- Perfect for first-time buyers or investors seeking a strong return



Recently refurbished to a high standard, this property is ready for immediate occupancy, providing a fresh and modern feel while retaining its original character.

Upon entering the property, you are greeted by two spacious reception rooms, offering flexible living space and an abundance of natural light.

The ground floor is completed by a modern fitted kitchen leading to a stylish shower room to the rear of the property.

The first floor boasts two generously sized double bedrooms, perfect for a small family or professional sharers.

The property has been thoughtfully updated with new flooring and fresh decor throughout, creating a bright and welcoming atmosphere.

This home is currently let at £1,450 per month, making it a fantastic investment opportunity with a strong rental income in place.

Situated just a stone's throw from the vibrant Bury Park, residents can enjoy a range of local amenities, including restaurants, shops, and excellent transport links. Luton town centre, as well as the train station, is easily accessible, offering a convenient commute to London and other major cities.

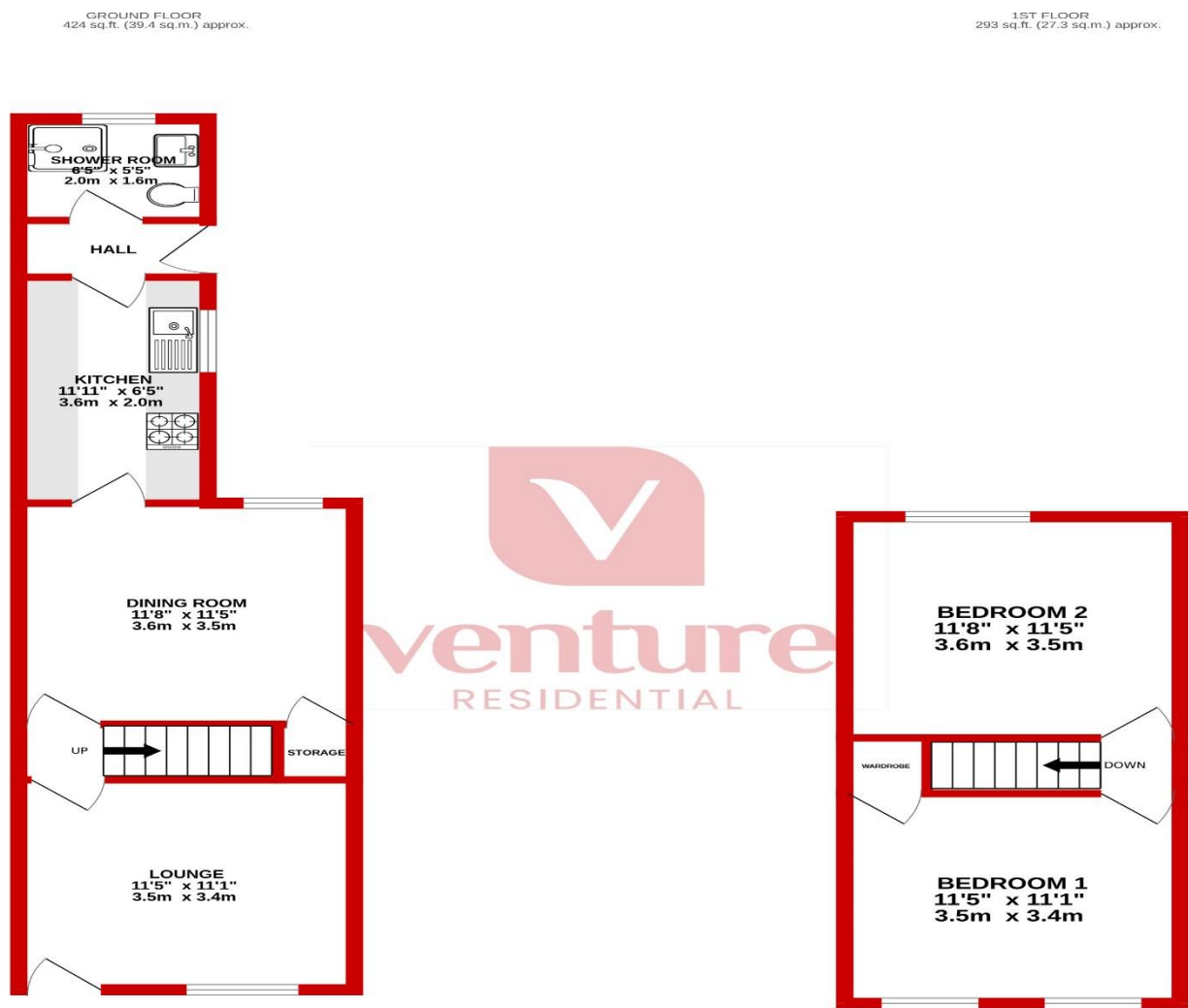

TOTAL FLOOR AREA : 718 sq.ft. (66.7 sq.m.) approx.

Whilst every attempt has been made to ensure the accuracy of the floorplan contained here, measurements of doors, windows, rooms and any other items are approximate and no responsibility is taken for any error, omission or mis-statement. This plan is for illustrative purposes only and should be used as such by any prospective purchaser. The services, systems and appliances shown have not been tested and no guarantee as to their operability or efficiency can be given.

Made with Metropix ©2024

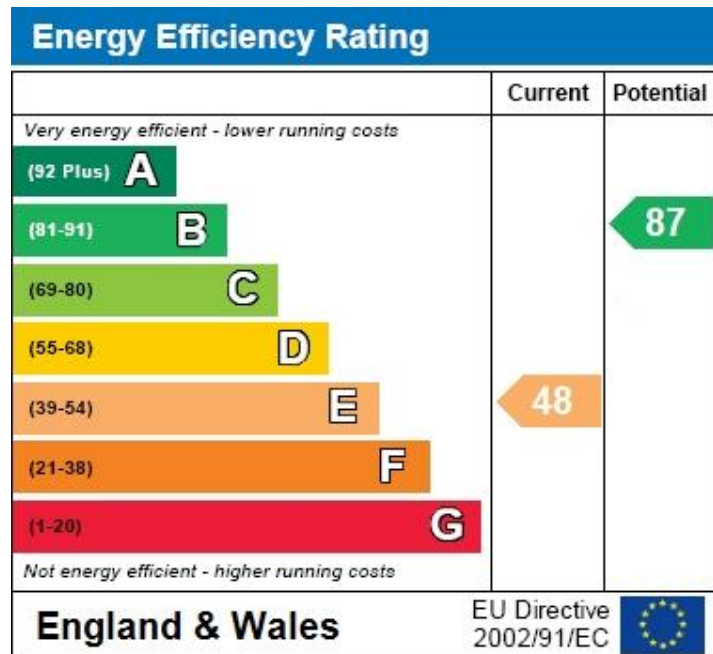

Notice

Please note we have not tested any apparatus, fixtures, fittings, or services. Interested parties must undertake their own investigation into the working order of these items. All measurements are approximate and photographs provided for guidance only.



**9 Compton Avenue,
Luton,
Bedfordshire,
LU4 9AX**

**T: 01582 249155
E: info@venture-residential.co.uk**

