

# venture RESIDENTIAL

Torquay Drive, Luton, Bedfordshire, LU4 9LL

Price £475,000 Freehold



Nestled in a highly desirable location within easy reach of Legrave Train Station, this impressive 5-bedroom semi-detached house offers a perfect blend of modern living and convenience. Boasting a spacious layout and a wealth of desirable features.



# Torquay Drive

Luton, LU4 9LL



Manually enter text or bullet points



Text Box - manually or copy & paste text - if not used delete and centre below floorplan

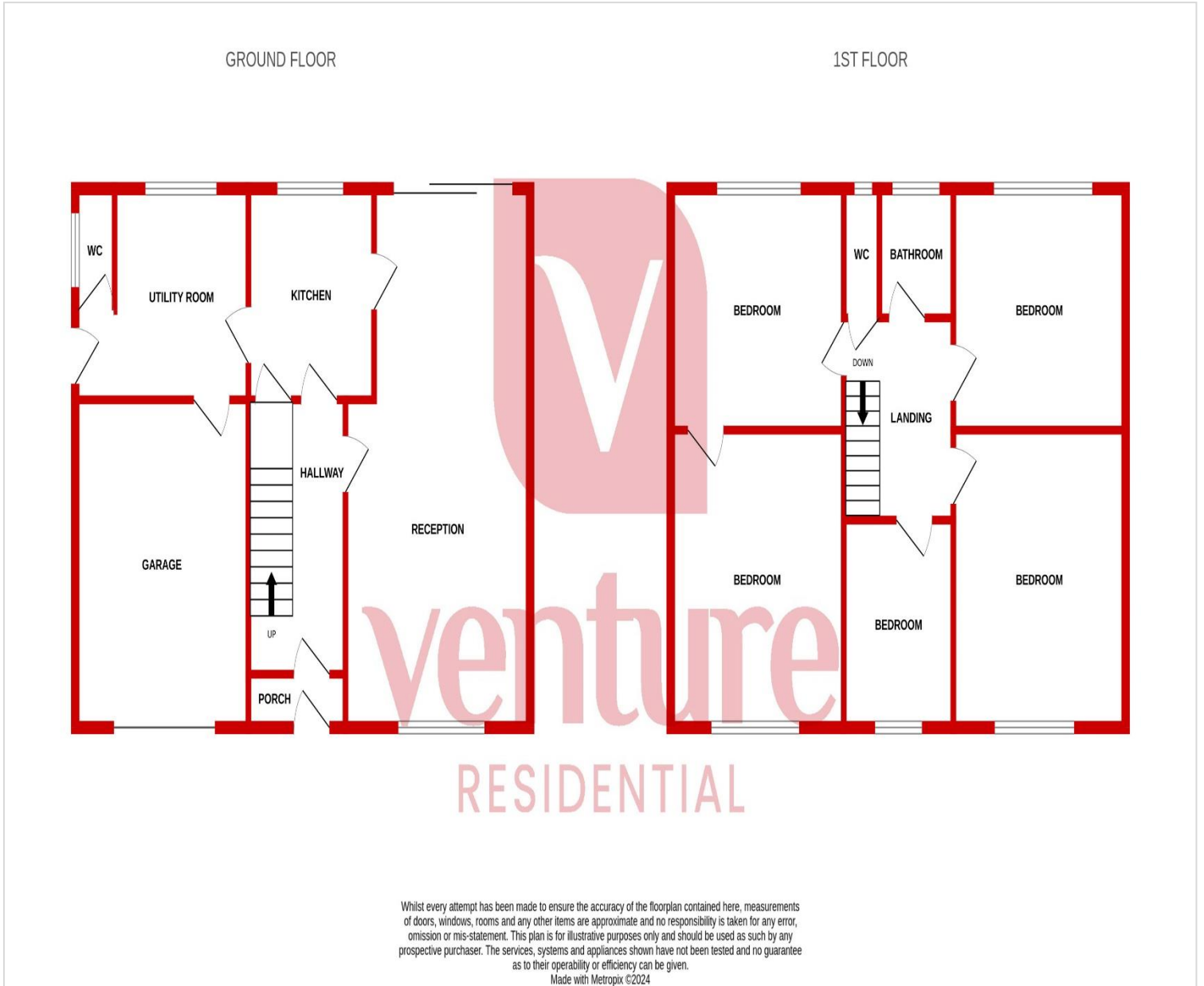



Energy Efficiency Rating		
	Current	Potential
Very energy efficient - lower running costs		
(92 Plus) <b>A</b>		<b>97</b>
(81-91) <b>B</b>		
(69-80) <b>C</b>		
(55-68) <b>D</b>		
(39-54) <b>E</b>	<b>51</b>	
(21-38) <b>F</b>		
(1-20) <b>G</b>		
Not energy efficient - higher running costs		
<b>England &amp; Wales</b>	EU Directive 2002/91/EC	

**Notice**

Please note we have not tested any apparatus, fixtures, fittings, or services. Interested parties must undertake their own investigation into the working order of these items. All measurements are approximate and photographs provided for guidance only.



**9 Compton Avenue,  
Luton,  
Bedfordshire,  
LU4 9AX**

**T: 01582 249155  
E: info@venture-residential.co.uk**

