



Arden Place, Luton, Bedfordshire, LU2 7YE

Price £160,000 Share of Freehold



2-bedroom top-floor flat. In need of modernisation, this property offers a blank canvas for buyers to create their dream home, boasting a wealth of space and an enviable location within walking distance to Luton train station,



Arden Place

Luton, LU2 7YE



- 2 Bedroom Flat
- Garage
- Requires Modernisation
- Walking Distance to Luton Train Station
- No Upper Chain



Nestled within a prime location, this 2-bedroom top-floor flat presents a rare opportunity for those seeking a project with immense potential. In need of modernisation, this property offers a blank canvas for buyers to create their dream home, boasting a wealth of space and an enviable location within walking distance to Luton train station.

Upon entering, you are greeted by a welcoming entrance hall, providing access to the various living spaces within the residence.

The property further benefits from two generously sized double bedrooms, providing comfortable accommodation for residents or guests alike. The potential of these rooms is vast, offering versatility in design and layout to cater to individual needs and preferences.

Completing the accommodation is a bathroom and separate shower, offering convenience and practicality for everyday living. With a bit of creativity and vision, these spaces have the potential to be transformed into stylish and modern facilities.

Additionally, this property boasts the rare advantage of a garage, providing secure off-road parking or valuable storage space.

Situated within walking distance to Luton train station, residents benefit from excellent transport links, connecting them to various destinations with ease. Whether commuting for work or exploring the surrounding areas, the convenience of this location cannot be overstated.

Offered with no upper chain, this property presents a unique opportunity for buyers to embark on a renovation project without delay. Whether you are an investor seeking to add value or a homeowner with a vision for transformation.

In summary, this 2-bedroom top-floor flat offers the perfect combination of space, potential, and location. With a little TLC and imagination, this property has the potential to be transformed into a stunning modern home. Early viewing is highly recommended to fully appreciate the possibilities that await within.

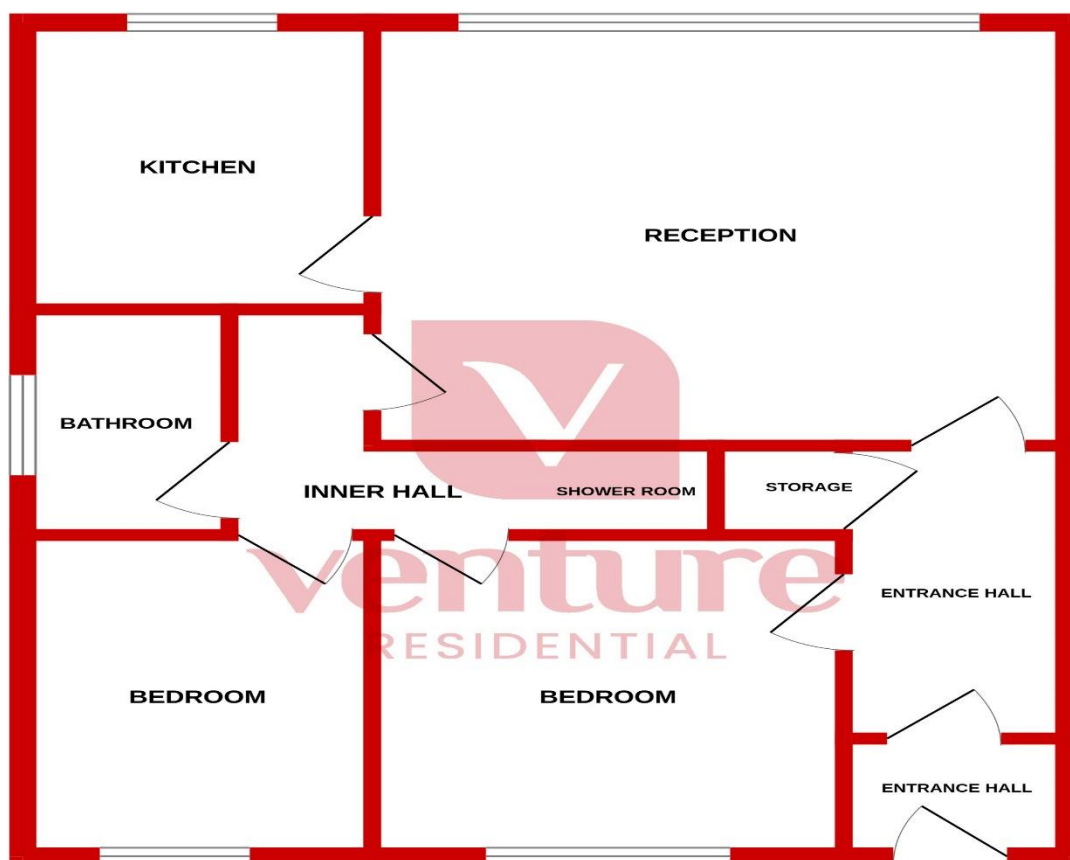

Whilst every attempt has been made to ensure the accuracy of the floorplan contained here, measurements of doors, windows, rooms and any other items are approximate and no responsibility is taken for any error, omission or mis-statement. This plan is for illustrative purposes only and should be used as such by any prospective purchaser. The services, systems and appliances shown have not been tested and no guarantee as to their operability or efficiency can be given.
Made with Metropix ©2024



Notice

Please note we have not tested any apparatus, fixtures, fittings, or services. Interested parties must undertake their own investigation into the working order of these items. All measurements are approximate and photographs provided for guidance only.



9 Compton Avenue,
Luton,
Bedfordshire,
LU4 9AX

T: 01582 249155
E: info@venture-residential.co.uk

