

A modern living room with two light grey sofas, a wooden coffee table, and a side table with a lamp. Large windows with grey curtains offer a view of a garden. A blue and purple circular graphic in the top right corner contains the text 'The Gosford 3 bedroom'.

The Gosford 3 bedroom

karbon
homes

For more information please contact us on:
salesandmarketing@karbonhomes.co.uk / 0191 223 8749

With 3 bedrooms, the Gosford, built by Taylor Wimpey, is perfect for anyone looking for a little extra space. Downstairs, the open plan kitchen/dining area has double doors that open out onto the garden, with a separate living room at the front of the home as well as a handy downstairs W.C. and storage cupboard. Upstairs, there are two double bedrooms and a further single bedroom which would also make a perfect home office.

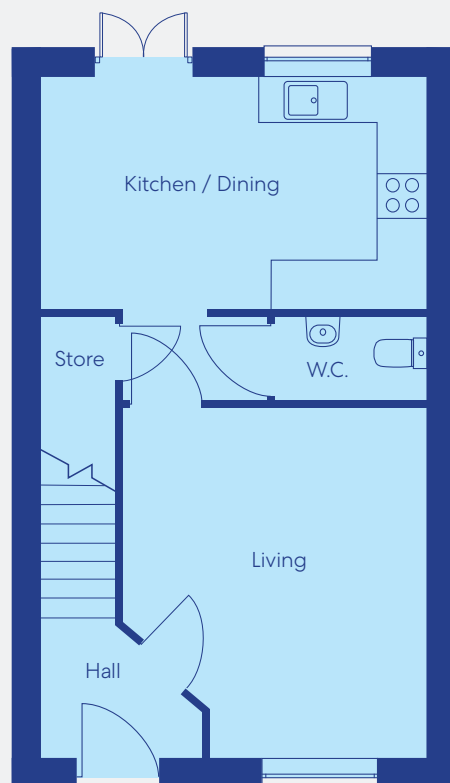

Ground Floor

Kitchen/Dining Area

4.72m x 2.89m

15' 6" x 9' 6"

Living Area

4.28m x 3.69m

14' 1" x 12' 1"

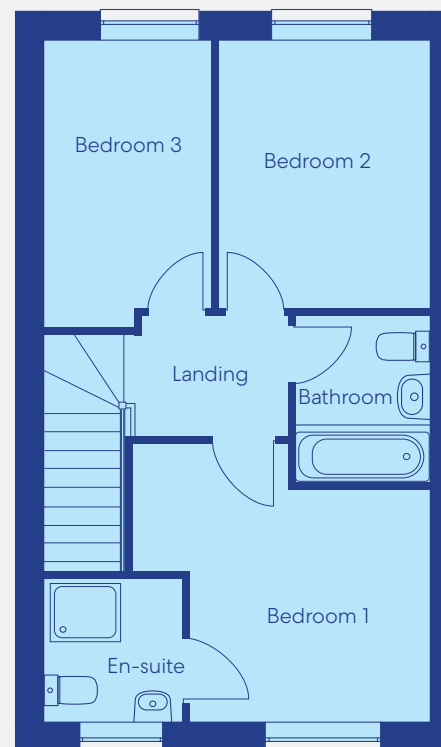

First Floor

Bedroom 1

2.96m x 2.84m

9' 9" x 9' 4"

Bedroom 2

3.32m x 2.63m

10' 11" x 8' 8"

Bedroom 3

3.56m x 2.01m

11' 8" x 6' 7"