



Nettledale Close, Runswick, TS13

Guide Price £260,000

Hendersons

www.myhendersons.co.uk | 01947 602626

hendersons.
estate agents



- 2 Bedroomed Bungalow
- Private Parking
- Detached Garage
- Chain Free
- Oil Fuelled Central Heating

Found in one of the North Yorkshire Coast's most picturesque locations, this chain free, well maintained, beautifully light, two-bedroom bungalow presents a rare opportunity to purchase a home in an area where properties seldom come to market. On entering the property via its attractive porch entrance, the spacious lounge with solid oak flooring and feature fireplace leads through to a practical dedicated dining area, where double doors open directly onto the low maintenance rear garden—creating a natural flow for indoor-outdoor living. The neutral kitchen is smartly fitted and traditional in style, with electric oven and hob.

There are two bedrooms, including a generous double with built-in wardrobes and a versatile second that could serve as a guest room, home office or nursery. The bathroom is fully tiled and features a contemporary three piece suite with shower over bath, that complements the home's overall presentation. Outside, the property continues to impress. The front garden is laid to lawn and sits alongside a private driveway with parking for two vehicles. A single garage, complete with power, lighting and water, offers further off-street parking or useful workshop space. At the rear, a good-sized garden is mainly lawned and includes a raised decked patio. There is an outside tap, oil tank and gated access back to the drive.

Whether you're searching for a peaceful coastal retreat, a stylish downsize, or a forever home close to nature and community, this lovely bungalow combines comfort, practicality





2

1

2



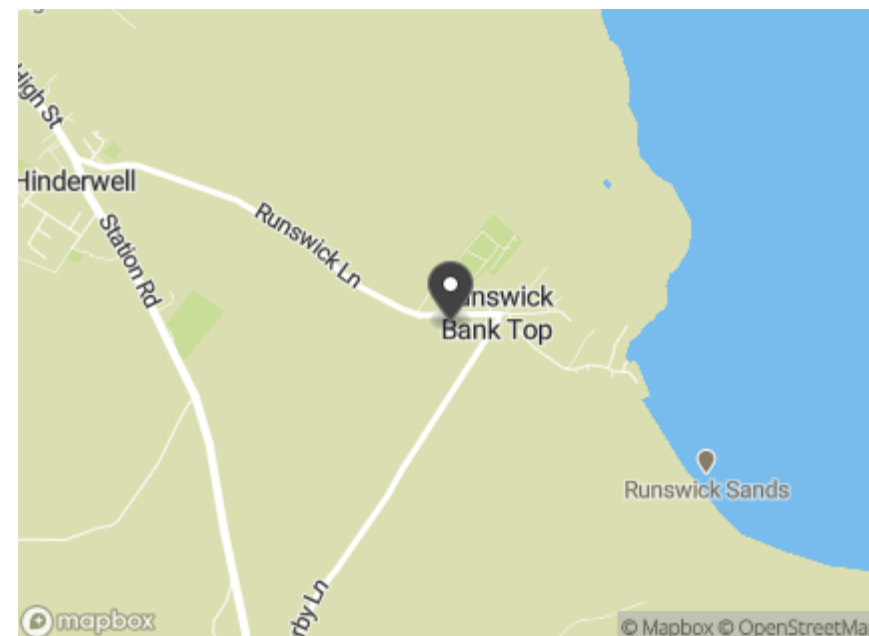
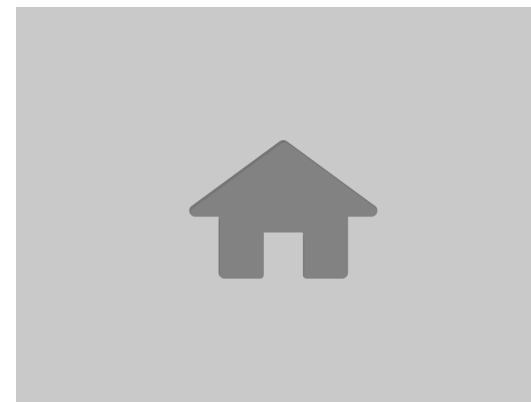
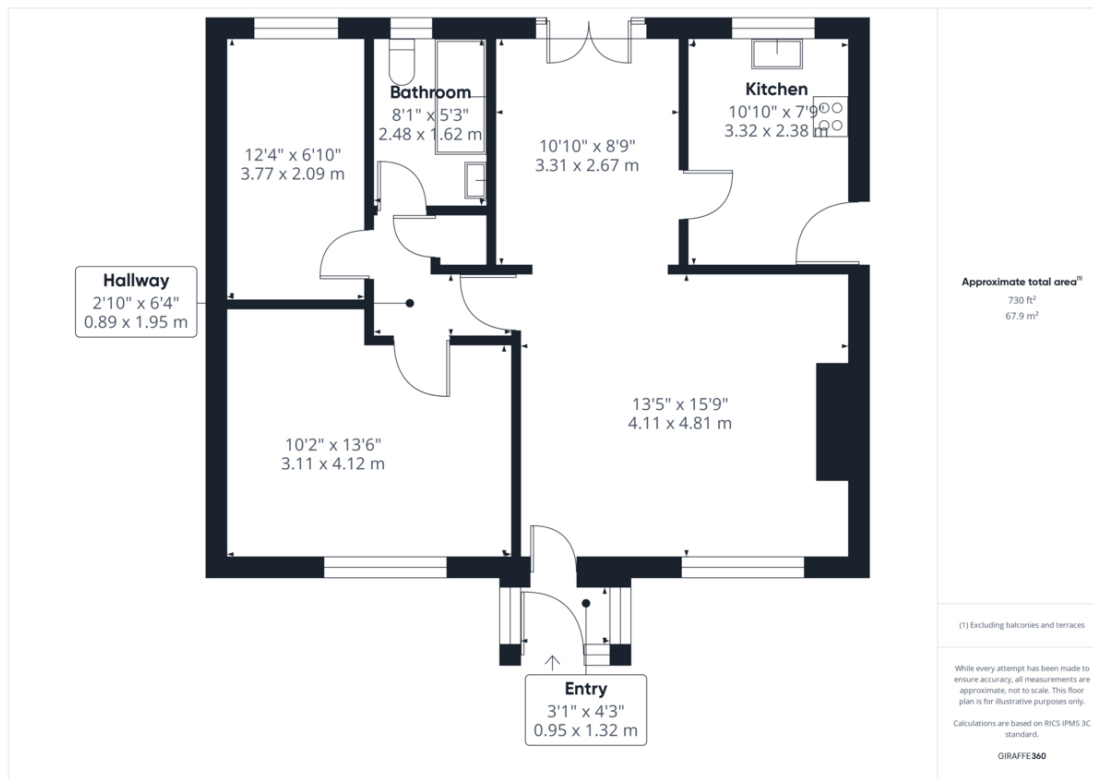

hendersons.
estate agents

Hendersons

21 Flowergate, Whitby, , North Yorkshire YO21 3BA

www.myhendersons.co.uk | 01947 602626