



Uppang Lane, Whitby, YO21

Guide Price £299,950

hendersons.
estate agents

Key Features

- Spacious three bedroom semi-detached property
- New roof installed in 2020
- Gas central heating and uPVC double glazing throughout
- Private rear garden with brick stores and greenhouse
- 3 Ways kitchen fitted in 2021 with Bosch appliances
- Great family location close to the ever popular West Cliff



Discover a charming semi-detached house on Upgang Lane, Whitby, offering a perfect blend of comfort and convenience. This property features three bedrooms, one bathroom, and a garage, ideal for families or those looking for extra space.





Nestled in the picturesque town of Whitby, this three bedroom semi-detached house on Upgang Lane offers an attractive option for those seeking a comfortable family home. The property comprises three bedrooms, providing ample space for family living. A spacious bathroom serves the household, while the garage offers additional storage options or parking for an old car.

The property has been maintained to a high standard over the years and benefits from gas central heating, uPVC double glazing and a new roof in 2020. The kitchen was replaced in 2021 by locally renowned 3 Ways and has quality Bosch appliances.

Whitby is renowned for its coastal charm, making it a desirable location for residents and this property is only a 300 meters from the popular West Cliff, where you will find stunning walks and access to the beach.

The property benefits from its convenient location close to local shops and post office on the Parade. Don't miss the opportunity to make this property your own; contact us today to learn more.



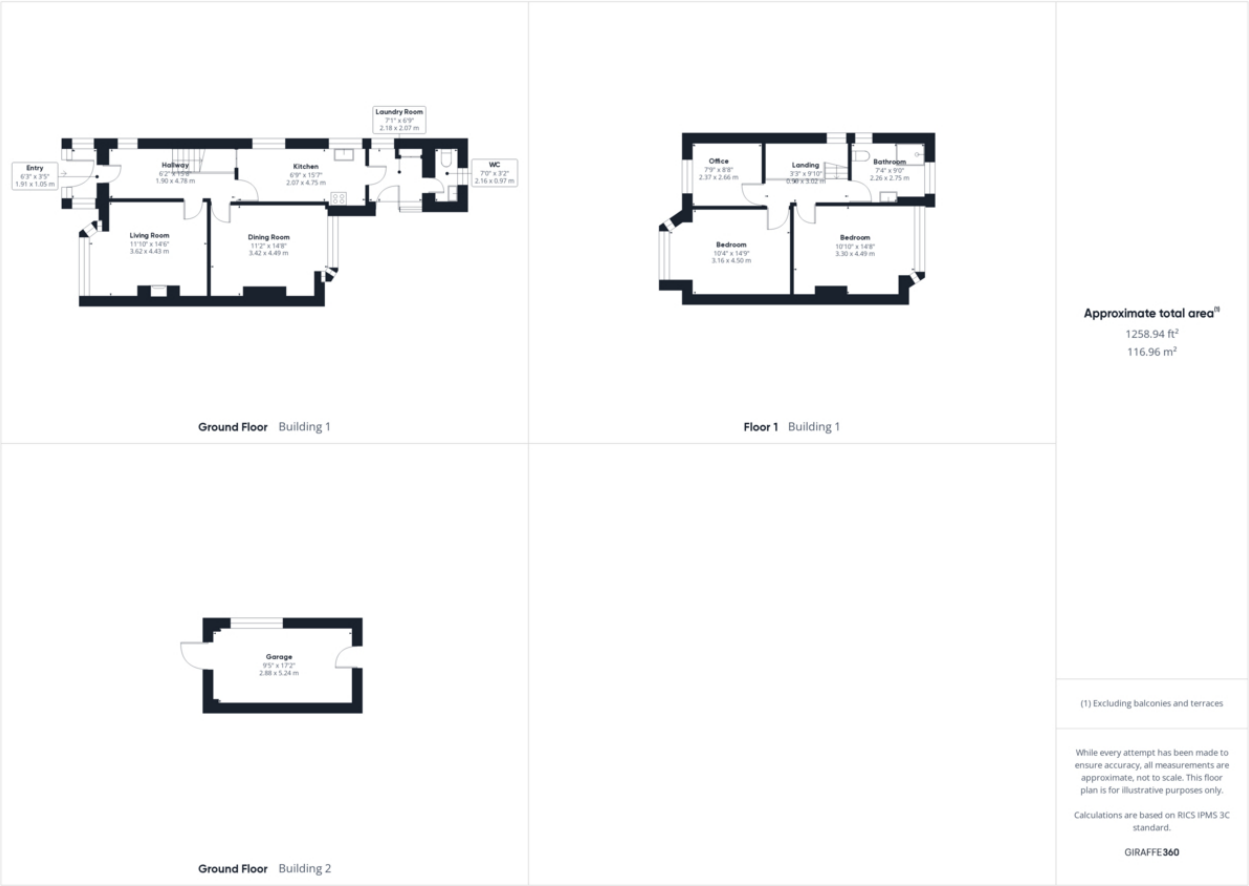

Tenure Type: Freehold
Council Tax Band:
Council Authority: