

# 31 SUTCLIFFE COURT

---

BYLAND ROAD, WHITBY,  
NORTH YORKSHIRE,  
YO21 1YH



Guide Price £170,000

---



# The Details...

Hendersons introduce to you 31 Sutcliffe Court, Whitby.

An immaculate two bedroomed, terraced bungalow found on this ever popular development, specifically designed by Accent Homes for the over 55s. There is a lovely sense of community to be found here and once you step inside this modern bungalow, you will see just why this one is a real find. With residents parking available and being less than a minutes walk from a very regular bus route, easy access to Whitby Town and surrounding areas is a real cinch.

The property briefly comprises large neutrally decorated, light and airy lounge with feature Fireplace and backlit surround. Patio doors give a wonderful aspect on to the rear garden. The recently fitted kitchen is quality through and through, fitted by Stringers with black Granite worktops, white gloss cabinets with 'pull down' easy to access internal shelving. There is a modern electric oven with digital hob and space for a washing machine and fridge freezer. The kitchen is complimented well with a white, metro tiled splash back.

Onto the bathroom that is modern and stylish, with underfloor heating and is fully tiled. An electric corner shower features with wash basin and vanity unit, W.C. and heated towel rail. There are two double bedrooms, both carpeted and again decorated in neutral tones.

Externally there is a good sized rear garden laid to lawn with mature borders and a patio area for seating. To the front, mature shrubs and bedding plants add a cottage style feel to the garden. Heated via electric storage heaters and double glazed throughout.

Call a member of the friendly team at Hendersons to book your viewing appointment today.

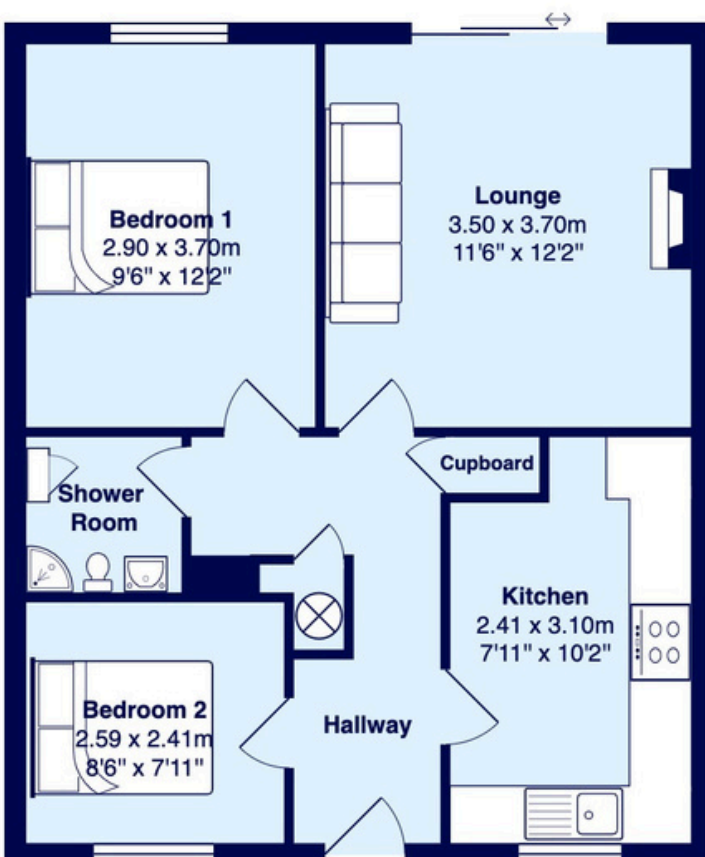

## Useful Information

- Tenure: Leasehold
- Council Tax Band: A
- EPC Rating: D
- All mains services connected except Gas

# Gallery

31 SUTCLIFFE COURT





# Want to know more. contact us.

W: [www.myhendersons.co.uk](http://www.myhendersons.co.uk)

E: [info@myhendersons.co.uk](mailto:info@myhendersons.co.uk)

T: 01947 602626

**hendersons.**  
estate agents

