

39 THE ROPERY

WHITBY,
NORTH YORKSHIRE,
YO22 4EY



Guide Price £249,950

39 The Ropery...

Hendersons bring to the market this well loved semi detached family home found in a popular residential location only a short stroll from the centre of town. Offering truly stunning panoramic views down the harbour and across Whitby.

This traditional property offers really well proportioned rooms and with some modernisation, the potential to make a wonderful family home for its new occupiers.

The kitchen is spacious with traditional style cabinetry, offers room for dining and overlooks the pretty rear garden. The lounge again is a good size, with living flame gas fire and stone surround, but the real feature here being the beautiful views across the town that can be enjoyed everyday.

To the ground floor you will also find a useful W.C. and a separate utility room with sink, located just off the Kitchen via the linked entry way.

Upstairs there is fully tiled house bathroom featuring sink, W.C and corner shower. There are three bedrooms, two of which are very spacious doubles with built in cupboards and a single room that again offers amazing elevated views over the town.

To the exterior there is a pretty cottage style, paved front garden and to the rear, backing on to the fields beyond, is a large tiered garden with mature shrubs and plants. There is room here for sitting out also.

This property is double glazed and has previously had a full new roof. Parking is on street.

Call a member of the team at Hendersons to book your viewing in order to see the full potential this property offers.

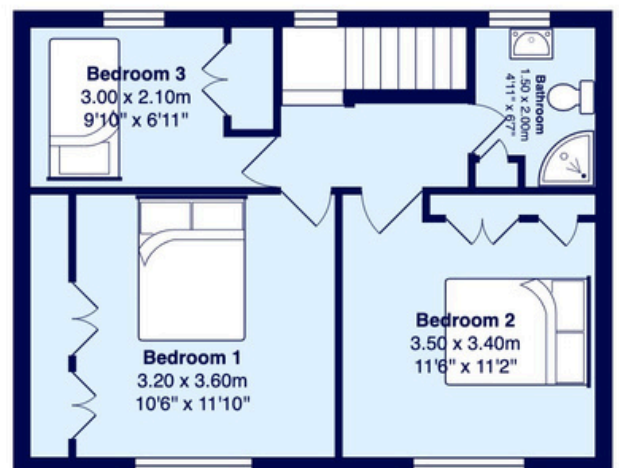
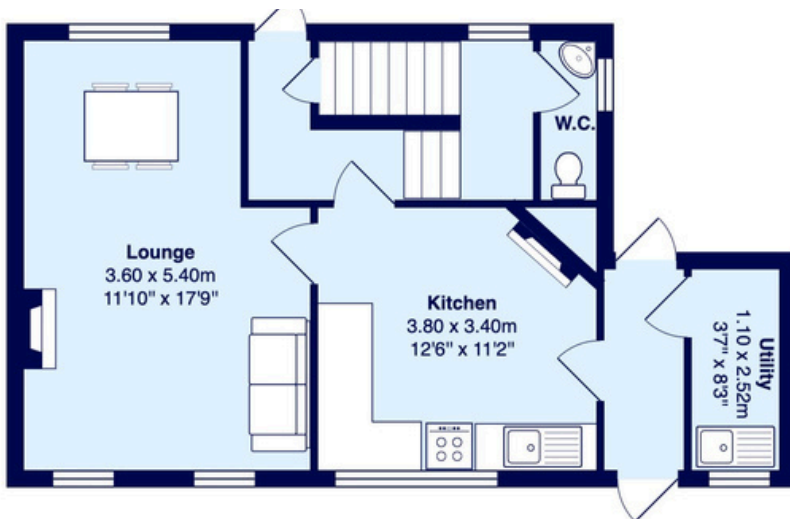

Useful Information

- Tenure: Freehold
- Council Tax Band:
- EPC Rating: TBC
- All mains services connected

Gallery

39 THE ROPERY



Want to know more. contact us.

W: www.myhendersons.co.uk

E: info@myhendersons.co.uk

T: 01947 602626

hendersons.
estate agents

