

HENDERSONS



FLAT 1, 9 MOUNT FARM CLOSE, WHITBY
Monthly Rental Of £565



ABOUT THIS PROPERTY

Hendersons introduce Flat 1, 9 Mount Farm Close, a one bed apartment is located in the popular Eskdale Park area of Whitby. Only a short walk from many amenities including large supermarkets and bus stops.

The property briefly comprises of an entrance hallway with two useful storage cupboards, a huge double bedroom with two sky light windows, a bathroom with white three piece suite that includes a bath with shower over, w.c and hand basin and an open plan lounge/kitchen/diner kitchen with cooker and hob. Heated via electric storage heaters and double glazed throughout.

Offered unfurnished and on a 6 month Assured Shorthold Tenancy, a Holding Deposit equivalent to one weeks rent (£130) will be required to secure the tenancy application once suitable to both parties. The Holding Deposit will be deducted from the first month's rent subject to suitable references. Provision of false or misleading information may result in the Holding deposit being retained by Hendersons.



Key information about this property...

- EPC Rating: D
- Council Tax Band:
- Property Reference: 5170
- Services: All mains connected except gas
- Agreement: 6 month AST
- Deposit: £565

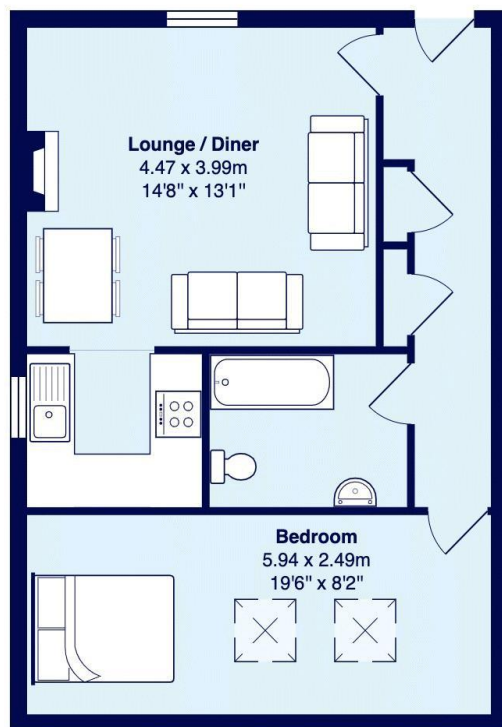
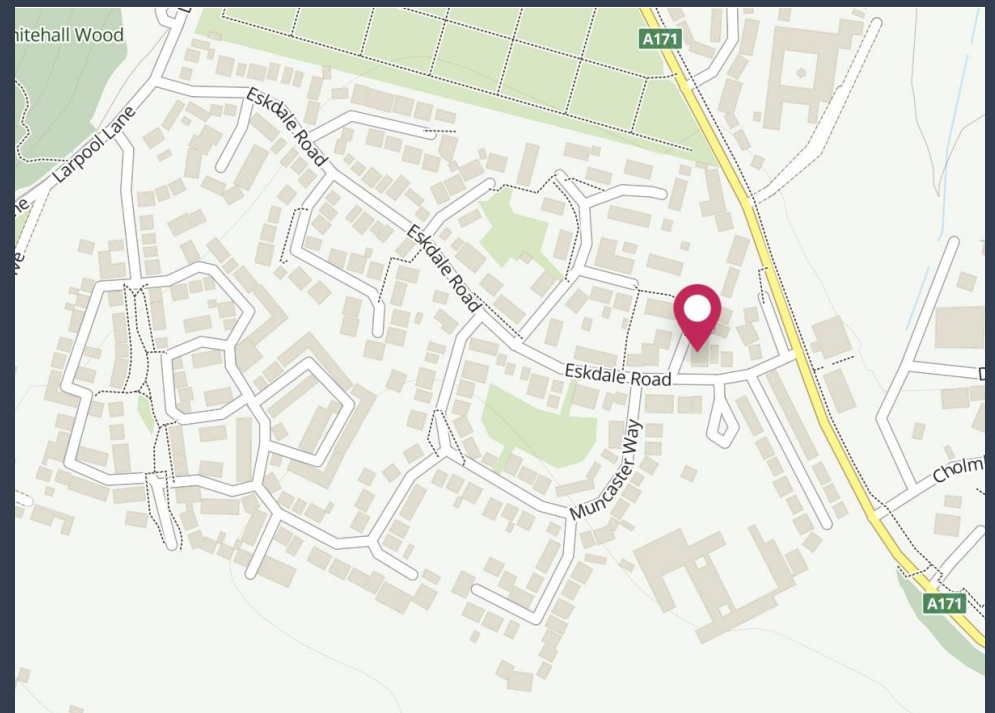

**Want to book a viewing of this property call
one of our property advisors on 01947 60 26 26
Monday to Friday – 9am to 5.30pm
Saturday – 9am to 4pm**

All material is Copyrighted to Henderson Property Services (Yorkshire) Limited and must not be copied without written permission from Hendersons.

Henderson Property Services (Yorkshire) Limited trading as Hendersons
Registered in England and Wales at 21 Flowergate, Whitby, North Yorkshire
YO21 3BA
Company No: 09395331 VAT No: 208959178

