



## 6 Halford Drive , Manchester, M40 0BP

**Offers Over £250,000**



**\*\*\*THREE BEDROOMS\*\*\*DETACHED\*\*\*GARAGE\*\*\*GARDENS\*\*\*FREEHOLD\*\*\*** Cousins Estate Agents are delighted to present this well-presented three-bedroom detached family home, ideally positioned in a quiet and sought-after cul-de-sac in the heart of New Moston, Manchester. This property offers a fantastic opportunity for families looking for a home with spacious living areas, excellent outdoor space, and convenient access to local amenities and transport links.

Internally, the property features a welcoming external porch, perfect for storing coats and shoes, which opens into a bright and generously sized living room. Stairs lead to the first floor, while the living room flows seamlessly into a separate dining area, creating an ideal space for family meals and entertaining. The modern fitted kitchen offers a range of wall and base units with ample workspace.

Upstairs, you will find three well-proportioned bedrooms and a contemporary family bathroom. Each bedroom benefits from natural light, making them versatile spaces suitable for both bedrooms and home offices if required.





- Porch 6'10"\*4'3" (2.1\*1.3)
- Living Room 17'3"\*14'5" (5.27\*4.4)
- Dining Room 8'1"\*8'0" (2.47\*2.46)
- Kitchen 8'0"\*8'8" (2.45\*2.66)
- Landing
- Bedroom 1 11'5"\*8'11" (3.5\*2.74)
- Bedroom 2 10'10"\*8'11" (3.32\*2.74)
- Bedroom 3 8'0"\*7'10" (2.45\*2.4)
- Bathroom 7'10"\*6'6" (2.4\*2)
- Garage

Area Map

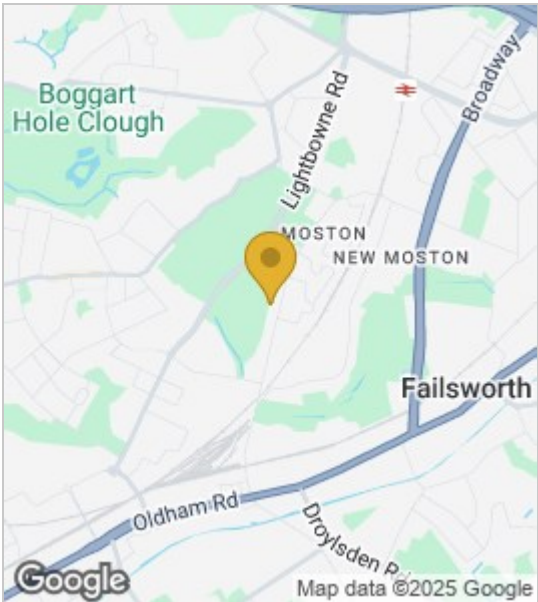

Floor Plans

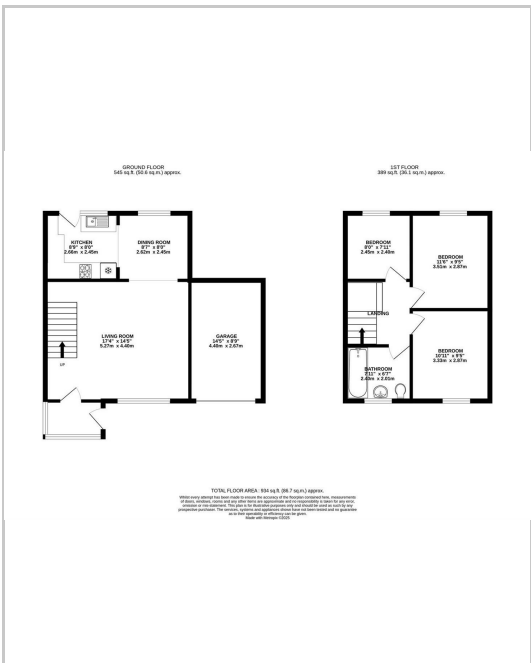

Energy Efficiency Graph

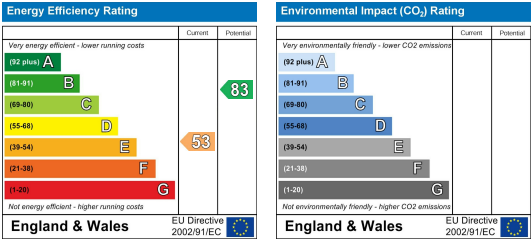

These particulars, whilst believed to be accurate are set out as a general outline only for guidance and do not constitute any part of an offer or contract. Intending purchasers should not rely on them as statements of representation of fact, but must satisfy themselves by inspection or otherwise as to their accuracy. No person in this firms employment has the authority to make or give any representation or warranty in respect of the property.

