



99 Heaton Park Road , Manchester, M9 0QQ

Asking Price £210,000



SPACIOUS FAMILY HOMETHREE BEDROOMS***SEMI-DETACHED***DRIVEWAY***EXTENDED***SOUGHT AFTER LOCATION***CLOSE TO HEATON PARK & SUPERMARKETS***EASY ACCESS TO M60 MOTORWAY & METROLINK*** Cousins Estate Agents are pleased to present this EXTENDED FAMILY HOME for sale in Blackley, Manchester.

The spacious accommodation has been extended and consists: Entrance Hallway, Lounge, Extended Lining room, Kitchen/Diner, Three Bedrooms & Family Bathroom.

Externally, there is a front driveway, side passage and grassed rear garden with shrubs.

Heaton Park Road is a popular position found just off Victoria Avenue (A6104). which runs between the A664 and A576 in the Higher Blackley district of north Manchester, approximately 5 miles away from the city centre and a short drive away from the M60/M62/M66. An excellent range of amenities can be found locally including shops, schools, banks, supermarkets, whilst North Manchester General Hospital and Heaton Park are just a short distance away. The Bowker Vale Mertilink station can be a found 5 minutes walk



- Entrance Hall 14'0"*5'10" (4.27*1.8)
- Lounge 10'4"*12'10" (3.154*3.92)
- Living room 22'11"*10'7" (7*3.25)
- Kitchen/Diner 19'0"*7'4" (5.8*2.25)
- Landing 7'5"*7'5" (2.27*2.27)
- Bedroom 1 10'6"*11'4" (3.22*3.476)
- Bedroom 2 10'5"*11'7" (3.2*3.55)
- Bathroom 7'4"*7'5" (2.25*2.27)

Area Map



Floor Plans

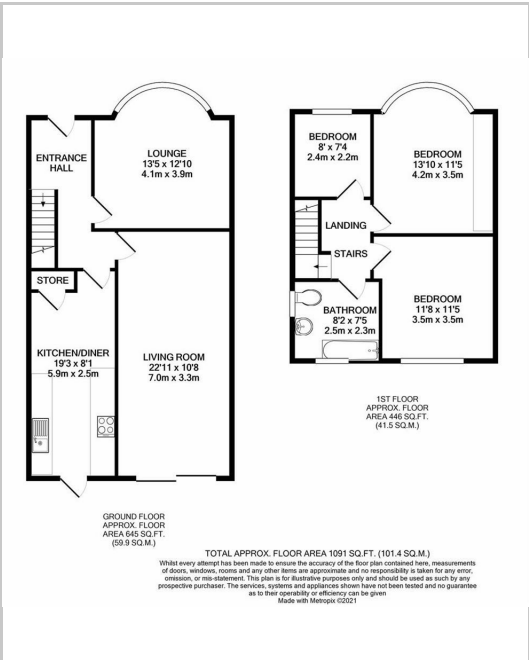

Energy Efficiency Graph

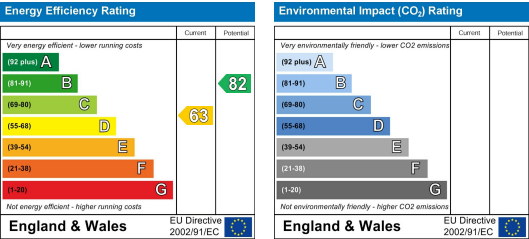

These particulars, whilst believed to be accurate are set out as a general outline only for guidance and do not constitute any part of an offer or contract. Intending purchasers should not rely on them as statements of representation of fact, but must satisfy themselves by inspection or otherwise as to their accuracy. No person in this firms employment has the authority to make or give any representation or warranty in respect of the property.

