



HUNTERS[®]
HERE TO GET *you* THERE

95 Leighton Road, Wing, Leighton Buzzard, LU7 0ND

95 Leighton Road, Wing, Leighton Buzzard, LU7 0ND

Guide Price £300,000

- THREE BEDROOM MID TERRACE
- SUBSTANTIAL REAR GARDEN
- KITCHEN/DINING ROOM
- FIRST FLOOR CLOAKROOM
- NO ONWARD CHAIN
- VILLAGE LOCATION
- CLOSE TO LOCAL AMENITIES and TRANSPORT
- INTERACTIVE VIRTUAL TOUR

Hunters are delighted to market this three bedroom terraced family home, located within the Buckinghamshire village of Wing and offered with NO ONWARD CHAIN.

In brief this property comprises; entrance porch, lounge, kitchen/dining room, bathroom and three bedrooms, plus a first floor cloakroom. Externally this property benefits from a substantial rear garden.

The property benefits from excellent transport links by road and rail, being close to the mainline railway station with access into London Euston, and major road routes running north and south. There are well regarded schools within walking distance of the property.

Don't miss out on the opportunity to make this house your home. Contact us today to arrange a viewing and start envisioning the endless possibilities that this property has to offer.

Hunters Leighton Buzzard 11 Bridge Street, Leighton Buzzard, LU7 1AH | 01525 300899
leightonbuzzard@hunters.com | www.hunters.com

GROUND FLOOR
409 sq.ft. (38.0 sq.m.) approx.

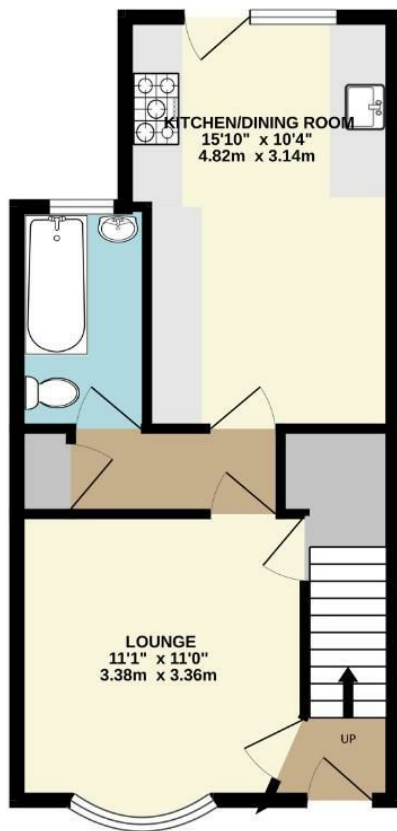

1ST FLOOR
374 sq.ft. (34.7 sq.m.) approx.

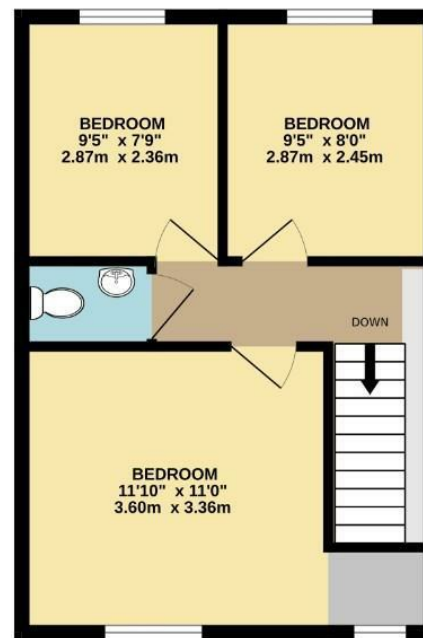

TOTAL FLOOR AREA : 782 sq.ft. (72.7 sq.m.) approx.

Whilst every attempt has been made to ensure the accuracy of the floorplan contained here, measurements of doors, windows, rooms and any other items are approximate and no responsibility is taken for any error, omission or mis-statement. This plan is for illustrative purposes only and should be used as such by any prospective purchaser. The services, systems and appliances shown have not been tested and no guarantee as to their operability or efficiency can be given.
Made with Metropax ©2024.

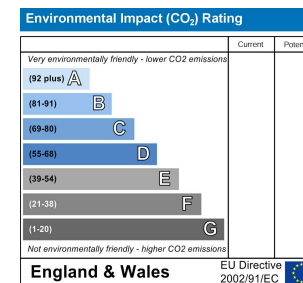
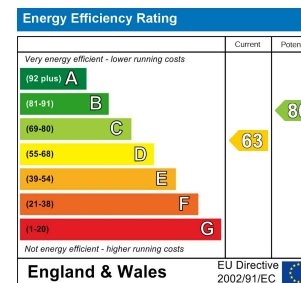

Entrance

Entry via a part glazed door. Fitted carpet and stairs rising to the first floor landing.

Lounge

Double glazed bay window to front aspect. Wood effect flooring and radiator. Storage cupboard.

Inner Hallway

Storage cupboard. Wood effect flooring.

Kitchen/Dining Room

Double glazed window to rear aspect. A range of floor and wall mounted units consisting of cupboards and drawers with a worktop over. Gas range cooker with an extractor over. Plumbing for a washing machine and space for a fridge, freezer and tumble dryer. Wall mounted gas boiler. Tiled flooring and radiator.

Bathroom

Double glazed window to rear aspect. Three piece suite comprising; bathtub, W/C and wash hand basin. Wood effect flooring and radiator.

Landing

Fitted carpet.

Bedroom One

Double glazed window to front aspect. Fitted carpet and radiator. Storage cupboard.

Bedroom Two

Double glazed window to rear aspect. Fitted carpet and radiator.

Bedroom Three

Double glazed window to rear aspect. Wood effect flooring and radiator.

First Floor Cloakroom

Two piece suite comprising; W/C and wash hand basin.

Front

Front garden. Mainly laid to lawn with a path leading to the front door and side gated access.

Rear

Enclosed rear garden. Mainly laid to lawn with a patio seating area. Side gated access.

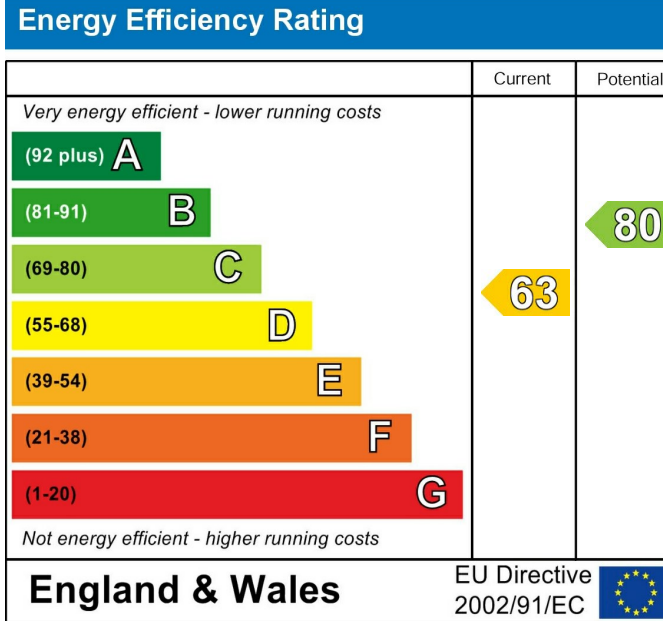

These particulars are intended to give a fair and reliable description of the property but no responsibility for any inaccuracy or error can be accepted and do not constitute an offer or contract. We have not tested any services or appliances (including central heating if fitted) referred to in these particulars and the purchasers are advised to satisfy themselves as to the working order and condition. If a property is unoccupied at any time there may be reconnection charges for any switched off/disconnected or drained services or appliances - All measurements are approximate. If you are thinking of selling your home or just curious to discover the value of your property, Hunters would be pleased to provide free, no obligation sales and marketing advice. Even if your home is outside the area covered by our local offices we can arrange a Market Appraisal through our national network of Hunters estate agents.





