



Brownspring Drive, New Eltham, SE9

Guide Price £650,000

🛏️ 4 🚗 3 🚗 1



- Potential Chain Free Purchase
- Four Bedrooms - Double Aspect Master Bedroom With En Suite
- Substantially Large Well Maintained Front & Back Gardens
- Within A Stones Throw Of Both New Eltham & Chislehurst
- EPC Rating D - Potential C
- Generous Corner Plot Semi-Detached House
- Off Street Parking For Up To 4 Vehicles & Double Length Garage
- Close Proximity To Highly Regarded Schools & Nurseries
- Excellent Transport Links Nearby
- Council Tax Band E - Royal Borough Of Greenwich



***** GUIDE PRICE £650,000 - £675,000 *****

Introducing a Rare Opportunity for Your Dream Home On The Ever Popular Brownspring Drive! Bordering Chislehurst, this exceptional four-bedroom semi-detached corner plot house awaits you. With an array of features that cater to both comfort and potential, Brownspring Drive is the embodiment of modern family living.

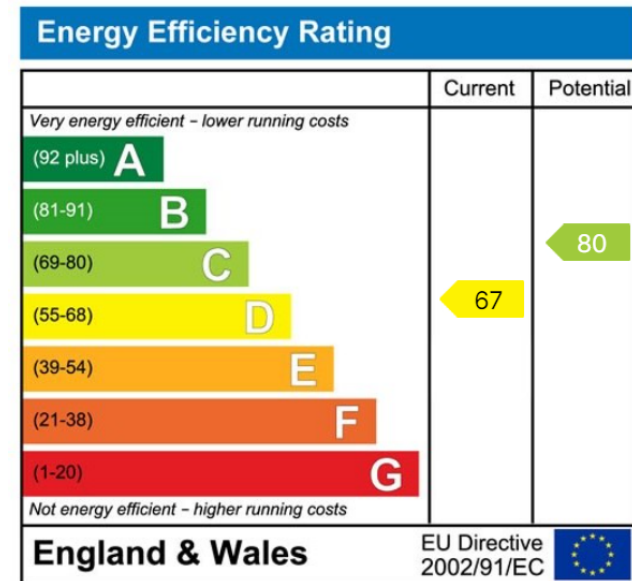
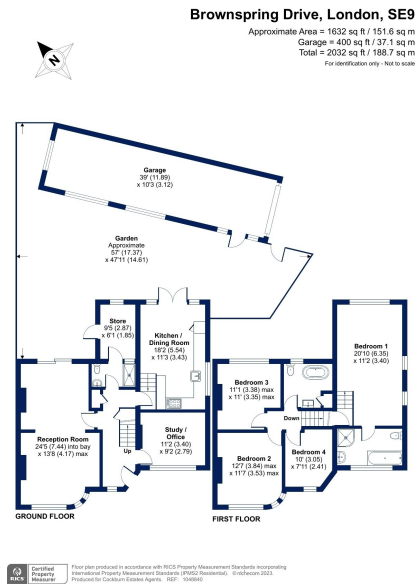

Cockburn EA
 352 Footscray Road,
 London, SE9 2EB
 t: 020 8859 8590