



ESTATE AGENTS
**LAWSON
ROSE**

FOR SALE
£240,000
65 Alverstone Road,
Southsea, PO4 8RP.

ESTATE AGENTS
**LAWSON
ROSE**

GROUND FLOOR

1ST FLOOR

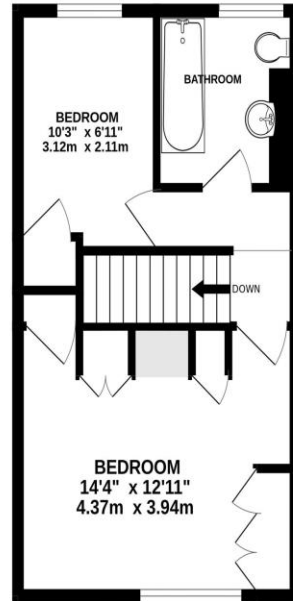
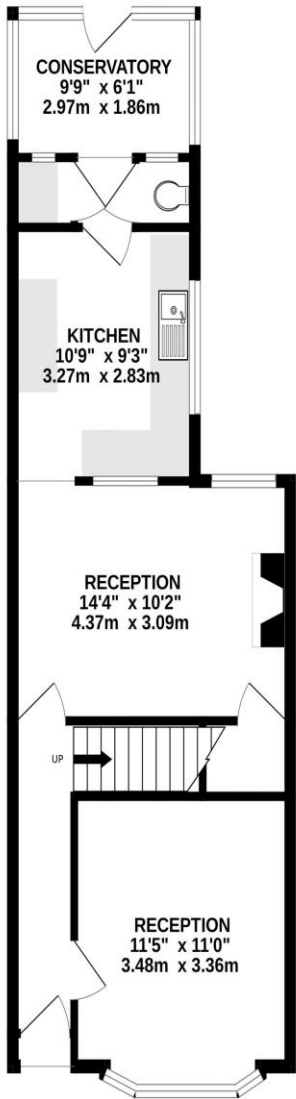

Score	Energy rating	Current	Potential
92+	A		
81-91	B		82 B
69-80	C		
55-68	D		
39-54	E	53 E	
21-38	F		
1-20	G		

Whilst every attempt has been made to ensure the accuracy of the floorplan contained here, measurements of doors, windows, rooms and any other items are approximate and no responsibility is taken for any error, omission or mis-statement. This plan is for illustrative purposes only and should be used as such by any prospective purchaser. The services, systems and appliances shown have not been tested and no guarantee as to their operability or efficiency can be given.
Made with Metropix ©2023

£240,000

**65 Alverstone Road,
Southsea**

This two bedroom, bay & forecourt property has a garage to its rear and its being offered with no forward chain! Situated on Alverstone Road, Southsea, the accommodation provides two separate reception rooms, a fitted kitchen, downstairs W.C and larder plus a rear conservatory that overlooks the west facing garden. The first floor then provides the two bedrooms, both of which have built in wardrobes, plus a fitted upstairs bathroom suite. Additionally the house is majority double glazed, gas centrally heated, plus it has the huge benefit of a sizeable rear garage, accessed via Specks Lane. For further details or to request a viewing, please contact the Lawson Rose sales team who will be happy to assist.

Services

Electricity, gas, mains water and mains drainage are available. Please note that none of the services or appliances have been tested by Lawson Rose.

Council Tax - Band B



02392 367 779 - contactus@lawsonrose.com

131 Winter Road, Southsea, P04 8DS



