



**FOR SALE**  
**Offers in Excess of £250,000**  
1C Highgrove Road,  
Portsmouth, PO3 6PP.

ESTATE AGENTS  
**LAWSON  
ROSE**

ESTATE  AGENTS

**LAWSON  
ROSE**

GROUND FLOOR

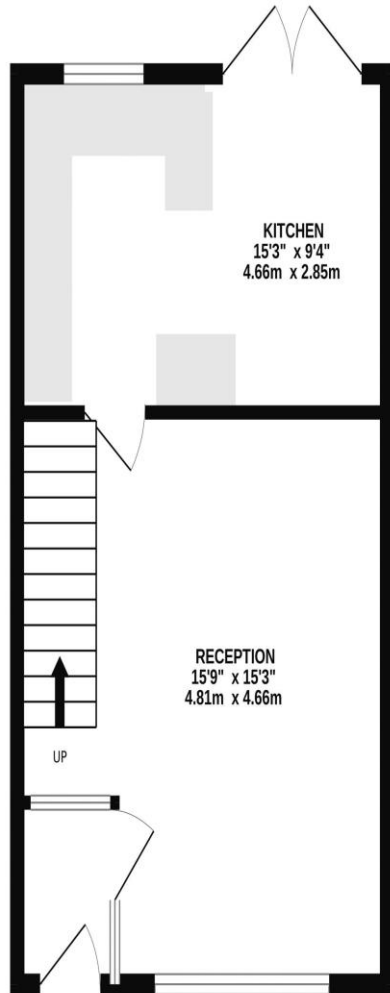

1ST FLOOR

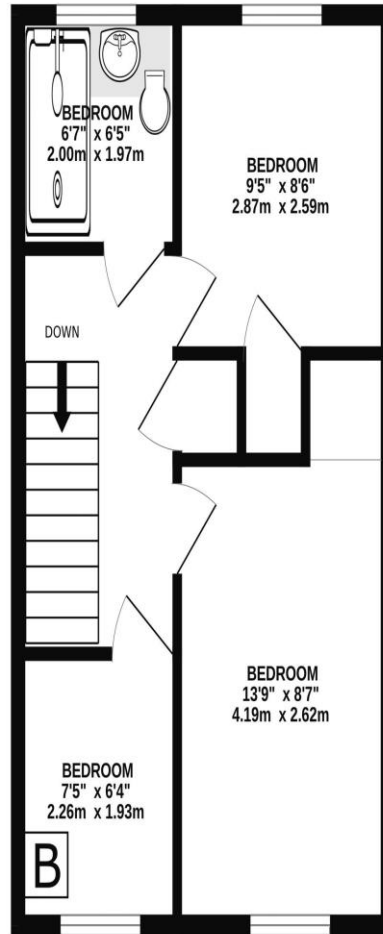

# Offers in Excess of £250,000

## 1C Highgrove Road, Portsmouth

This three bedroom terraced property has a garage and its being offered with no forward chain! Situated on Highgrove Road, not far from local amenities and Baffins pond, the property provides a spacious open living and fitted kitchen with double doors opening into the rear west facing garden. The first floor then provides the three bedrooms, two of which have built in wardrobes, plus a fitted shower room. Additionally the house is double glazed and gas centrally heated, plus there is rear pedestrian access from the garden to its garage, situated in a block to the properties rear.

For further information or to enquire on viewing arrangements, please contact the Lawson Rose sales team today.

### Services

Electricity, gas, mains water and mains drainage are available. Please note that none of the services or appliances have been tested by Lawson Rose.

### Council Tax - Band C



**02392 367 779 - [contactus@lawsonrose.com](mailto:contactus@lawsonrose.com)**  
**131 Winter Road, Southsea, P04 8DS**

Whilst every attempt has been made to ensure the accuracy of the floorplan contained here of doors, windows, rooms and any other items are approximate and no responsibility is taken for omission or mis-statement. This plan is for illustrative purposes only and should be used by prospective purchaser. The services, systems and appliances shown have not been tested as to their operability or efficiency can be given.  
 Made with Metropix ©2023







