



Grenadiers Drive, Chatteris, PE16 6TW

Mid Terraced House - 2 Bedrooms - Kitchen & Lounge/Diner - First Floor Shower Room - Enclosed Low Maintenance Rear Garden - Allocated Parking - Call To View (01354) 696700

£180,000



Ground Floor

Entrance Hall
Double glazed door and window to front, radiator, laminate flooring and stairs to first floor.

Kitchen
3.04m (10') x 1.80m (5'11")
Fitted with a matching range of base and eye level units with worktop space over, built in gas hob with extractor hood over and oven, 1+1/2 bowl stainless steel sink, plumbing for washing machine, space for fridge/freezer, radiator, laminate flooring and double-glazed window to front.

Lounge/Diner
4.06m (13'4") x 3.81m (12'6")
Double glazed window to rear and double doors to rear, under stairs storage cupboard, radiator, laminate flooring and coving to ceiling.

First Floor

Landing
Storage cupboard.

Bedroom 1
3.66m (12'0") x 3.80m (12'4")
Two double glazed windows to front, fitted carpet and radiator.

Bedroom 2
3.48m (11'5") x 2.03m (6'6")
Double glazed window to rear, fitted carpet and radiator.

Shower Room
Fitted with three-piece suite comprising walk in double shower cubicle with splashback, pedestal wash hand basin and low-level WC, tiled flooring and double-glazed window to rear.

Outside

There is a low maintenance enclosed rear garden, comprising of shingle and patio and a timber built shed.
The property also offers one allocated parking space.

EPC Rating: C

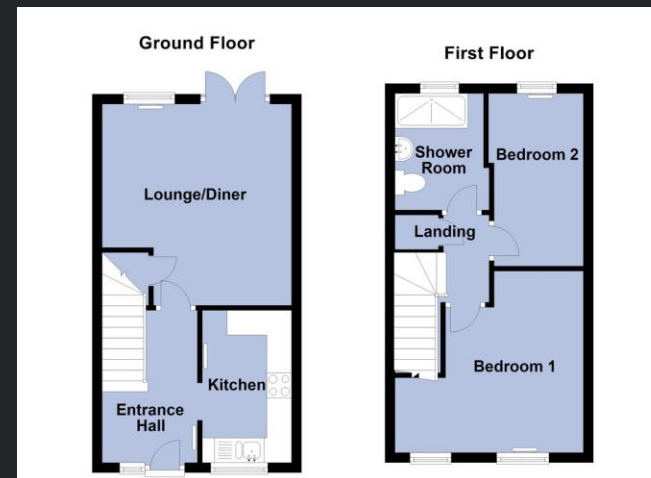

Call to arrange a viewing **01354 696700**

T Payne & Co
SALES & LETTINGS

Agents Notes: Whilst every care has been taken to prepare these sales particulars, they are for guidance purposes only. All measurements are approximate and for general guidance purposes only and whilst every care has been taken to ensure their accuracy, they should not be relied upon and potential buyers are advised to recheck the measurements.