



Silver Street, Witcham, Ely, CB6 2LF

Village Location - Detached Bungalow - 2 Double Bedrooms - Refitted Kitchen & Shower Room - Lounge - Enclosed Rear Garden - Driveway & Garage - No Upward Chain - Call To View (01354) 696700

£285,000



Entrance Hall

Entrance door, radiator, storage cupboard and door to:

Kitchen

3.17m (10'5") x 3.03m (9'11") max
Fitted with a matching range of base and eye level units with worktop space over, hob with extractor hood over and oven, 1+1/2 bowl sink with tiled splashbacks, integrated fridge/freezer, plumbing for washing machine, tiled flooring and double-glazed window to front.

Lounge

4.69m (15'5") x 3.61m (11'10")
Box window to front, fitted carpet, fireplace and radiator.

Bedroom 1

3.74m (12'3") x 3.17m (10'5")
Double glazed window to rear, fitted carpet and radiator.

Bedroom 2

3.75m (12'4") x 2.61m (8'7")
Double glazed window to rear, fitted carpet and radiator.

Shower Room

Fitted with three-piece suite comprising shower enclosure, vanity wash hand basin and WC, tiled walls, tiled flooring and double-glazed window to rear.

Garage

Electric garage door to front, window and door to side.

Outside

The property has a driveway to the front, leading to the garage. There is also an enclosed rear garden which is mainly laid to lawn with a patio area.

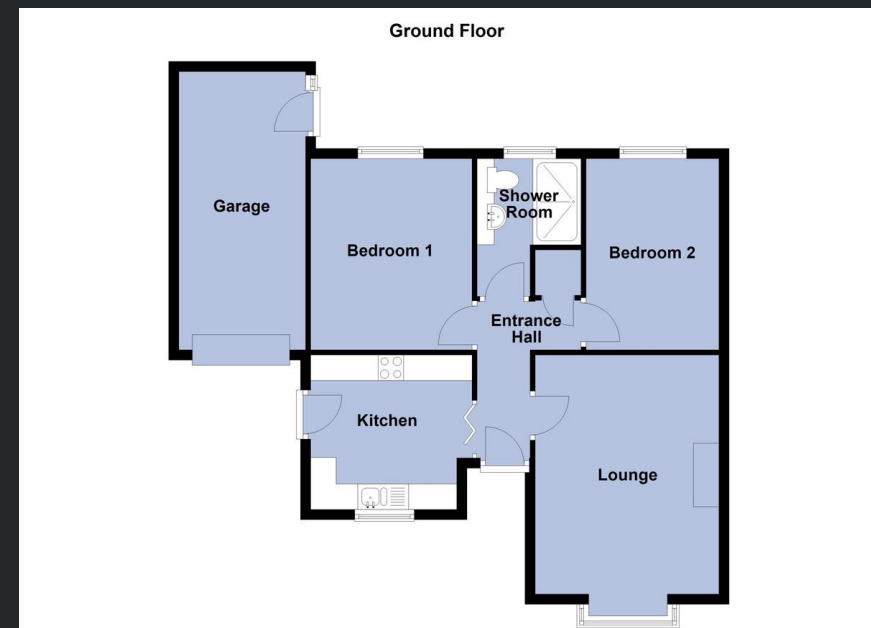

Call to arrange a viewing **01354 696700**

T Payne & Co
SALES & LETTINGS

Agents Notes: Whilst every care has been taken to prepare these sales particulars, they are for guidance purposes only. All measurements are approximate and for general guidance purposes only and whilst every care has been taken to ensure their accuracy, they should not be relied upon and potential buyers are advised to recheck the measurements.