



Lindsells Walk, Chatteris, Cambs, PE16 6PW

Close To Town Centre - Ground Floor Flat - 1 Bedroom - Kitchen - Lounge - Bathroom - Allocated Parking - Call To View - (01354) 696700

£110,000



Ground Floor

Hallway

Built in storage cupboard and radiator.

Lounge

4.24m (13'9") x 3.62m (11'8")
Window to side, radiator and fitted carpet.

Kitchen

3.86m (12'6") x 2.08m (6'8")
Fitted with a matching base and eye level units with worktop space over, stainless steel sink with tiled splashbacks, plumbing for washing machine, space for fridge/freezer, built-in electric oven, built-in gas hob, window to side, window to front, radiator and tiled flooring.

Bedroom

3.88m (12'7") x 2.93m (9'6") max
Window to front, built in wardrobes, radiator and fitted carpet.

Bathroom

Fitted with three-piece suite comprising panelled bath, wash hand basin and WC, tiled surround, heated towel rail and tiled flooring.

Outside

There is allocated and communal bin area.

EPC Rating - C

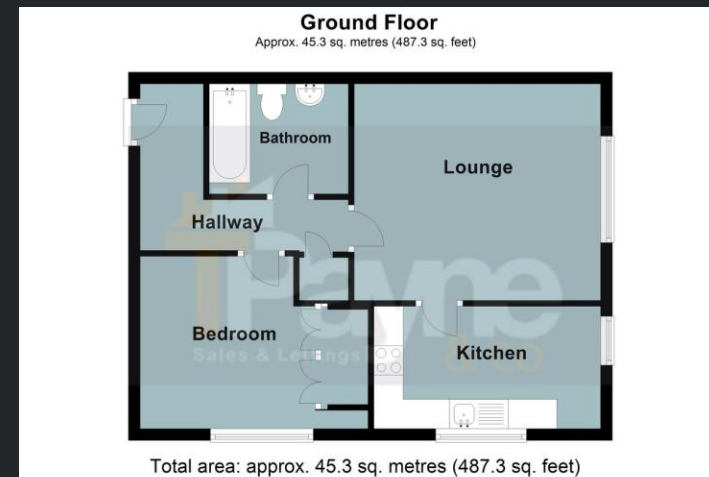

Call to arrange a viewing 01354 696700 **T Payne & Co**
SALES & LETTINGS

Agents Notes: Whilst every care has been taken to prepare these sales particulars, they are for guidance purposes only. All measurements are approximate and for general guidance purposes only and whilst every care has been taken to ensure their accuracy, they should not be relied upon and potential buyers are advised to recheck the measurements.