

Total area: approx. 213.6 sq. metres (2298.7 sq. feet)  
 Plans are for representational purposes only  
 Plans produced using Planity

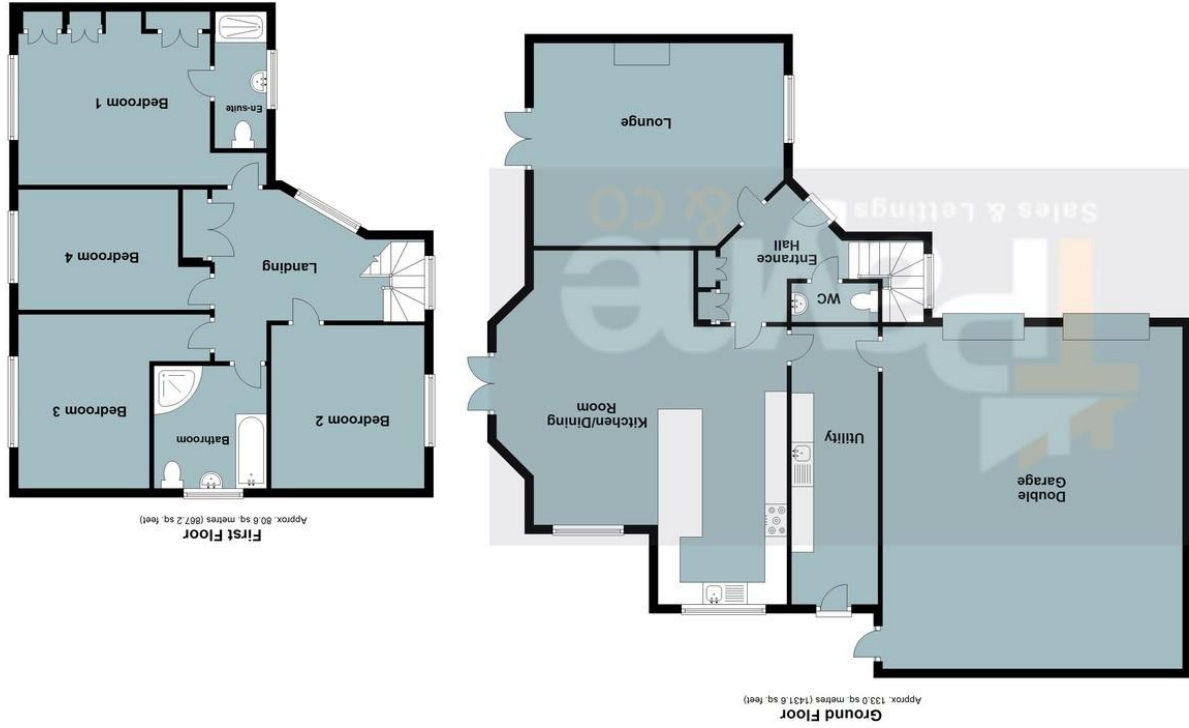

Ground floor

First floor

**TPayne & Co**  
 SALES & LETTINGS

Chatters Office  
 6 High Street, Chatters PE16 6BE  
 Wisbech Office  
 The Boatouse, Harbour Square, Wisbech PE13 3BH  
 01354 696700 info@tpayneandco.co.uk  
 www.tpayneandco.co.uk

**TPayne & Co**  
 SALES & LETTINGS

01354 696700 info@tpayneandco.co.uk



**Hermitage Gardens, March, Cambs, PE15 0WL**

Exclusive Gated Development - Field Views To Side & Rear - Detached House - Immaculately Presented - Popular Village Location - 4 Double Bedrooms - Kitchen/Dining Room & Utility - Lounge - Ground Floor WC, First Floor Bathroom & En Suite - Enclosed Rear Garden - Driveway - Viewings Recommended (01354) 696700

**£600,000**





**Ground Floor**

**Entrance Hall**

Window to side, two built in storage cupboards, tiled under floor heating and stairs leading to the first floor.

**Lounge**

5.66m (18'5") x 4.58m (15') Window to side, log burner with built in surround, under floor heating and double doors leading to the garden.

**Kitchen/Dining Room**

7.18m (23'5") x 6.20m (20'3") MAX Fitted with a matching base and eye level units with quartz worktop space over, composite sink, built-in dishwasher, two built in ovens, built-in five ring gas hob, built in double bin, wine cooler two windows to rear, tiled flooring with under floor heating. (all appliances are NEFF)

**Utility**

5.09m (16'6") x 1.96m (6'4") Fitted with a matching base and eye level units with worktop space over, composite sink, plumbing for washing machine, space for fridge/freezer and tumble dryer, radiator and tiled flooring.

**WC**

Fitted with two piece suite comprising, wash hand basin and low-level WC, tiled splashbacks, heated towel rail, tiled flooring with under floor heating.

**First Floor**

**Landing**

Window to front, window to side, built in storage cupboard and fitted carpet.

**Bedroom 1**

5.64m (18'5") x 3.64m (11'9") Window to side, three built in wardrobes with double doors, radiator and door to;

**En-suite**

Fitted with three piece suite comprising wash hand basin, shower cubicle and low-level WC, part tiled walls, window to side, heated towel rail and tiled flooring.

**Bedroom 2**

3.47m (11'3") x 3.44m (11'2") Window to side, radiator and fitted carpet.

**Bedroom 3 4**

4.34m (14'2") x 3.93m (12'8") Max Window to side, radiator and fitted carpet.

**Bedroom 4**

4.34m (14'2") x 2.72m (8'9") Max Window to side, radiator and fitted carpet.

**Bathroom**

Fitted with four piece suite with panelled bath, wash hand basin, shower cubicle and low-level WC, part tiled walls, window to rear, radiator and tiled flooring.



**T Payne & Co**  
SALES & LETTINGS



**Outside**

The property is situated down a private road with a gated entrance, there are field views to both side and rear. To the front is a block weave drive and entrance to the double garage. A side gate allows access to an enclosed rear garden comprising lawn, patio, shrub borders a timber built shed and a pergola, great space for socialising. There are also fitted solar panels to the rear with storage battery located in the garage.

**Double Garage**

Two manual up and over doors, connected with power and lighting and external door leading to the garden.

EPC- TBC



**T Payne & Co**  
SALES & LETTINGS