



1a Ash Grove, Chatteris, Cambs, PE16 6NL

Close To The Town Centre - Modern Build - Mid Terraced House - 2 Bedrooms - Open Plan Kitchen & Lounge -
Ground Floor WC - First Floor Bathroom - Viewings Recommended (01354) 696700

£160,000



Ground Floor

Kitchen Area

3.72m (12'2") x 2.44m (8')
 Fitted with a matching range of base and eye level units with worktop space over with underlighting, electric hob with extractor hood over and oven, stainless steel sink, built-in fridge/freezer, slimline dishwasher and washing machine, radiator, vinyl flooring, two double glazed windows to side, one double glazed window and door to front.

Lounge Area

3.72m (12'2") x 2.46m (8'1")
 Double glazed window to front, radiator and stairs to first floor.

WC

Fitted with two-piece suite comprising, pedestal wash hand basin with splashback, WC with hidden cistern, extractor fan, radiator and vinyl flooring.

First Floor

Bedroom 1

3.73m (12'2") max x 2.68m (8'10")
 Double glazed window to front and radiator.

Bedroom 2

3.68m (12'1") x 2.11m (6'9")
 Double glazed window to front, two double glazed windows to side and radiator.

Bathroom

Fitted with three-piece suite comprising bath with hand shower attachment over and glass screen, pedestal wash hand basin and low-level WC, extractor fan, heated towel rail and vinyl flooring.

EPC Rating: B

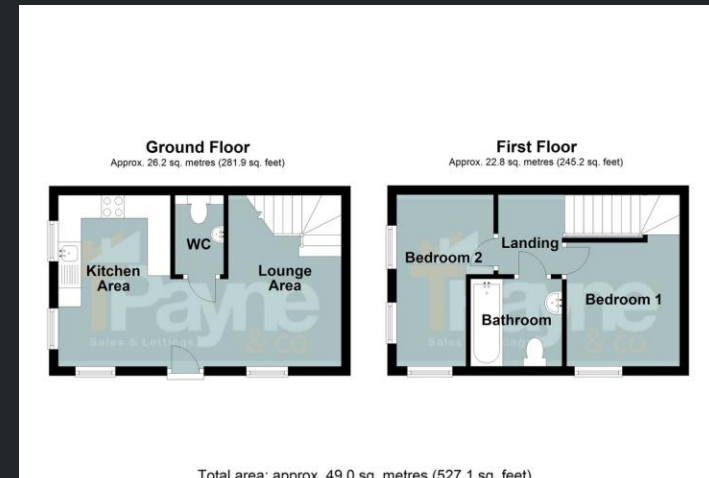

Call to arrange a viewing **01354 696700** **T Payne & Co**
 SALES & LETTINGS

Agents Notes: Whilst every care has been taken to prepare these sales particulars, they are for guidance purposes only. All measurements are approximate and for general guidance purposes only and whilst every care has been taken to ensure their accuracy, they should not be relied upon and potential buyers are advised to recheck the measurements.