



Cowley Road, SW14

£2,250 Per calendar month

Well presented two bedroom ground floor Edwardian purpose built maisonette situated in one of the most sought after roads in Mortlake. The property benefits from spacious lounge, dining room, separate kitchen, bathroom and shared garden.

Cowley Road is perpendicular to Mortlake High Street, close to the river Thames and Barnes Bridge station with its frequent services to Waterloo. If you enjoy good food and drink, Rick Stein, Barnes is at the end of the road.

Features

- Two Bedrooms
- Edwardian Maisonette
- Modern Kitchen
- Modern Bathroom
- Wooden Floors
- Shared Garden

Cowley Road, London, SW14

Ground Floor

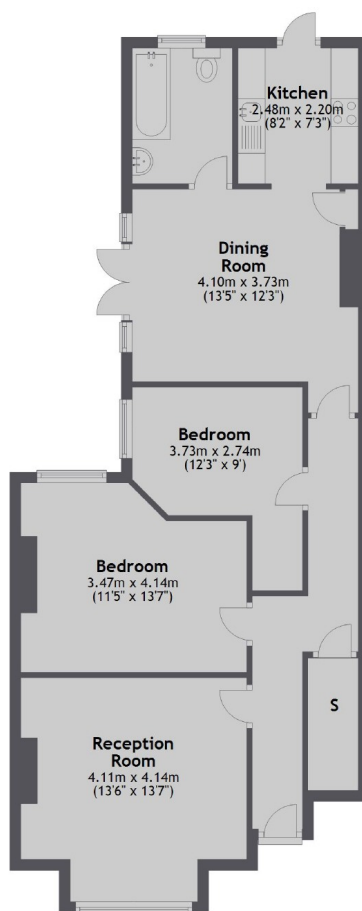

Total area: approx. 75.2 sq. metres (809.6 sq. feet)