



Thompson Avenue, TW9

£4,950 Per calendar month

A newly built four bedroom home located in a quiet residential street. The property has been finished to the highest of standards with an open plan kitchen living room, large garden, four bedrooms and three bathrooms. The property also benefits from solar panels, making it super energy efficient.

Thompson Avenue is ideally located for Richmond Park and Royal Botanic Gardens Kew. The commuter is equally well catered for with Richmond, Kew Gardens and North Sheen stations close to hand with additional excellent bus services to Central London.

Features

- Four Bedrooms
- Three Bathrooms
- Solar Panels
- Fully Renovated
- Extended Kitchen/Dining Room
- Large Rear Garden

Thompson Avenue, Kew, TW9

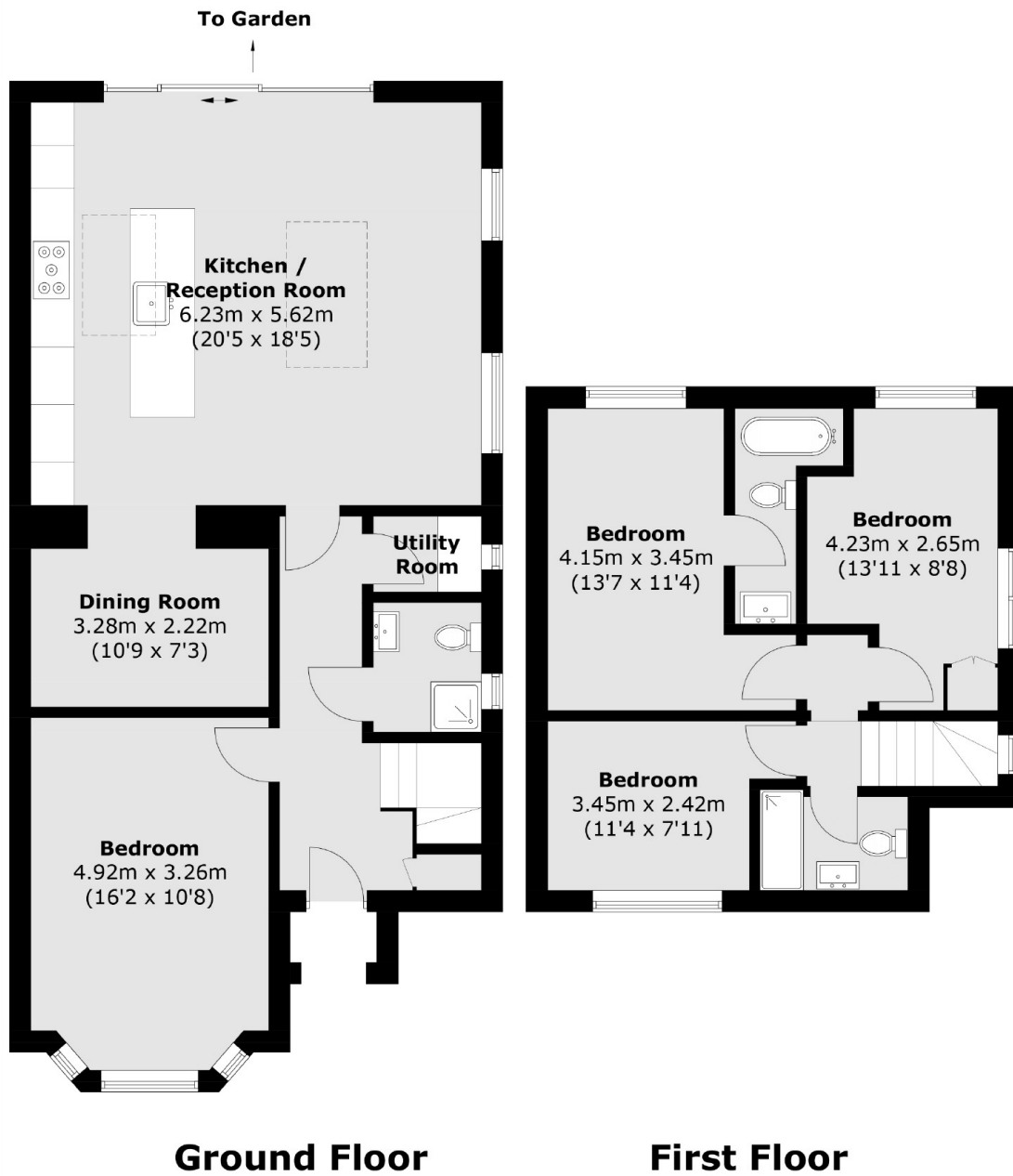

Total area (approx.): 116.8 sq. m (1,257.2 sq. ft)