



Kent Road, TW9

£2,400 Per calendar month

A refurbished two bedroom apartment in a popular purpose built block which has a reception leading on to a private balcony, communal gardens and private parking.

Kent Road is situated off the Mortlake Road close to Kew Gardens station, Kew Village and Kew Retail Park which has a fantastic variety of shops.

Features

- Two Bedrooms
- Good Condition
- Unfurnished
- Communal Gardens
- Private Parking
- Great Location

Kent Road, Kew, TW9

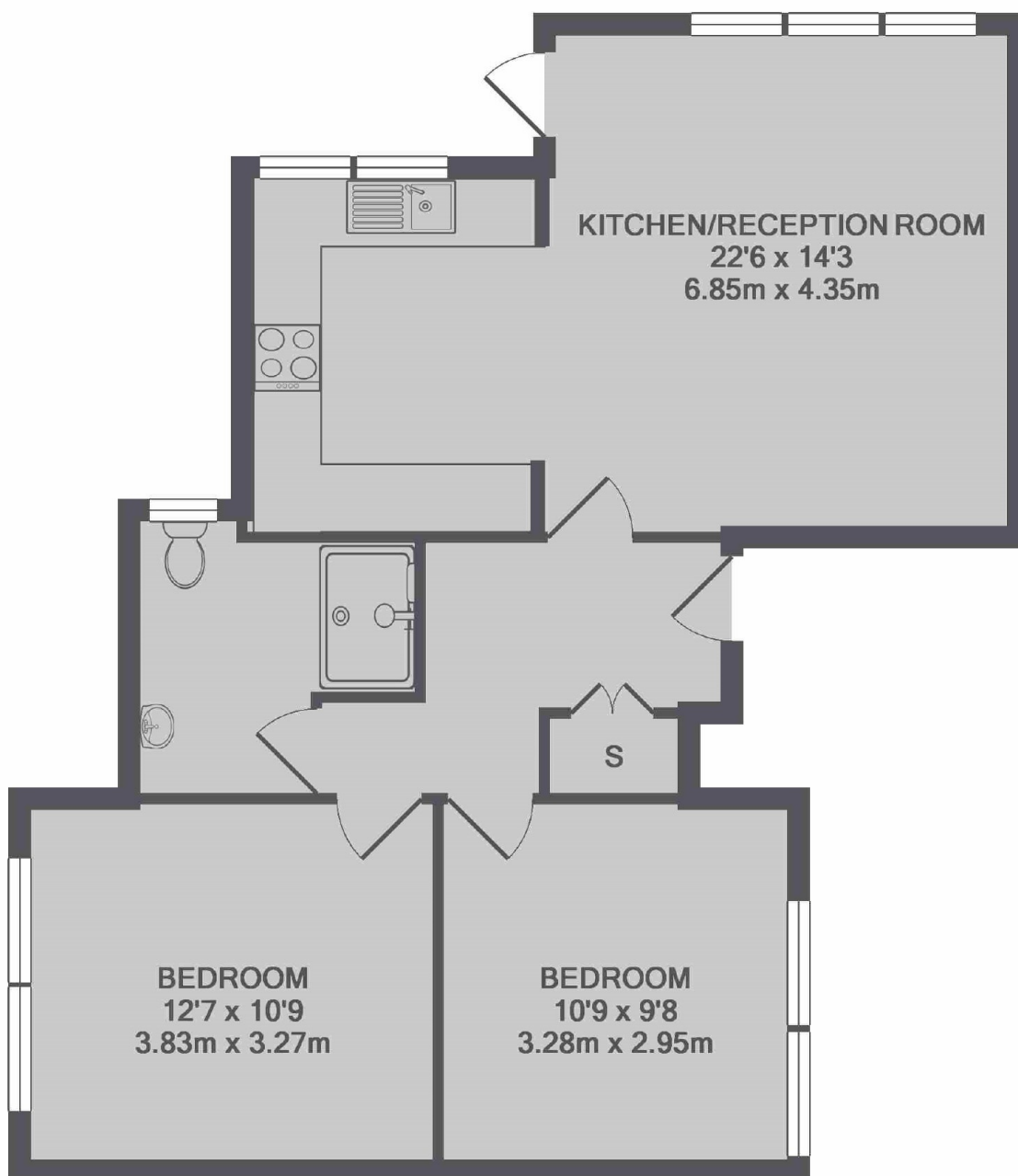

TOTAL APPROX. FLOOR AREA 678 SQ.FT. (63.0 SQ.M.)