



Malting Lane, Dagnall Berkhamsted HP4 1QY



Accommodation on the ground floor comprises an entrance hallway, cloakroom and main family living area. Further accommodation includes an office and useful snug room. The fitted kitchen has ample storage and counter top space for family living. Moving upstairs to the first floor accommodation there are three spacious bedrooms all served by the main family bathroom. The bedrooms offer stunning views over the countryside. Externally the property offers a beautiful Cottage feel family gardens, a detached workshop with power and lighting and separate utility room.

Dagnall is conveniently located within a short driving distance of Berkhamsted, Hemel Hempstead and Dunstable as well as nearby attractions of Whipsnade Zoo, Ashridge House and Dunstable Downs. There is also a local convenience shop located in the village as well as many weekly activities and clubs hosted at the local Village Hall.





welcome to
Malting Lane, Dagnall
BERKHAMSTED

- Village Location
- Three Bedrooms
- Family Home
- Workshop
- Downstairs Cloakroom

Tenure: Freehold EPC Rating: F

Situated in the desirable and quaint village of Dagnall, this charming 1880s three bedroom Semi-detached family home offers a wealth of Character and charm.

Malting Lane, Dagnall, Berkhamsted, HP4

Approximate Area = 1164 sq ft / 108.1 sq m
Outbuildings = 222 sq ft / 20.6 sq m
Total = 1386 sq ft / 128.7 sq m
For identification only - Not to scale

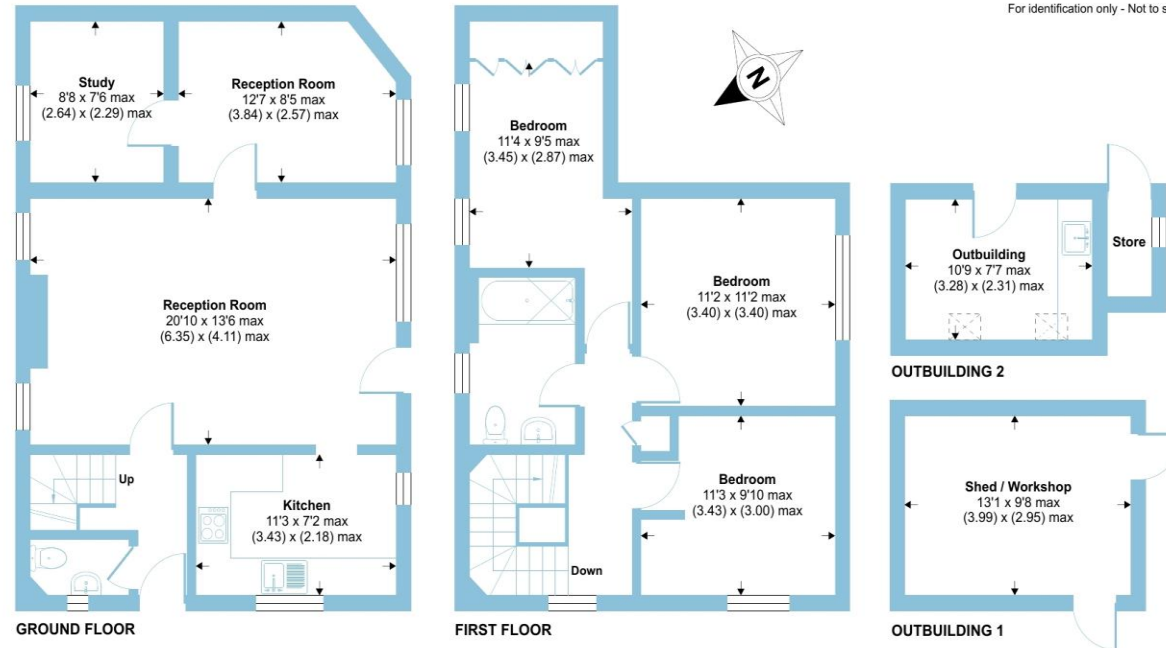

Price
£550,000

check out more properties at [brownandmerry.co.uk](https://www.brownandmerry.co.uk)
see all our properties on [zoopla.co.uk](https://www.zoopla.co.uk) | [rightmove.co.uk](https://www.rightmove.co.uk) | [sequencehome.co.uk](https://www.sequencehome.co.uk)



Property Reference:
BKH102651- 0003

1. MONEY LAUNDERING REGULATIONS Intending purchasers will be asked to produce identification documentation at a later stage and we would ask for your co-operation in order that there is no delay in agreeing the sale. 2. These particulars do not constitute part or all of an offer or contract. 3. The measurements indicated are supplied for guidance only and as such must be considered incorrect. Potential buyers are advised to recheck measurements before committing to any expense. 4. We have not tested any apparatus, equipment, fixtures or services and it is in the buyers interest to check the working condition of any appliances. 5. Where an EPC, or a Home Report (Scotland only) is held for this property, it is available for inspection at the branch by appointment. If you require a printed version of a Home Report, you will need to pay a reasonable production charge reflecting printing and other costs. 6. We are not able to offer an opinion either written or verbal on the content of these reports and this must be obtained from your legal representative. 7. Whilst we take care in preparing these reports, a buyer should ensure that his/her legal representative confirms as soon as possible all matters relating to title including the extent and boundaries of the property and other important matters before exchange of contracts.



Floor plan produced in accordance with RICS Property Measurement Standards incorporating International Property Measurement Standards (IPMS2 Residential). © nichecom 2023. Produced for Brown & Merry. REF: 1047096



01442 870444



berkhamsted@brownandmerry.co.uk



124 High Street, BERKHAMSTED,
Hertfordshire, HP4 3AT



[brownandmerry.co.uk](https://www.brownandmerry.co.uk)