



Covert Road, Northchurch, Berkhamsted, HP4 3RR



The large kitchen has a range of base and wall units as well as space for a fridge freezer and washing machine. It has an integrated double oven and a gas hob. A patio door provides access onto the garden. The spacious living dining room has double aspect windows which make this a bright and airy space, perfect for relaxing or entertaining. It has the benefit of a gas fire and sliding patio doors which lead out onto the garden. There are two good sized double bedrooms and a family bathroom which comprises of a three piece suite.

The garden is laid to lawn with a colourful, decorative border and stunning views over Northchurch Common. There is a garage to the side of the property, a long driveway and a large front garden which is laid to lawn.





welcome to

Covert Road, Northchurch, BERKHAMSTED

- BUNGALOW
- CLOSE TO AMENITIES
- GARAGE AND DRIVEWAY
- TWO DOUBLE BEDROOMS
- POTENTIAL TO EXTEND (STPP)

Tenure: Freehold EPC Rating: D

A well-presented, two bedroom, semi-detached bungalow located on a peaceful road in Northchurch. This property is a short walk from Northchurch High Street and offers beautiful views across the valley.

Covert Road, Northchurch, Berkhamsted, HP4

Approximate Area = 876 sq ft / 81.3 sq m (includes garage)

For identification only - Not to scale

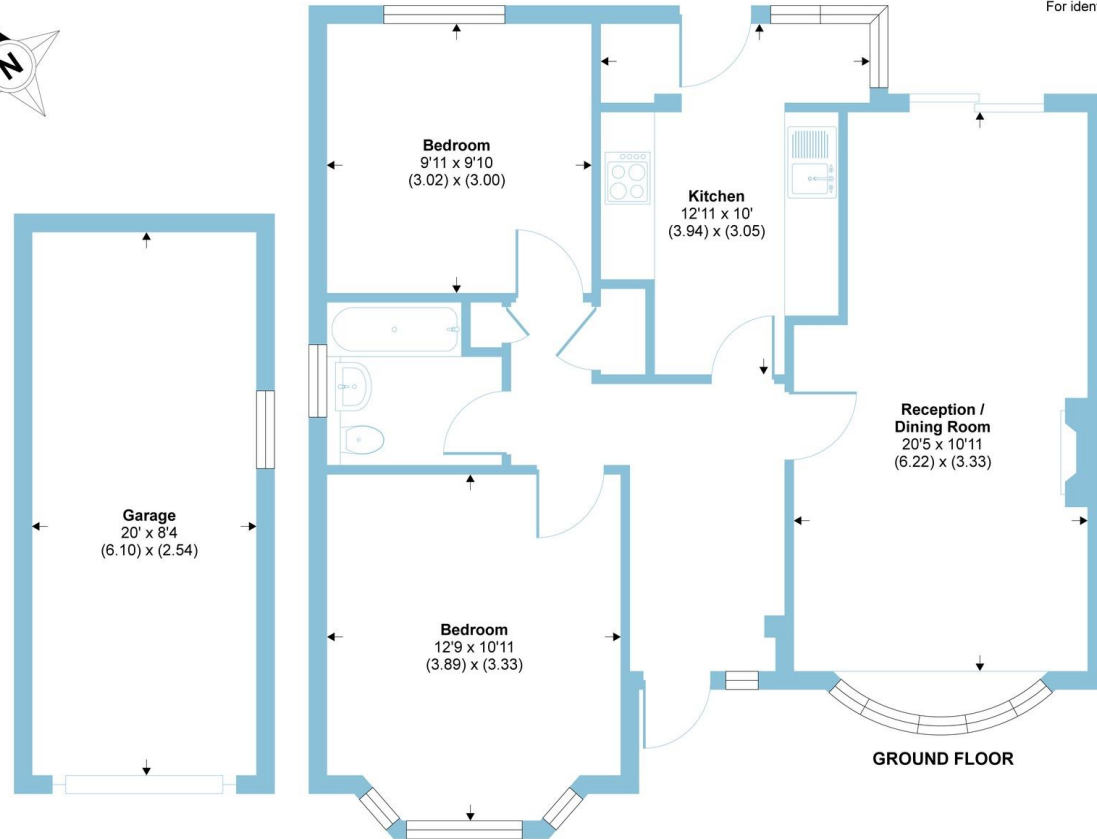

Floor plan produced in accordance with RICS Property Measurement Standards incorporating International Property Measurement Standards (IPMS2 Residential). © nichecom 2021. Produced for Brown & Merry. REF: 742949



Offers over
£475,000

check out more properties at [brownmerry.co.uk](https://www.brownmerry.co.uk)
see all our properties on [zoopla.co.uk](https://www.zoopla.co.uk) | [rightmove.co.uk](https://www.rightmove.co.uk) | [sequencehome.co.uk](https://www.sequencehome.co.uk)



Property Reference:
BKH101991 – 002

1. MONEY LAUNDERING REGULATIONS Intending purchasers will be asked to produce identification documentation at a later stage and we would ask for your co-operation in order that there is no delay in agreeing the sale. 2. These particulars do not constitute part or all of an offer or contract. 3. The measurements indicated are supplied for guidance only and as such must be considered incorrect. Potential buyers are advised to recheck measurements before committing to any expense. 4. We have not tested any apparatus, equipment, fixtures or services and it is in the buyers interest to check the working condition of any appliances. 5. Where an EPC, or a Home Report (Scotland only) is held for this property, it is available for inspection at the branch by appointment. If you require a printed version of a Home Report, you will need to pay a reasonable production charge reflecting printing and other costs. 6. We are not able to offer an opinion either written or verbal on the content of these reports and this must be obtained from your legal representative. 7. Whilst we take care in preparing these reports, a buyer should ensure that his/her legal representative confirms as soon as possible all matters relating to title including the extent and boundaries of the property and other important matters before exchange of contracts.



01442 870444



berkhamsted@brownmerry.co.uk



124 High Street, BERKHAMSTED,
Hertfordshire, HP4 3AT



[brownmerry.co.uk](https://www.brownmerry.co.uk)