



Crabbe Crescent, Chesham HP5 3DD

welcome to

Crabbe Crescent, Chesham

Brown & Merry are delighted to offer to market this three bedroom semi-detached bungalow situated in the Hilltop area of Chesham. With its spacious rooms, driveway parking and garage it offers great family home accommodation within 1.5 miles of the town centre.



Crabbe Crescent

Total floor area 101.7 m² (1,094 sq.ft.) approx

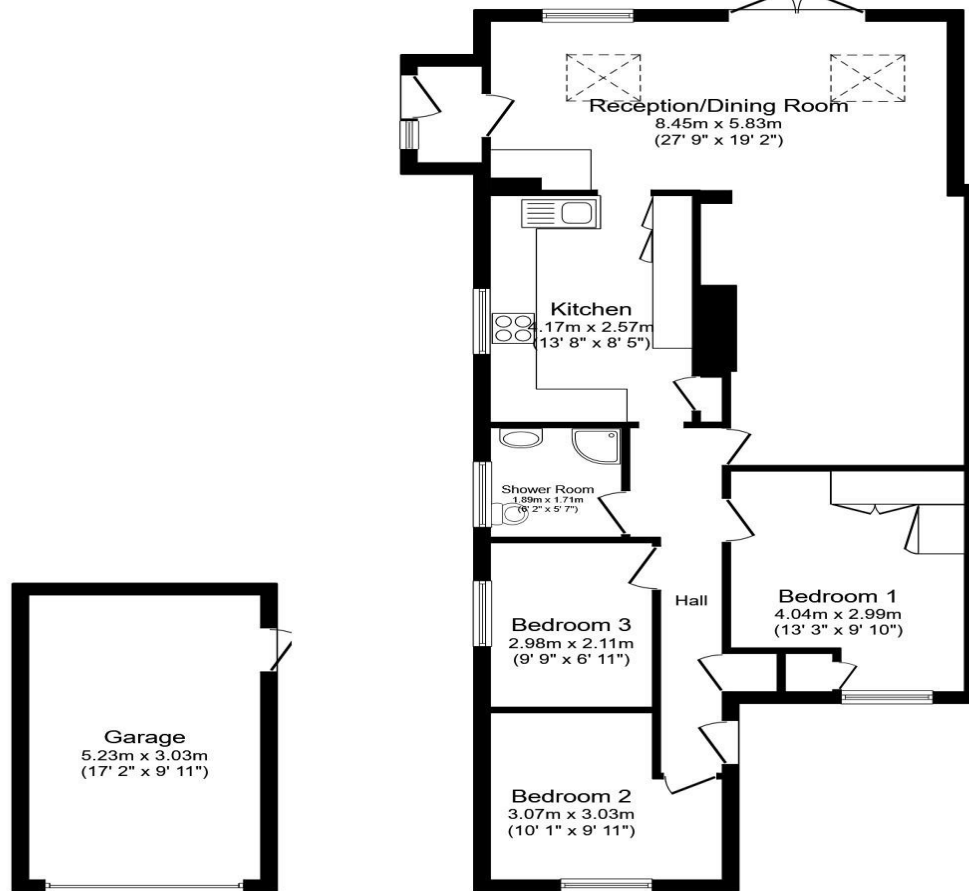

Garage

Floor area 15.6 m² (168 sq.ft.) approx

Floor Plan

Floor area 86.1 m² (927 sq.ft.) approx

Hallway

Kitchen

13' 8" max x 8' 5" max (4.17m max x 2.57m max)

Lounge/Diner

27' 9" max x 19' 2" max (8.46m max x 5.84m max)

Bedroom 1

13' 3" max x 9' 10" max (4.04m max x 3.00m max)

Bedroom 2

10' 1" x 9' 11" (3.07m x 3.02m)

Bedroom 3

9' 9" x 6' 11" (2.97m x 2.11m)

Shower Room

6' 2" x 5' 7" (1.88m x 1.70m)

Contact Telephone...
Contact Address...

This plan is for illustration purposes only and may not be representative of the property. Plan not to scale.

Powered by Focal

welcome to

Crabbe Crescent, Chesham

- SEMI-DETACHED BUNGALOW
- LARGE OPEN PLAN LIVING SPACE
- SPACIOUS KITCHEN
- THREE GOOD SIZED BEDROOMS
- DRIVEWAY PARKING & GARAGE

Tenure: Freehold EPC Rating: C
Council Tax Band: D

£530,000



Please note the marker reflects the
postcode not the actual property

view this property online [brownandmerry.co.uk/Property/CSM103562](https://www.brownandmerry.co.uk/Property/CSM103562)



Property Ref:
CSM103562 - 0002

1. MONEY LAUNDERING REGULATIONS Intending purchasers will be asked to produce identification documentation at a later stage and we would ask for your co-operation in order that there is no delay in agreeing the sale. 2. These particulars do not constitute part or all of an offer or contract. 3. The measurements indicated are supplied for guidance only and as such must be considered incorrect. Potential buyers are advised to recheck measurements before committing to any expense. 4. We have not tested any apparatus, equipment, fixtures or services and it is in the buyers interest to check the working condition of any appliances. 5. Where an EPC, or a Home Report (Scotland only) is held for this property, it is available for inspection at the branch by appointment. If you require a printed version of a Home Report, you will need to pay a reasonable production charge reflecting printing and other costs. 6. We are not able to offer an opinion either written or verbal on the content of these reports and this must be obtained from your legal representative. 7. Whilst we take care in preparing these reports, a buyer should ensure that his/her legal representative confirms as soon as possible all matters relating to title including the extent and boundaries of the property and other important matters before exchange of contracts.

Brown & Merry is a trading name of Sequence (UK) Limited which is registered in England and Wales under company number 4268443, Registered Office is Cumbria House, 16-20 Hockliffe Street, Leighton Buzzard, Bedfordshire, LU7 1GN. VAT Registration Number is 500 2481 05.



brown & merry



01494 775650



chesham@brownandmerry.co.uk



3 Market Square, CHESHAM, Buckinghamshire,
HP5 1HG



[brownandmerry.co.uk](https://www.brownandmerry.co.uk)