



Stoney Grove, Chesham HP5 3BN

welcome to

Stoney Grove, Chesham

Enter the property via the hallway offering space for storing coats and footwear. The kitchen boasts units to three walls and offers a view over the communal parking area. The lounge/diner to the rear of the property gives access to the rear garden via sliding patio doors and stairs to the first floor.

Upstairs you'll find a built in storage cupboard on the landing, two good sized bedrooms; the largest of which has built in storage and the bathroom with full sized bath, wc and basin.

Outside includes communal parking to the front and a terraced rear garden with patio area outside the lounge and lawn and shrubs to the higher levels.

Stoney Grove is situated less than 1 mile from the town centre, underground station and Lowndes park and offers easy access to supermarkets, convenience stores, a public house, restaurants and coffee shops.

Chesham is a market town and civil parish in Buckinghamshire, England. It is 11 miles south-east of the county town of Aylesbury and 25.8 miles north-west of Charing Cross, Central London, and is part of the London commuter belt, the Metropolitan Line. Chesham has easy access to the A41, M1 and M40 motorways.



Stoney Grove

Total floor area 57.8 m² (622 sq.ft.) approx

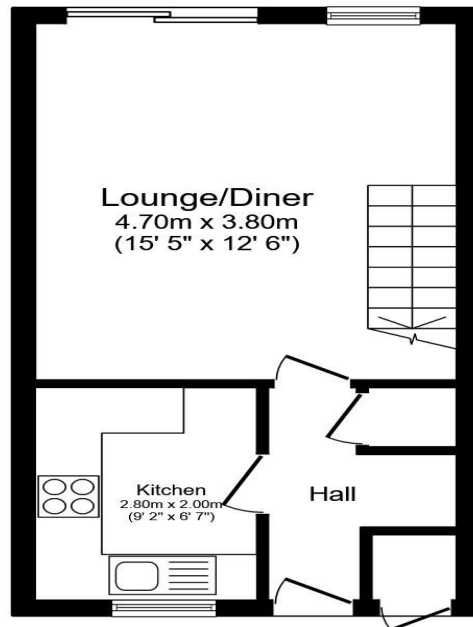

Ground Floor

Floor area 28.9 m² (311 sq.ft.) approx

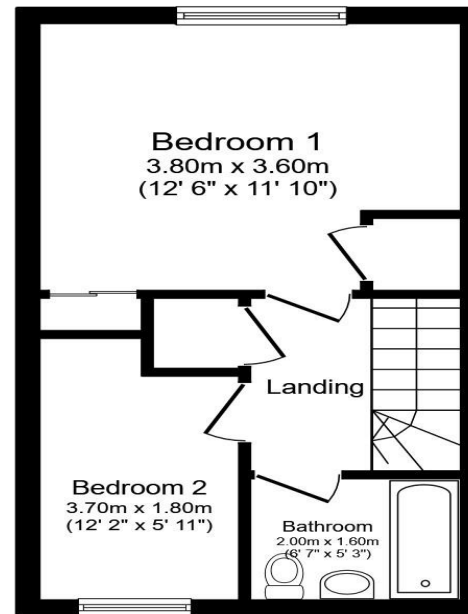

First Floor

Floor area 28.9 m² (311 sq.ft.) approx

Hallway

Kitchen

9' 2" x 6' 7" (2.79m x 2.01m)

Lounge/Diner

15' 5" x 12' 6" (4.70m x 3.81m)

Landing

Bedroom 1

12' 6" max x 11' 10" max (3.81m max x 3.61m max)

Bedroom 2

12' 2" x 5' 11" (3.71m x 1.80m)

Bathroom

6' 7" x 5' 3" (2.01m x 1.60m)

Contact Telephone...
Contact Address...

This plan is for illustration purposes only and
may not be representative of the property. Plan
not to scale.

Powered by Focal

welcome to

Stoney Grove, Chesham

- TWO BEDROOMS
- SPACIOUS LOUNGE/DINER
- KITCHEN TO FRONT OF PROPERTY
- FIRST FLOOR BATHROOM
- GREAT SCHOOL CATCHMENTS

Tenure: Freehold EPC Rating: D
Council Tax Band: C



guide price

£320,000



view this property online [brownandmerry.co.uk/Property/CSM103440](https://www.brownandmerry.co.uk/Property/CSM103440)



Property Ref:
CSM103440 - 0002

1. MONEY LAUNDERING REGULATIONS Intending purchasers will be asked to produce identification documentation at a later stage and we would ask for your co-operation in order that there is no delay in agreeing the sale. 2. These particulars do not constitute part or all of an offer or contract. 3. The measurements indicated are supplied for guidance only and as such must be considered incorrect. Potential buyers are advised to recheck measurements before committing to any expense. 4. We have not tested any apparatus, equipment, fixtures or services and it is in the buyers interest to check the working condition of any appliances. 5. Where an EPC, or a Home Report (Scotland only) is held for this property, it is available for inspection at the branch by appointment. If you require a printed version of a Home Report, you will need to pay a reasonable production charge reflecting printing and other costs. 6. We are not able to offer an opinion either written or verbal on the content of these reports and this must be obtained from your legal representative. 7. Whilst we take care in preparing these reports, a buyer should ensure that his/her legal representative confirms as soon as possible all matters relating to title including the extent and boundaries of the property and other important matters before exchange of contracts.

Brown & Merry is a trading name of Sequence (UK) Limited which is registered in England and Wales under company number 4268443, Registered Office is Cumbria House, 16-20 Hockliffe Street, Leighton Buzzard, Bedfordshire, LU7 1GN. VAT Registration Number is 500 2481 05.

brown & merry



01494 775650



chesham@brownandmerry.co.uk



3 Market Square, CHESHAM, Buckinghamshire,
HP5 1HG



[brownandmerry.co.uk](https://www.brownandmerry.co.uk)

Please note the marker reflects the
postcode not the actual property