



Eskdale Avenue, CHESHAM HP5 3BE

welcome to

Eskdale Avenue, CHESHAM

This is a unique chance to acquire a four-bedroom semi-detached family residence set on a spacious plot, located slightly more than half a mile from the Chesham station and shopping area, and in close reach of esteemed local schools.



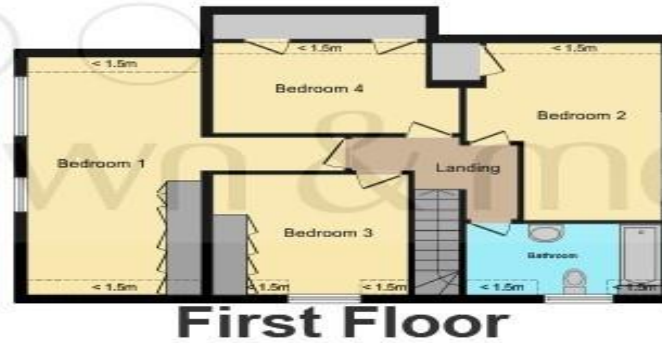

Total floor area 165.2 m² (1,778 sq.ft.) approx
 Reduced headroom 5.9 m² (63 sq.ft.)

This floor plan is for illustrative purposes only. It is not drawn to scale. Any measurements, floor areas (including any total floor area), openings and orientation are approximate. No details are guaranteed, they cannot be relied upon for any purpose and they do not form part of any agreement. No liability is taken for any error, omission or misstatement. A party must rely upon its own inspection(s). Powered by www.focalagent.com

Hallway

Kitchen/Breakfast Room
 24' 8" max x 14' 2" max (7.52m max x 4.32m max)

Dining Room
 20' 11" x 10' 2" (6.38m x 3.10m)

Lounge
 11' 2" x 10' 11" (3.40m x 3.33m)

Shower Room
 7' 11" x 7' 2" (2.41m x 2.18m)

Bedroom 1
 21' 2" x 10' (6.45m x 3.05m)

Bedroom 2
 14' 9" max x 10' 10" max (4.50m max x 3.30m max)

Bedroom 3
 10' 7" max x 10' 4" max (3.23m max x 3.15m max)

Bedroom 4
 14' 1" max x 7' 1" max (4.29m max x 2.16m max)

Bathroom

Landing

Garage
 16' 4" x 8' 4" (4.98m x 2.54m)

welcome to

Eskdale Avenue, CHESHAM

- SEMI-DETACHED PROPERTY
- LARGE KITCHEN/BREAKFAST ROOM
- SPACIOUS DINING ROOM & SEPARATE LOUNGE
- 1ST FLOOR BATHROOM AND GROUND FLOOR SHOWER ROOM
- THREE DOUBLE & ONE SINGLE BEDROOM

Tenure: Freehold EPC Rating: C

£790,000



Please note the marker reflects the postcode not the actual property

[view this property online](https://www.brownandmerry.co.uk/Property/CSM103245) brownandmerry.co.uk/Property/CSM103245



Property Ref:
CSM103245 - 0004

1. MONEY LAUNDERING REGULATIONS Intending purchasers will be asked to produce identification documentation at a later stage and we would ask for your co-operation in order that there is no delay in agreeing the sale. 2. These particulars do not constitute part or all of an offer or contract. 3. The measurements indicated are supplied for guidance only and as such must be considered incorrect. Potential buyers are advised to recheck measurements before committing to any expense. 4. We have not tested any apparatus, equipment, fixtures or services and it is in the buyers interest to check the working condition of any appliances. 5. Where an EPC, or a Home Report (Scotland only) is held for this property, it is available for inspection at the branch by appointment. If you require a printed version of a Home Report, you will need to pay a reasonable production charge reflecting printing and other costs. 6. We are not able to offer an opinion either written or verbal on the content of these reports and this must be obtained from your legal representative. 7. Whilst we take care in preparing these reports, a buyer should ensure that his/her legal representative confirms as soon as possible all matters relating to title including the extent and boundaries of the property and other important matters before exchange of contracts.

brown & merry



01494 775650



chesham@brownandmerry.co.uk



3 Market Square, CHESHAM, Buckinghamshire,
HP5 1HG



brownandmerry.co.uk