



Beechcroft Road, Chesham HP5 2AN



welcome to

Beechcroft Road, Chesham

An immaculate two double bedroom end of terrace family home with allocated parking, close to sought after schools as well as Chesham Town Centre with Metropolitan Underground station.



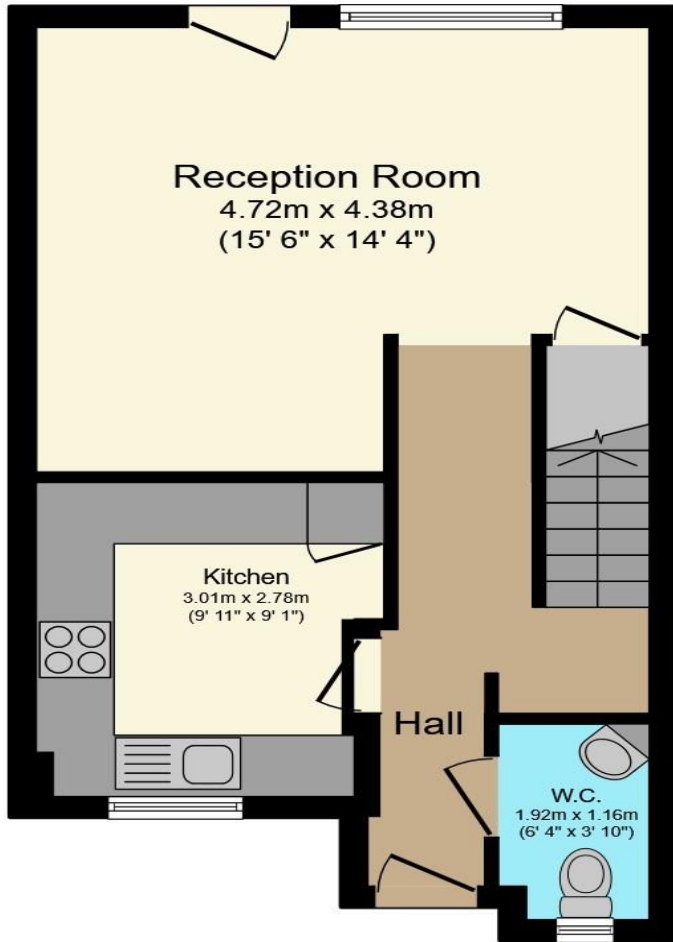

Ground Floor

Floor area 37.6 sq.m. (405 sq.ft.) approx

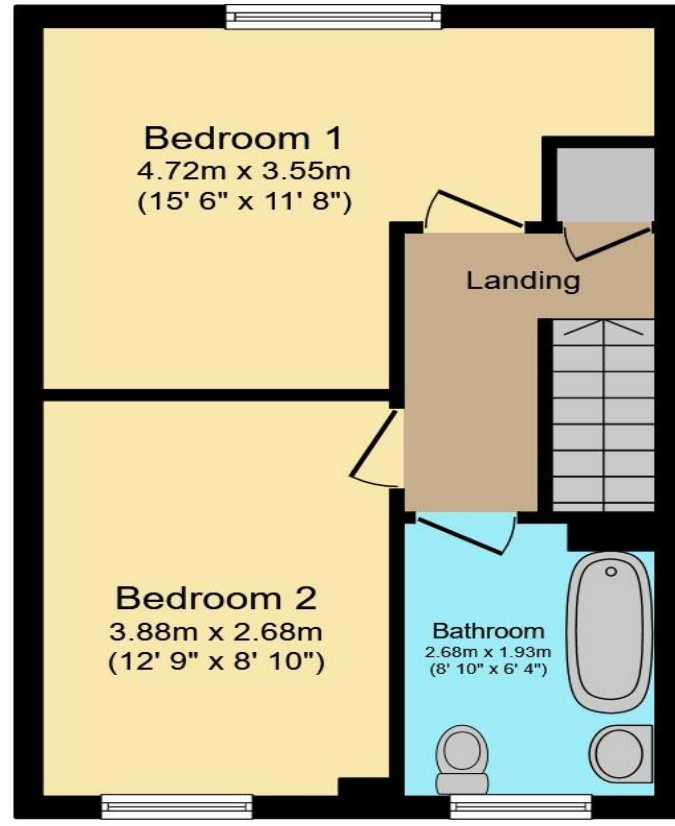

First Floor

Floor area 35.5 sq.m. (383 sq.ft.) approx

Total floor area 73.1 sq.m. (787 sq.ft.) approx

This plan is for illustration purposes only and may not be representative of the property. Plan not to scale.

Powered by Focal

Hallway

Kitchen

9' 11" x 9' 1" (3.02m x 2.77m)

Reception Room

Irregular Shaped Room 15' 6" max x 14' 4" max (4.72m max x 4.37m)

W C

6' 4" x 3' 10" (1.93m x 1.17m)

Bedroom 1

Irregular Shaped Room 15' 6" max x 11' 8" max (4.72m max x 3.56m)

Bedroom 2

12' 9" x 8' 10" (3.89m x 2.69m)

Bathroom

8' 10" max x 6' 4" max (2.69m max x 1.93m max)

welcome to

Beechcroft Road, Chesham

- TWO DOUBLE BEDROOMS
- FREEHOLD END OF TERRACE HOUSE - PERFECT STARTER HOME
- TWO ALLOCATED PARKING SPACES
- POTENTIAL TO EXTEND
- EXCELLENT CONDITION THROUGHOUT

Tenure: Freehold EPC Rating: C

offers in excess of

£425,000



Please note the marker reflects the postcode not the actual property

view this property online [brownandmerry.co.uk/Property/CSM103150](https://www.brownandmerry.co.uk/Property/CSM103150)



Property Ref:
CSM103150 - 0003

1. MONEY LAUNDERING REGULATIONS Intending purchasers will be asked to produce identification documentation at a later stage and we would ask for your co-operation in order that there is no delay in agreeing the sale. 2. These particulars do not constitute part or all of an offer or contract. 3. The measurements indicated are supplied for guidance only and as such must be considered incorrect. Potential buyers are advised to recheck measurements before committing to any expense. 4. We have not tested any apparatus, equipment, fixtures or services and it is in the buyers interest to check the working condition of any appliances. 5. Where an EPC, or a Home Report (Scotland only) is held for this property, it is available for inspection at the branch by appointment. If you require a printed version of a Home Report, you will need to pay a reasonable production charge reflecting printing and other costs. 6. We are not able to offer an opinion either written or verbal on the content of these reports and this must be obtained from your legal representative. 7. Whilst we take care in preparing these reports, a buyer should ensure that his/her legal representative confirms as soon as possible all matters relating to title including the extent and boundaries of the property and other important matters before exchange of contracts.

Brown & Merry is a trading name of Sequence (UK) Limited which is registered in England and Wales under company number 4268443, Registered Office is Cumbria House, 16-20 Hockliffe Street, Leighton Buzzard, Bedfordshire, LU7 1GN. VAT Registration Number is 500 2481 05.

brown & merry



01494 775650



chesham@brownandmerry.co.uk



3 Market Square, CHESHAM, Buckinghamshire,
HP5 1HG



[brownandmerry.co.uk](https://www.brownandmerry.co.uk)