



**Chartridge Lane, Chesham HP5 2SJ**

**welcome to**

**Chartridge Lane, Chesham**

Situated in the highly sought-after area of Chartridge Lane, this exceptional FOUR bedroom family home boasts an impressive garden both at the front and rear. The south facing rear garden is spacious as well as offering a high level of privacy and is bathed in beautiful sunlight throughout the day.





### Ground Floor

Floor area 63.5 m<sup>2</sup> (684 sq.ft.) approx

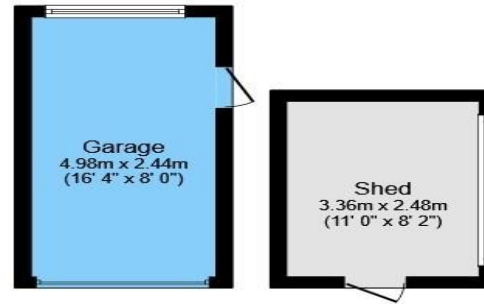

### Outbuilding

Floor area 20.1 m<sup>2</sup> (217 sq.ft.) approx

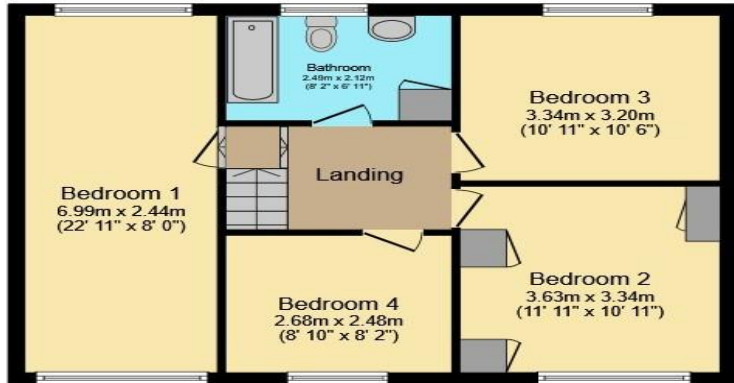

### First Floor

Floor area 61.1 m<sup>2</sup> (657 sq.ft.) approx

Total floor area 144.7 m<sup>2</sup> (1,558 sq.ft.) approx

This plan is for illustration purposes only and may not be representative of the property. Plan not to scale.

Powered by Focal

### Hallway

### Reception / Dining Room

25' 2" max x 12' 1" max ( 7.67m max x 3.68m max )

### Kitchen

10' 5" x 9' 1" ( 3.17m x 2.77m )

### Garage/Car Port

24' 1" x 8' 2" ( 7.34m x 2.49m )

### Bedroom 1

22' 11" x 8' ( 6.99m x 2.44m )

### Bedroom 2

11' 11" x 10' 11" ( 3.63m x 3.33m )

### Bedroom 3

10' 11" x 10' 6" ( 3.33m x 3.20m )

### Bedroom 4

8' 10" x 8' 2" ( 2.69m x 2.49m )

### Bathroom

8' 2" max x 6' 11" max ( 2.49m max x 2.11m max )

### Agents Note

### Location

welcome to

## Chartridge Lane, Chesham

- SEMI-DETACHED FAMILY HOME
- FOUR BEDROOM
- LARGE LOUNGE DINING ROOM
- FAMILY KITCHEN WITH VIEW OVER REAR GARDEN
- FIRST FLOOR FAMILY BATHROOM

Tenure: Freehold EPC Rating: D

**£650,000**



Please note the marker reflects the postcode not the actual property

**view this property online** [brownandmerry.co.uk/Property/CSM103084](https://www.brownandmerry.co.uk/Property/CSM103084)



Property Ref:  
CSM103084 - 0002

1. MONEY LAUNDERING REGULATIONS Intending purchasers will be asked to produce identification documentation at a later stage and we would ask for your co-operation in order that there is no delay in agreeing the sale. 2. These particulars do not constitute part or all of an offer or contract. 3. The measurements indicated are supplied for guidance only and as such must be considered incorrect. Potential buyers are advised to recheck measurements before committing to any expense. 4. We have not tested any apparatus, equipment, fixtures or services and it is in the buyers interest to check the working condition of any appliances. 5. Where an EPC, or a Home Report (Scotland only) is held for this property, it is available for inspection at the branch by appointment. If you require a printed version of a Home Report, you will need to pay a reasonable production charge reflecting printing and other costs. 6. We are not able to offer an opinion either written or verbal on the content of these reports and this must be obtained from your legal representative. 7. Whilst we take care in preparing these reports, a buyer should ensure that his/her legal representative confirms as soon as possible all matters relating to title including the extent and boundaries of the property and other important matters before exchange of contracts.

Brown & Merry is a trading name of Sequence (UK) Limited which is registered in England and Wales under company number 4268443, Registered Office is Cumbria House, 16-20 Hockliffe Street, Leighton Buzzard, Bedfordshire, LU7 1GN. VAT Registration Number is 500 2481 05.

  
brown & merry



**01494 775650**



[chesham@brownandmerry.co.uk](mailto:chesham@brownandmerry.co.uk)



3 Market Square, CHESHAM, Buckinghamshire,  
HP5 1HG



**[brownandmerry.co.uk](https://www.brownandmerry.co.uk)**