



**Sunrise Kings Lane, South Heath Great Missenden HP16 0QY**



**welcome to**

**Sunrise Kings Lane, South Heath Great Missenden**

A perfect combination of character and modern contemporary living all in one, Kings Lane offers the best of both worlds. Boasting FOUR spacious bedrooms this DETACHED house is perfect to be made into a family home.





### Ground Floor

Floor area 91.1 sq.m. (980 sq.ft.) approx

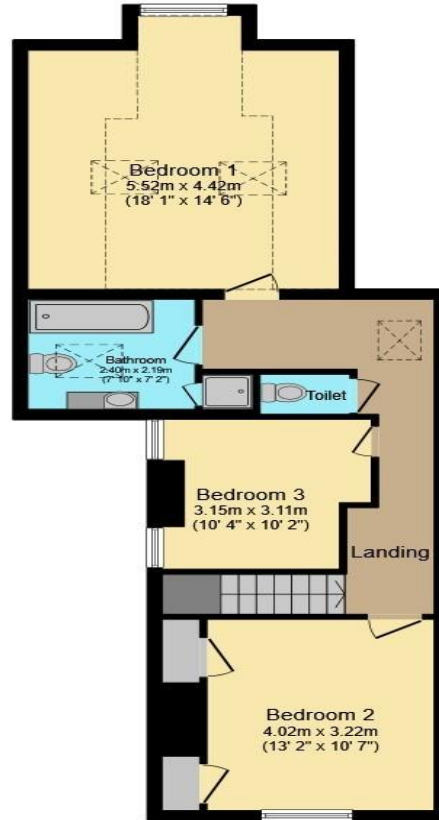

### First Floor

Floor area 67.3 sq.m. (725 sq.ft.) approx

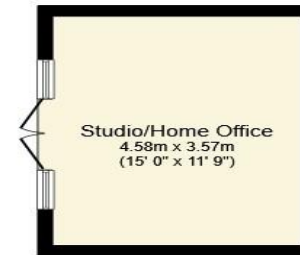

### Outbuilding

Floor area 16.4 sq.m. (176 sq.ft.) approx

Total floor area 174.7 sq.m. (1,881 sq.ft.) approx

This plan is for illustration purposes only and may not be representative of the property. Plan not to scale.

Powered by Focal

## Location

### Entrance Hallway

### Sitting Room

12' 6" max x 9' 9" max ( 3.81m max x 2.97m max )

### Kitchen/dining Room

22' 1" x 13' ( 6.73m x 3.96m )

### Family Room

19' 1" x 12' 8" ( 5.82m x 3.86m )

### Utility Room

8' 9" x 6' 8" ( 2.67m x 2.03m )

### Shower Room

5' 3" x 5' ( 1.60m x 1.52m )

### Study/bedroom 4

10' 8" x 8' 9" ( 3.25m x 2.67m )

### Landing

### Bedroom 1

18' 1" max - restricted headroom x 14' 6" restricted headroom ( 5.51m max - restricted headroom x 4.42m restricted headroom )

### Bedroom 2

13' 2" x 10' 7" ( 4.01m x 3.23m )

### Bedroom 3

10' 4" max x 10' 2" max ( 3.15m max x 3.10m max )

### Family Bathroom

welcome to

## Sunrise Kings Lane, South Heath Great Missenden

- THREE/FOUR BEDROOM DETACHED PERIOD PROPERTY
- LARGE KITCHEN DINER
- SITTING ROOM, FAMILY ROOM & STUDY/BEDROOM 4
- UTILITY & GROUND FLOOR SHOWER ROOM
- FAMILY BATHROOM & SEPARATE WC

Tenure: Freehold EPC Rating: E

# £725,000



Please note the marker reflects the postcode not the actual property

[view this property online brownandmerry.co.uk/Property/CSM103015](https://www.brownandmerry.co.uk/Property/CSM103015)



Property Ref:  
CSM103015 - 0006

1. MONEY LAUNDERING REGULATIONS Intending purchasers will be asked to produce identification documentation at a later stage and we would ask for your co-operation in order that there is no delay in agreeing the sale. 2. These particulars do not constitute part or all of an offer or contract. 3. The measurements indicated are supplied for guidance only and as such must be considered incorrect. Potential buyers are advised to recheck measurements before committing to any expense. 4. We have not tested any apparatus, equipment, fixtures or services and it is in the buyers interest to check the working condition of any appliances. 5. Where an EPC, or a Home Report (Scotland only) is held for this property, it is available for inspection at the branch by appointment. If you require a printed version of a Home Report, you will need to pay a reasonable production charge reflecting printing and other costs. 6. We are not able to offer an opinion either written or verbal on the content of these reports and this must be obtained from your legal representative. 7. Whilst we take care in preparing these reports, a buyer should ensure that his/her legal representative confirms as soon as possible all matters relating to title including the extent and boundaries of the property and other important matters before exchange of contracts.

Brown & Merry is a trading name of Sequence (UK) Limited which is registered in England and Wales under company number 4268443, Registered Office is Cumbria House, 16-20 Hockliffe Street, Leighton Buzzard, Bedfordshire, LU7 1GN. VAT Registration Number is 500 2481 05.

  
brown & merry



**01494 775650**



[chesham@brownandmerry.co.uk](mailto:chesham@brownandmerry.co.uk)



3 Market Square, CHESHAM, Buckinghamshire,  
HP5 1HG



**[brownandmerry.co.uk](https://www.brownandmerry.co.uk)**