



Birch Way, Chesham HP5 3JL

welcome to

Birch Way, Chesham

Take advantage of this opportunity to make Birch Way your next family home. This THREE bedroom home offers ample room throughout and is situated within easy access to Chesham High Street & Chesham Underground station.



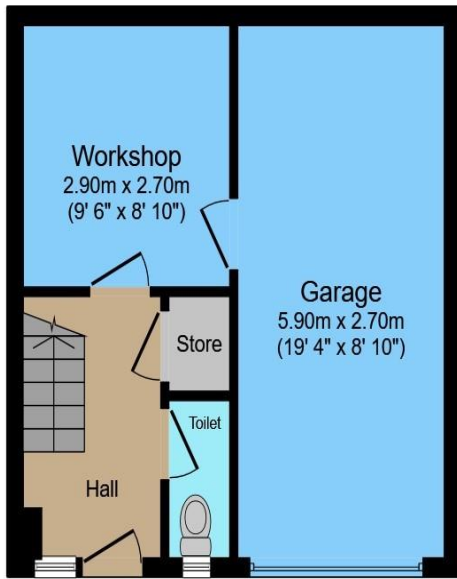

Ground Floor

Floor area 32.5 sq.m. (349 sq.ft.) approx

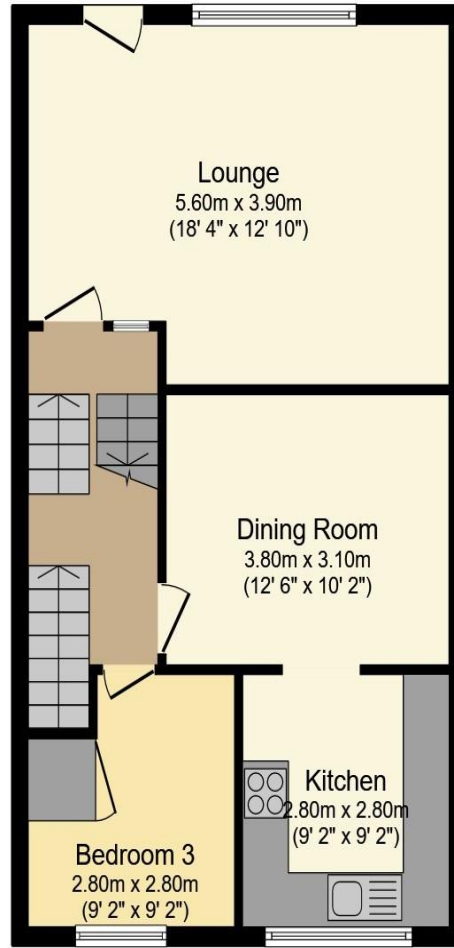

First Floor

Floor area 55.0 sq.m. (592 sq.ft.) approx

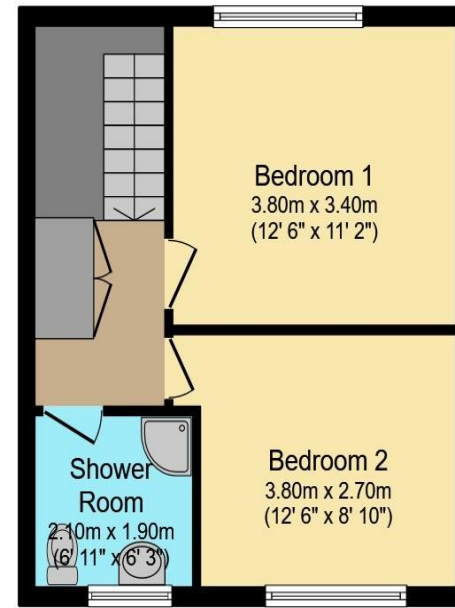

Second Floor

Floor area 34.2 sq.m. (368 sq.ft.) approx

Garage
19' 4" x 8' 10" (5.89m x 2.69m)

Workshop
9' 6" x 8' 10" (2.90m x 2.69m)

Lounge
18' 4" x 12' 10" (5.59m x 3.91m)

Dining Room
12' 6" x 10' 2" (3.81m x 3.10m)

Kitchen
9' 2" x 9' 2" (2.79m x 2.79m)

Bedroom 1
12' 6" x 11' 2" (3.81m x 3.40m)

Bedroom 2
12' 8" x 8' 10" (3.86m x 2.69m)

Bedroom 3
Irregular Shaped Room 9' 2" x 9' (2.79m x 2.74m)

Total floor area 121.6 sq.m. (1,309 sq.ft.) approx

This plan is for illustration purposes only and may not be representative of the property. Plan not to scale.

welcome to

Birch Way, Chesham

- FAMILY HOME
- ONE SINGLE & TWO DOUBLE BEDROOMS
- SPACIOUS LOUNGE
- LARGE KITCHEN & DINING AREAS
- GARDENS TO FRONT & REAR

Tenure: Freehold EPC Rating: D

£425,000



view this property online [brownandmerry.co.uk/Property/CSM102518](https://www.brownandmerry.co.uk/Property/CSM102518)

Please note the marker reflects the postcode not the actual property



Property Ref:
CSM102518 - 0005

1. MONEY LAUNDERING REGULATIONS Intending purchasers will be asked to produce identification documentation at a later stage and we would ask for your co-operation in order that there is no delay in agreeing the sale. 2. These particulars do not constitute part or all of an offer or contract. 3. The measurements indicated are supplied for guidance only and as such must be considered incorrect. Potential buyers are advised to recheck measurements before committing to any expense. 4. We have not tested any apparatus, equipment, fixtures or services and it is in the buyers interest to check the working condition of any appliances. 5. Where an EPC, or a Home Report (Scotland only) is held for this property, it is available for inspection at the branch by appointment. If you require a printed version of a Home Report, you will need to pay a reasonable production charge reflecting printing and other costs. 6. We are not able to offer an opinion either written or verbal on the content of these reports and this must be obtained from your legal representative. 7. Whilst we take care in preparing these reports, a buyer should ensure that his/her legal representative confirms as soon as possible all matters relating to title including the extent and boundaries of the property and other important matters before exchange of contracts.

brown & merry



01494 775650



chesham@brownandmerry.co.uk



3 Market Square, CHESHAM, Buckinghamshire,
HP5 1HG



[brownandmerry.co.uk](https://www.brownandmerry.co.uk)