

Plumpton Road, Brighton, BN2 9YL

Approximate Gross Internal Area = 73.0 sq m / 786 sq ft

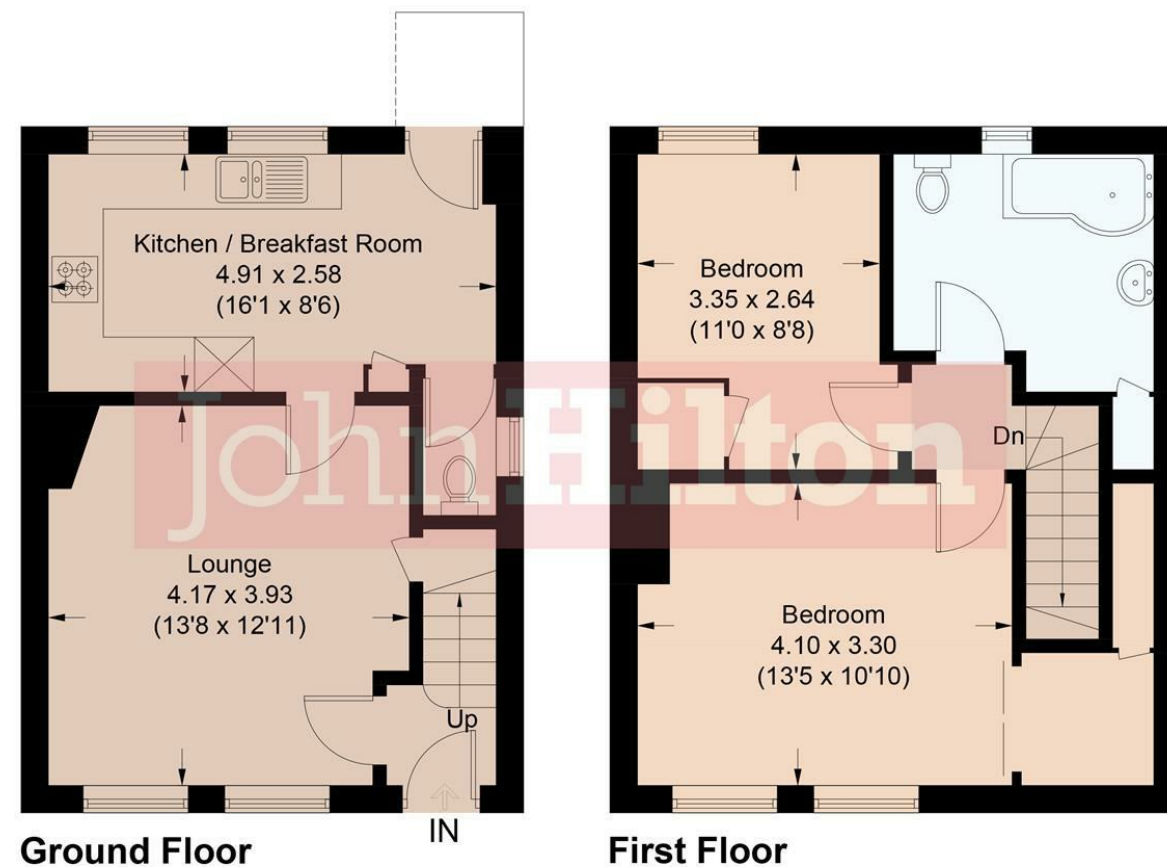

Illustration for identification purposes only, measurements are approximate, not to scale.
Imageplansurveys @ 2025



JohnHilton

Total Area Approx 786.00 sq ft

3 Plumpton Road, Brighton, BN2 9YL

To view, contact John Hilton:
52 High Street, Rottingdean, BN2 7HF
132-135 Lewes Road, Brighton, BN2 3LG
01273 608151 or sales@johnhiltons.co.uk

Offers In The Region Of £400,000
Freehold



JohnHilton



JohnHilton

3 Plumpton Road Brighton, BN2 9YL

Favourably positioned to the lower end of Plumpton Road, which connects to Downs Terrace, this well-presented two double bedroom older-style family home is within easy walking distance of a local convenience store, St Luke's and Elm Grove Primary schools, St Luke's swimming pool, a regular bus service and Brighton's wonderful Queen's Park. The property is considered to be in good decorative order throughout and has benefitted from a lovely refitted kitchen/breakfast room and family bathroom which has been relocated to the first floor. The front garden has been laid to block paving to now offer a handy hardstanding for two vehicles, and a low-maintenance West-facing rear garden is arranged with decked terrace with inset lighting, shed and a useful large timber-built outbuilding.

Approach

Front garden laid to block paving offering hardstanding for two vehicles. Double glazed front door opening into:

Entrance Lobby

Stairs ascend to first floor landing, radiator and panelled door through to:

Lounge

4.17m x 3.93m (13'8" x 12'10")
Twin double-glazed windows to front with fitted wide-slat Venetian blinds, coved ceiling with directional spotlights, chimney breast recess, wide-plank wood-effect laminate flooring and door into:

Kitchen/Breakfast Room

4.91m x 2.58m (16'1" x 8'5")
Twin double-glazed windows overlooking rear garden with fitted roller blinds, and double-glazed door onto rear garden. Modern refitted kitchen comprising a range of matching wall and base units to include integrated fridge-freezer and soft-closing drawers. Work surfaces extend to include a four-ring gas hob with oven under, alongside a one-and-a-half bowl stainless steel sink with drainer and mixer tap, part-tiled splashback, and space and plumbing for washing machine and tumble dryer. Laminate flooring, coved ceiling with inset downlights, wall-mounted ladder radiator and shallow cupboard with electric consumer unit. Door into:

Cloakroom

Obscure double-glazed window to side, WC and electric heater.

First Floor Landing

Hatch offering access to insulated and boarded loft space with light and pull-down ladder.

Bedroom

4.10m x 3.30m (13'5" x 10'9")
Twin double-glazed windows to front with fitted wide-slat Venetian blinds and radiator under. Built-in double wardrobe with mirrored fronts.

Bedroom

3.35m x 2.64m (10'11" x 8'7")
Double-glazed window to rear offering elevated far-reaching Westerly views towards Shoreham, with fitted Venetian blind and radiator under. Built-in cupboard housing combination boiler with slatted shelving.

Bathroom

Obscure double-glazed window to rear. Three-piece white bathroom suite to include panel-enclosed P-shaped bath with thermostat shower over, WC and pedestal wash hand basin. Ceramic tiled floor and surround, heated towel rail, coved ceiling with inset downlights and built-in cupboard with slatted shelving.

Rear Garden

West-facing, predominantly laid to paving, timber fence-enclosed to all sides, raised decked terrace to rear with inset lighting, timber shed, further large timber outbuilding and outside water tap.



JohnHilton



JohnHilton

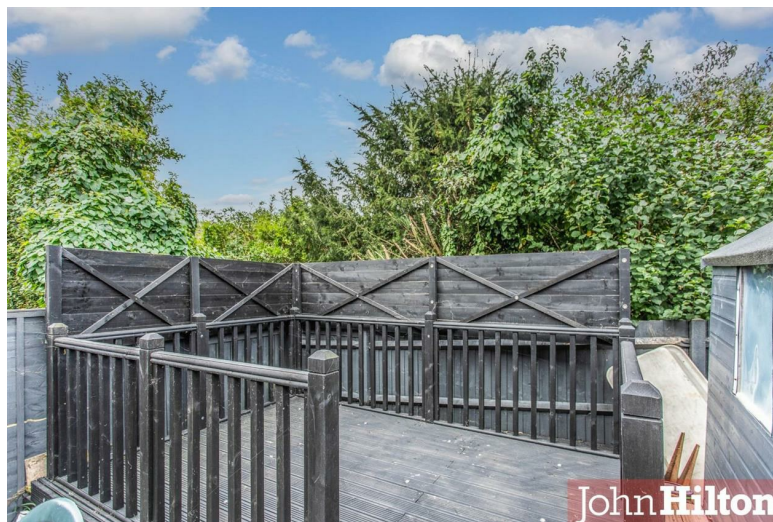

JohnHilton



JohnHilton



JohnHilton

Energy Efficiency Rating		
	Current	Potential
Very energy efficient - lower running costs		
(92 plus) A		
(81-91) B		
(69-80) C		
(55-68) D		
(39-54) E		
(21-38) F		
(1-20) G		
Not energy efficient - higher running costs		
England & Wales	EU Directive 2002/91/EC	

Council Tax Band: **B**

- West-Facing Rear Garden
- Elevated Views to Rear
- Two Double Bedrooms
- Close to Queen's Park Road
- First Floor Refitted Bathroom
- Hardstanding for Two Vehicles
- Refitted Kitchen/Breakfast Room
- Ground Floor Cloakroom
- Large Timber-Built Outbuilding
- Close to St Luke's & Elm Grove Schools