

**Deanhill Court Upper
Richmond Road West
London
SW14 7DL**

£1,895 PCM

ChaseBuchanan



FIRST FLOOR
901 sq.ft. (83.7 sq.m.) approx.

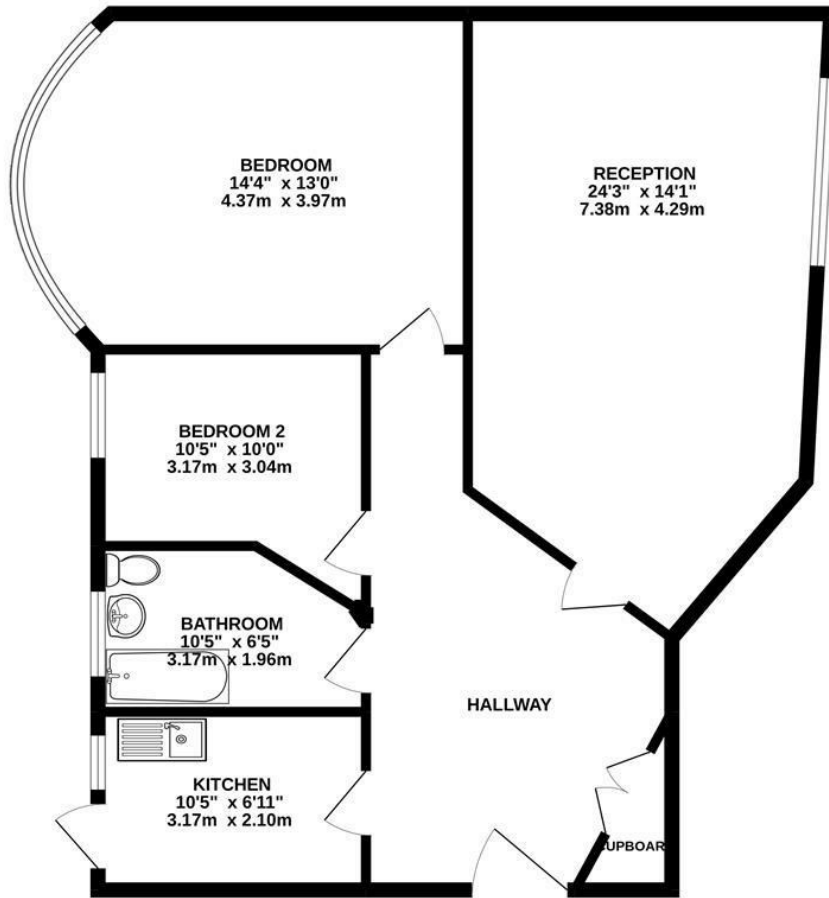

TOTAL FLOOR AREA : 901 sq.ft. (83.7 sq.m.) approx.
Produced solely for Chase Buchanan
Made with Metropix ©2022

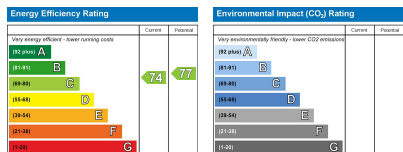

- Viewings accompanied by Chase Buchanan
- Recently refurbished
- First floor flat
- Available immediately
- Close to Sheen Mount Primary School
- Spacious lounge
- Council tax band D
- EPC C

Located within the sought after Deanhill Court development is this newly refurbished two bedroom first floor flat. The property boasts two double bedrooms with fitted wardrobes, a spacious lounge, galley kitchen with a range of base and eye level units and new integrated appliances and three-piece bathroom

The local amenities of East Sheen and Richmond are close by, providing a number of supermarkets, cafes and restaurants. Sheen Mount School is very close by as are Richmond Park, Sheen Common and the River Thames.

Chase Buchanan are bonded members of ARLA Propertymark.

For more information or to book a viewing, please contact:

020 8948 1331

ChaseBuchanan

20 Red Lion Street, Richmond, TW9 1RW

Care has been taken in the preparation of these particulars, however, their accuracy is not guaranteed and they do not form part of any contract. Measurements stated must be considered maximum.