

**Matthias Court Church
Road
Richmond
TW10 6LL**

£750,000

ChaseBuchanan



Matthias Court

Approx. Gross Internal Floor Area
73.1 Sq M - 787 Sq Ft

ChaseBuchanan

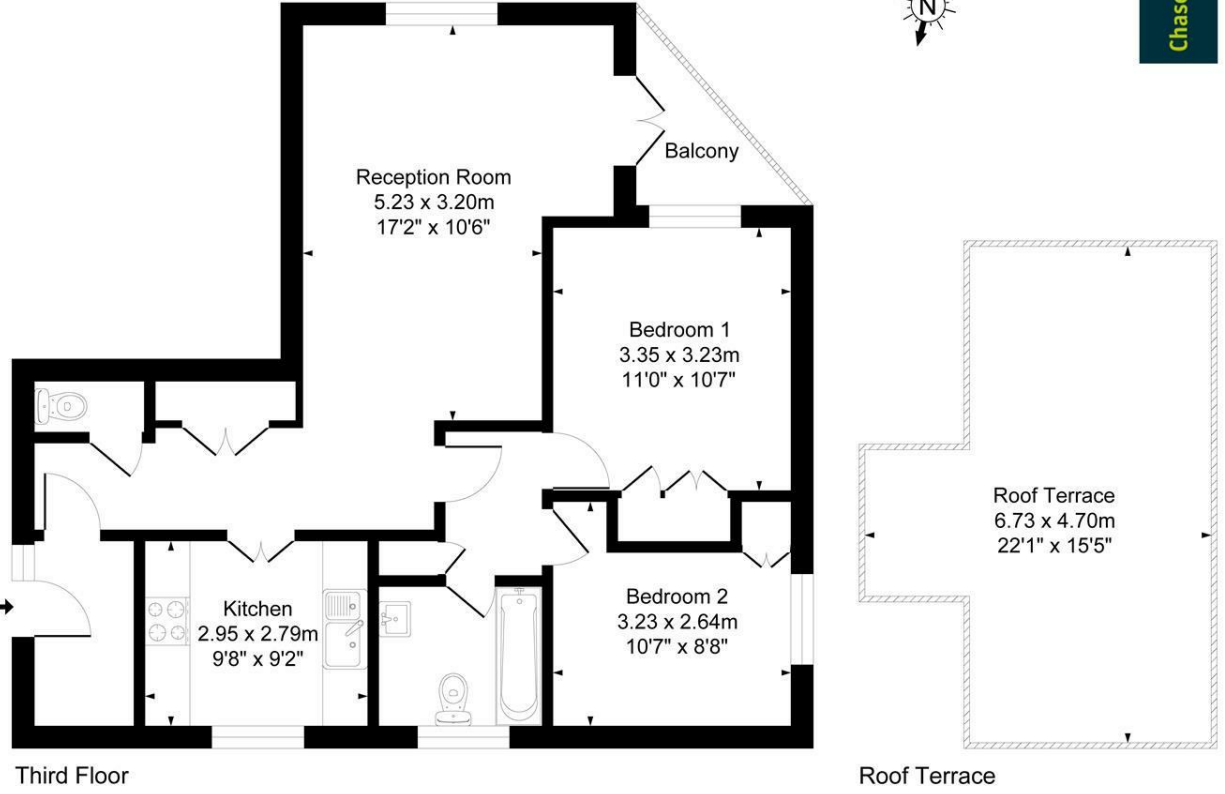

Illustration for identification purposes only, measurements are approximate, not to scale.
Produced By Esjay Property Marketing

Energy Efficiency Rating		Current	Desired
Very energy efficient - lower running costs			
92-100	A		
81-91	B		
69-80	C		
55-68	D		
49-54	E		
45-48	F		
1-44	G		
		61	74

Environmental Impact (CO ₂) Rating		Current	Desired
Very environmentally friendly - lower CO ₂ emissions			
10-48	A		
49-74	B		
75-100	C		
101-120	D		
121-140	E		
141-160	F		
161-180	G		

Care has been taken in the preparation of these particulars, however, their accuracy is not guaranteed and they do not form part of any contract. Measurements stated must be considered maximum.

- Viewings accompanied by Chase Buchanan
- Modern bathroom and separate W/C
- Private roof terrace
- Vineyard School area
- Lift serviced apartment
- Top floor apartment - 2 beds
- Allocated covered parking space
- Share of freehold
- Richmond village location
- 0.4 Miles to Richmond station

This ideally located and decent size two-bedroom top floor apartment is lift serviced and would make the perfect home for a couple or young family who want the sought-after Richmond village lifestyle.

Featuring a bright and spacious reception room with double doors leading out onto a private west facing balcony, there are glorious views from all windows. The property has a well appointed eat-in kitchen, modern family bathroom, a separate W/C and two double bedrooms with built-in wardrobes.

A real bonus is the additional private roof terrace and the allocated covered parking space - this apartment really does have a lot to offer especially when you factor in the share of freehold and 900+ year underlying lease.

Matthias Court is situated on one end of Richmond village parade on top of the hill opposite the church, surrounded by cafes, boutiques, and handy shops of all descriptions along with the famous Turner view and two very nice family friendly pubs - not to mention the Vineyard School, which is seen to be one of the very best primary schools locally.

For more information or to book a viewing, please contact:

020 8948 1331

ChaseBuchanan

20 Red Lion Street, Richmond, TW9 1RW